

STATE OF INDIANA
LAKE COUNTY
FILED FOR RECORD

2005 044498

2005 JUN - 1 AM 10:07

MICHAEL A. STIGLICH
After recording return to: Lake County Trust Company
2200 N. Main Street
Crown Point, IN. 46307

Deed Into Trust

CM 620046733

This Indenture Witnesseth that, the Grantor/s

MICHAEL SUROWIEC AND CATHY SUROWIEC, tenants in common

of the County of Lake and State of Indiana for and in consideration of Ten (\$10.00) Dollars and other good and valuable consideration in hand paid,

CONVEY AND WARRANT

unto LAKE COUNTY TRUST COMPANY, AS TRUSTEE under the provisions of a Trust Agreement dated January 19, 2005, and known as **Trust No. 5618**, in Lake County, and State of Indiana,

for the sum of ten dollars (\$10.00) and other good and valuable consideration the following described Real Estate in the **County of Lake** and State of Indiana, to wit:

Lot 12, Brandywine Estates Unit One, in Lake County, Indiana
PLAT BOOK 85, PAGE 66.

Commonly known as: **13135 Hayes Ct, Crown Point, IN 46307**

After recording, mail tax statements to: **Dale Seery 2721 W 85th Av.
Merrillville, Ind 46410**

TO HAVE AND TO HOLD the said premises with the appurtenances upon the trusts and for the uses and purposes herein and in said trust agreement set forth.

Full power and authority is hereby granted to said trustee to improve, manage, protect and subdivide said premises or any part thereof, to dedicate parks, streets, highways or alleys and to vacate any subdivision or part thereof, and to resubdivide said property as often as desired, to contract to sell, to grant options to purchase, to sell on any terms, to convey either with or without consideration, to convey said premises or any part thereof to a successor or successors in trust and to grant to such successor or successors in trust all of the title, estate, powers, and authorities vested in said trustee, to donate, to dedicate, to mortgage, pledge or otherwise encumber said property, or any part thereof, to lease said property, or any part thereof, from time to time, in possession or reversion, by leases to commence in praesenti or in futuro, and upon any terms and for any period or periods of time, not exceeding in the case of any single demise the term of 198 years, and to renew or extend leases upon any terms and for any period or periods of time and to amend, change or modify leases and the terms and provisions thereof at any time or times hereafter, to contract to make leases and to grant options to lease and options to renew leases and options to purchase the whole or any part of the reversion and to contract respecting the manner of fixing the amount of present or future rentals, to partition or to exchange said property, or any part thereof, for other real or personal property, to grant easements or charges of any kind, to release, convey or assign any right, title or interest in or about or easement appurtenant to said premises or any part thereof, and to deal with said property and every part thereof in all other ways and for such other considerations as it would be lawful for any person owning the same to deal with the same, whether similar to or different from the ways above specified, at any time or times hereafter.

This conveyance is made upon the express understanding and condition that neither Lake County Trust Company individually or as Trustee, nor its successor or successors in trust shall incur any personal liability or be subjected to any claim, judgment or decree for anything it or they or its or their agents or attorneys may do or omit to do in or about the said

DULY ENTERED FOR TAXATION SUBJECT TO
FINAL ACCEPTANCE FOR TRANSFER

JUN - 1 2005

STEPHEN R. STIGLICH
LAKE COUNTY AUDITOR

00059

16-
LP
CT

CHICAGO TITLE INSURANCE COMPANY

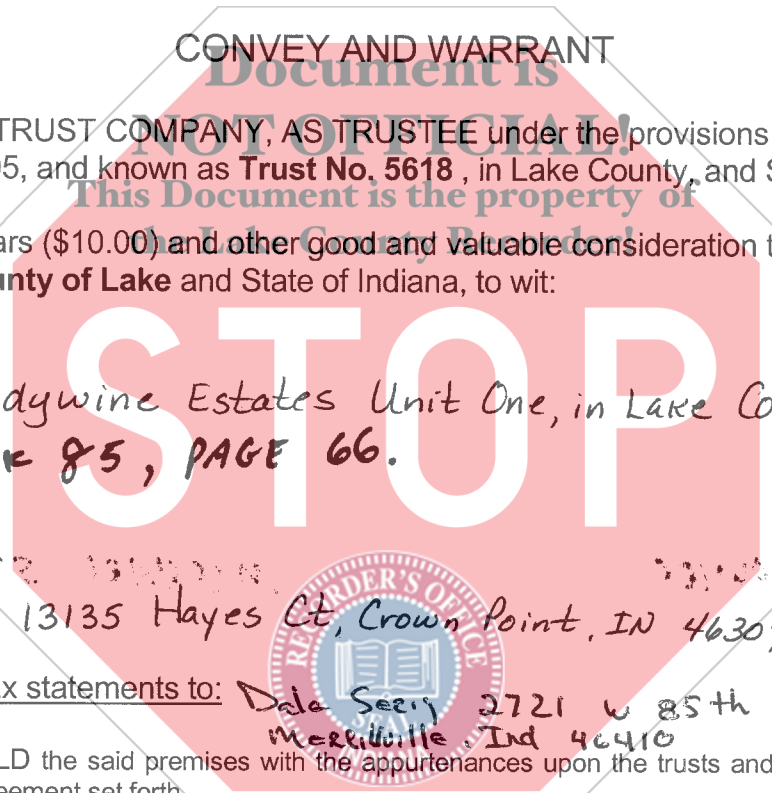

7

7-361-12

7

