

2

STATE OF INDIANA
LAKE COUNTY
FILED FOR RECORD

2005 022903

2005 MAR 24 AM 10:19

MICHAEL A. ...
RECORDER

Mail tax bills to:
3808 West 127th Place
Crown Point, IN 46307

Key No. 07-0015-0102

WARRANTY DEED

THIS INDENTURE WITNESSETH, That **HEATHER A. SCOTT and ANDREW G. SCOTT, wife and husband** ("Grantor")

of Lake County in the State of Indiana

CONVEY (S) AND WARRANT (S) TO **DIANE S. DUST** ("Grantee")

of Lake County in the State of Indiana

in consideration of One Dollar and other valuable consideration, the receipt and sufficiency of which are hereby acknowledged, the following described real estate in Lake County, in the State of Indiana:

SEE ATTACHED LEGAL DESCRIPTION:

Subject to: Taxes for 2004 and subsequent years, building lines, covenants and restrictions.

Dated this 9th day of March, 2005.

Heather A. Scott

Heather A. Scott

Andrew G. Scott

Andrew G. Scott

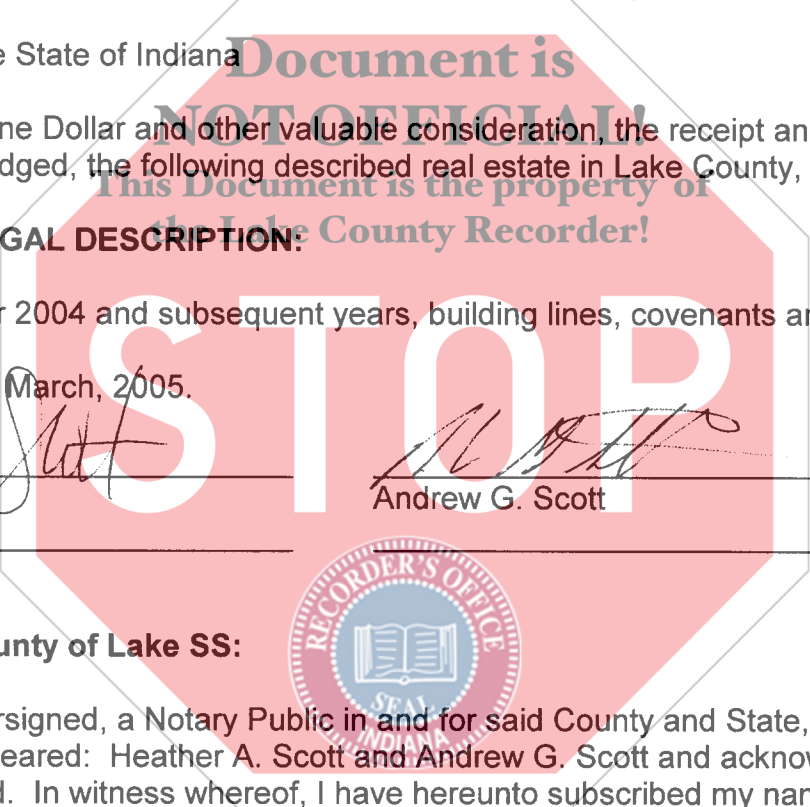

State of Indiana County of Lake SS:

Before me, the undersigned, a Notary Public in and for said County and State, this 9th day of March, 2005, personally appeared: Heather A. Scott and Andrew G. Scott and acknowledged the execution of the foregoing deed. In witness whereof, I have hereunto subscribed my name and affixed my official seal.

My commission expires: 11/19/2010

Resident of Lake County

Colette G. Wilson

Colette G. Wilson, Notary Public

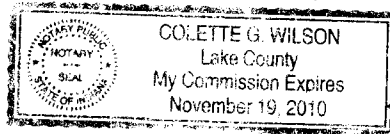

This instrument prepared by: Attorney Richard A. Zunica
162 Washington
Lowell, In 46356

File No. 05-13683

DULY ENTERED FOR TAXATION SUBJECT TO
FINAL ACCEPTANCE FOR TRANSFER

MAR 24 2005

STEPHEN R. STIGLICH
LAKE COUNTY AUDITOR

001833

16-D-10

11490

TRACK 63 OF PLAT OF SURVEY OF THAT PART OF THE SOUTHWEST QUARTER OF THE NORTHEAST QUARTER OF SECTION 19, TOWNSHIP 34 NORTH, RANGE 8 WEST OF THE 2ND PRINCIPAL MERIDIAN, LYING WEST OF THE CENTER LINE OF THE CROWN POINT-LOWELL ROAD, MORE PARTICULARLY DESCRIBED AS FOLLOWS: COMMENCING AT A POINT ON THE NORTH LINE OF SAID SOUTHWEST QUARTER OF THE NORTHEAST QUARTER OF SECTION 19, AND 583.08 FEET EAST OF THE NORTHWEST CORNER THEREOF; THENCE SOUTH WITH AN ANGLE OF 90 DEGREES WITH AFORESAID DESCRIBED LINE A DISTANCE OF 159.4 FEET; THENCE EASTERLY ON A CURVE TO THE RIGHT WITH A RADIUS OF 310.83 FEET A DISTANCE OF 55.61 FEET; THENCE NORTHERLY AT RIGHT ANGLES TO THE TANGENT OF SAID CURVE A DISTANCE OF 25 FEET; THENCE NORTHEASTERLY A DISTANCE OF 160.50 FEET TO A POINT ON THE NORTH LINE OF SAID SOUTHWEST QUARTER OF THE NORTHEAST QUARTER OF SECTION 19, SAID POINT BEING 100 FEET EAST OF THE POINT OF BEGINNING; THENCE WEST ON THE NORTH LINE OF SAID SOUTHWEST QUARTER OF THE NORTHEAST QUARTER OF SECTION 19, A DISTANCE OF 100 FEET TO THE POINT OF BEGINNING IN LAKE COUNTY, INDIANA.

