

STATE OF INDIANA  
LAKE COUNTY  
FILED FOR RECORD

2005 007080

2005 JAN 31 AM 9:11

Parcel No. (15) 26-8-53

MICHAEL A. BROWN  
RECORDER

**WARRANTY DEED**

ORDER NO. 920050289

THIS INDENTURE WITNESSETH, That Griffith Evangelical Lutheran Church, Inc.

of Lake County, in the State of INDIANA CONVEY(S) AND WARRANT(S)  
to West Haven Development, LLC

of Lake County, in the State of INDIANA, for the sum of  
TEN AND 00/100 Dollars (\$ 10.00)

and other valuable consideration, the receipt and sufficiency of which is hereby acknowledged, the following described real estate in Lake County, State of Indiana:

The West 160.0 feet of the East 1/2 of the South 1/2 of the North 1/2 of the Southwest 1/4 of the Southwest 1/4 of Section 26, Township 36 North, Range 9 West of the 2nd Principal Meridian, in Lake County, Indiana

SUBJECT TO REAL ESTATE TAXES FOR 2004 PAYABLE IN 2005 TOGETHER WITH DELINQUENCY AND PENALTY, IF ANY, AND ALL REAL ESTATE TAXES DUE AND PAYABLE THEREAFTER.

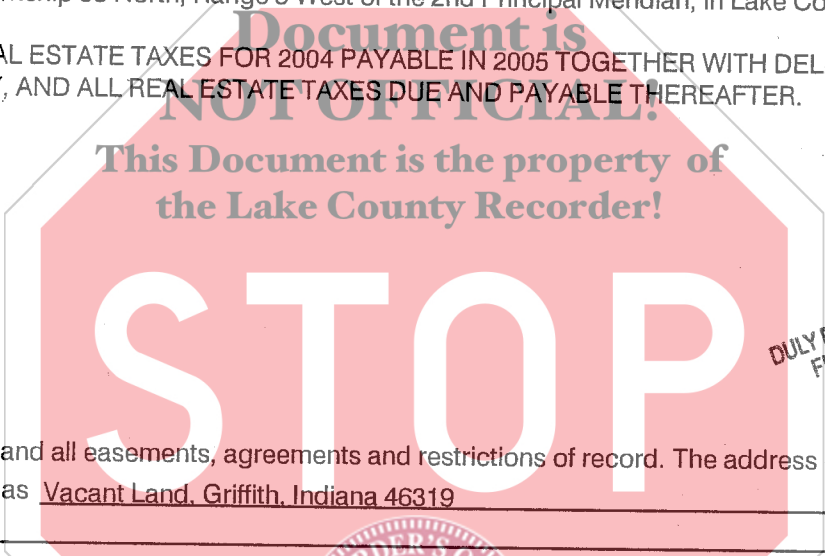

DULY ENTERED FOR TAXATION SUBJECT TO  
FINAL ACCEPTANCE FOR TRANSFER

JAN 28 2005

STEPHEN R. STIGLICH  
LAKE COUNTY AUDITOR

Subject to any and all easements, agreements and restrictions of record. The address of such real estate commonly known as Vacant Land, Griffith, Indiana 46319

Tax bills should be sent to Grantee at such address unless otherwise indicated below.

IN WITNESS WHEREOF, Grantor has executed this deed this 26th day of January, 2005.

Grantor: Eugene Kregel (SEAL) Grantor: \_\_\_\_\_ (SEAL)  
Signature \_\_\_\_\_ Signature \_\_\_\_\_

Printed Griffith Evangelical Lutheran Church, Inc. Printed \_\_\_\_\_  
By: Eugene Kregel, Chairman of the Board

STATE OF INDIANA of Trustees } SS: ACKNOWLEDGEMENT

COUNTY OF Lake

Before me, a Notary Public in and for said County and State, personally appeared Griffith Evangelical Lutheran Church, Inc. by: Eugene Kregel, Chairman of the Board of Trustees who acknowledge the execution of the foregoing Warranty Deed, and who, having been duly sworn, stated that any representations therein contained are true.

Witness my hand and Notarial Seal this 16th day of February, 2005.  
26th January

My commission expires: JUNE 7, 2008  
Signature [Signature]

Printed THOMAS G. SCHILLER, Notary Name

Resident of LAKE County, Indiana.

This instrument prepared by Thomas K. Hoffman Attorney at Law #7731-45

Return deed to 2300 RAMBLEWOOD DRIVE, #A, HIGHLAND, IN 46322

Send tax bills to 2300 RAMBLEWOOD DRIVE #A, HIGHLAND, IN 46322

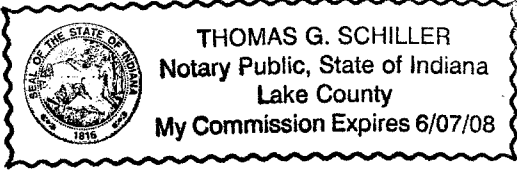

14 DG 11

001418

TICOR TITLE INSURANCE  
2050-45TH AVE.  
HIGHLAND, IN 46322