

2005 005474

2005 JAN 25 AM 11:19

MICHAEL A. BROWN  
RECORDER

**WARRANTY DEED**

Case No: 044503030  
Parcel No: 8-15-395-62

*Lake Co.*

*This Indenture Witnesseth,* That Gregory P. Weldon Shelley L. Weldon

(Grantor) of Lake County, in the State of Indiana, *Conveys and Warrants* to Sara Hernandez

(Grantee) of Lake County, in the State of Indiana, for the sum of Ten & 00/100 Dollars (\$10.00) and other valuable consideration, the receipt and sufficiency of which is hereby acknowledged, the following described real estate in Lake County, in the State of Indiana:

Lot 62-A in Turkey Creek Meadows, Unit 10, in the Town of Merrillville, as per plat thereof, recorded in Plat Book 36 page 100, in the Office of the Recorder of Lake County, Indiana.

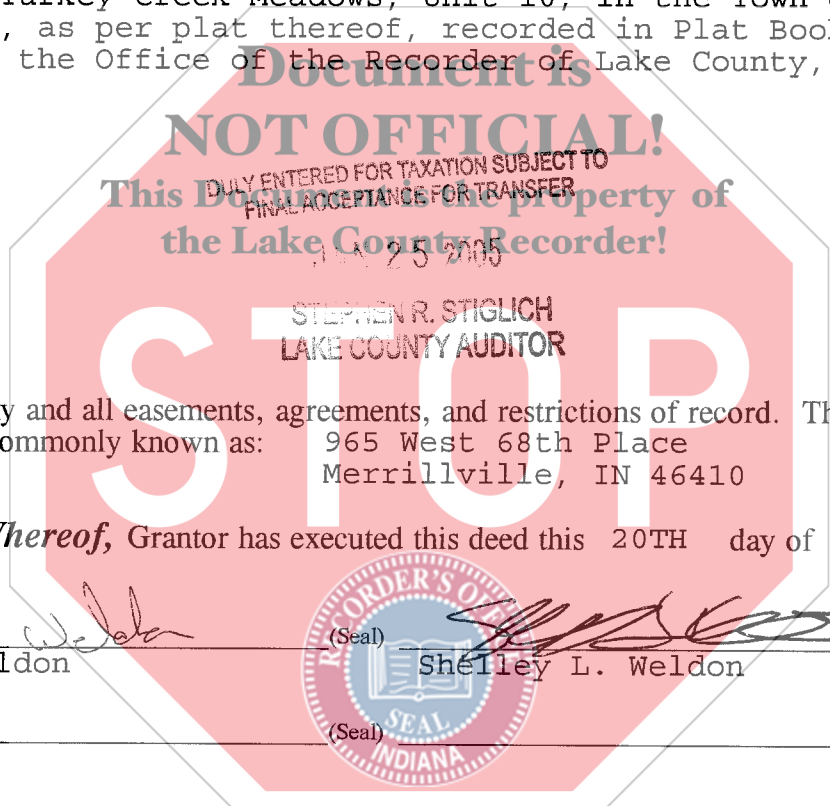

*Subject To* any and all easements, agreements, and restrictions of record. The address of such real estate is commonly known as: 965 West 68th Place Merrillville, IN 46410

*In Witness Whereof,* Grantor has executed this deed this 20TH day of JANUARY 2005.

*Gregory P. Weldon*  
\_\_\_\_\_  
Gregory P. Weldon

(Seal) *Shelley L. Weldon* (Seal)  
\_\_\_\_\_  
Shelley L. Weldon (Seal)

STATE OF INDIANA, Lake COUNTY ss: ACKNOWLEDGEMENT

Before me, a Notary Public in and for the said County and State, personally appeared Gregory P. Weldon Shelley L. Weldon

who acknowledged the execution of the foregoing Warranty Deed, and who, having been duly sworn, stated that any representations therein contained are true.

Witness my hand and notarial seal this 20th day of January, 2005.

My commission expires: 09/03/11

Signature *Joseph M. Yonkman*  
\_\_\_\_\_  
Joseph M. Yonkman, Notary Public  
Residing in Lake County, Indiana

THIS INSTRUMENT PREPARED BY: Jacob M. Yonkman, Attorney at Law 1432-45

Information from: Stewart Title Services

Send tax bills to: 965 W. 68th Place, Merrillville, IN 46410, 044503030

→ Stewart Title Services  
of Northwest Indiana  
The Pointe  
5521 W. Lincoln Hwy.  
Crown Point, IN 46307

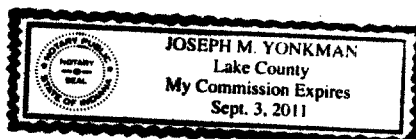

001177

*\$14.00*  
*ST*  
*2*