

1

STATE OF INDIANA
LAKE COUNTY
FILED FOR RECORD

2005 004422

2005 JAN 21 10:11:41

Mail tax bills to: 600 W. Main, Griffith, IN 46319

MICHAEL J. ...
RECORDER

WARRANTY DEED

THIS INDENTURE WITNESSETH, That Joseph M. Yech, not married,

("Grantor") of Lake County, in the State of INDIANA convey(s) and warrant(s) to:

James Jalk, *AN Unmarried Man*

("Grantee") of Lake County in the State of INDIANA, in consideration of One Dollar and other valuable consideration, the receipt and sufficiency of which are hereby acknowledged, the following described real estate in County in the State of Indiana:

LOT 27, 28 AND 29, IN BLOCK 14, IN RIDGEWOOD ADDITION TO GRIFFITH, AS PER PLAT THEREOF RECORDED IN PLAT BOOK 2, PAGE 80, IN THE OFFICE OF THE RECORDER OF LAKE COUNTY, INDIANA.

More commonly known as: 600 W. Main, Griffith, Indiana 46319

Tax Key No.: 15-26-0151-0028

Subject to covenants and restrictions, easements for streets and utilities, and building lines, as contained in plat of subdivision and as contained in all other documents of record; and taxes for 2003 due and payable in 2004.

Dated this 24th day of November, 2004

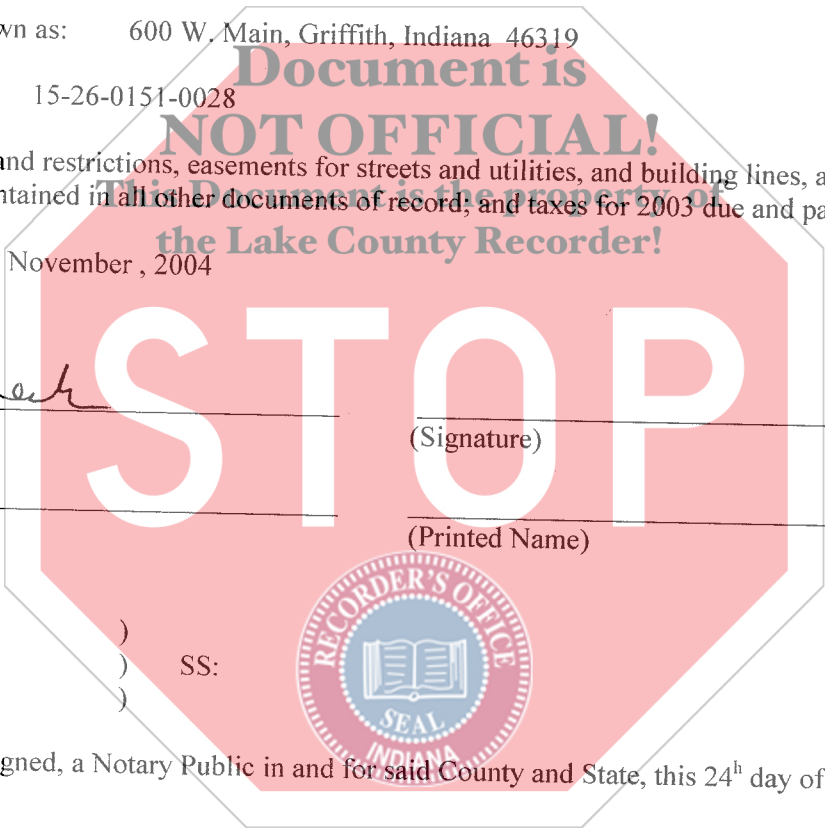

Joseph M. Yech
Joseph M. Yech

(Signature)

(Printed Name)

(Printed Name)

STATE OF ILLINOIS)

SS:

COUNTY OF COOK)

Before me, the undersigned, a Notary Public in and for said County and State, this 24th day of November, 2004, personally appeared:

JOSEPH M. YECH, *NOT married*

and acknowledged the execution of the foregoing deed. In witness whereof I have hereunto subscribed my name and affixed my official seal.

My comm. Exp. *09/25/05*

Signature *Barbara L. Rapp*

Resident of Cook County, *ILLINOIS*

Printed Name *Barbara L. Rapp*

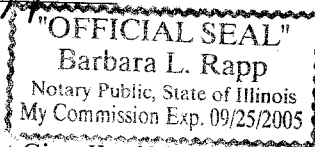

This instrument prepared by ATTY. FRED M. BECKER, 136 Pulaski Road, Calumet City, IL 60409
Atty I.D. 2640-98 (708) 891-3131

Mail to: *JAMES JALK
600 W. Main
Griffith, IN 46319*

DULY ENTERED FOR TAXATION SUBJECT TO
FINAL ACCEPTANCE FOR TRANSFER

JAN 21 2005

STEPHEN R. STIGLICH
LAKE COUNTY AUDITOR

*cc 1029 14.00 Km
ATGF
1340983
CK #1452*