

RECORDING REQUESTED BY:
Countrywide Home Loans, Inc.
1800 Tapo Canyon Road, SV2-116
Simi Valley, CA 93063

4
↗
WHEN RECORDED MAIL TO:
Countrywide Home Loans, Inc.
1800 Tapo Canyon Road
Simi Valley, CA 93063
MSN: SV2-116
Doc # 000491936842005N

2005 001786

STATE OF INDIANA
LAKE COUNTY
FILED FOR RECORD

2005 JUN 10 PM 12:05

MICHAEL A. PUGH
RECORDER

This Space for Recorder's Use Only

TITLE OF DOCUMENT:



THIS SPACE ADDED TO PROVIDE ADEQUATE SPACE FOR RECORDING INFORMATION
(Additional recording fee applies)

► 059-TITLE PAGE (R7/95)

18.00
at 7P
0001015909, 0000966112

3

RECORDING REQUESTED BY:
Countrywide Home Loans, Inc.

WHEN RECORDED MAIL TO:
Attn: Nicole A. Cedillo
Countrywide Home Loans
1800 Tapo Canyon Road, SV2-116
Simi Valley, CA 93063
Doc #000491936842005N

2004 067697

STATE OF INDIANA
LAKE COUNTY
FILED FOR RECORD
2004 AUG 11 AM 8:45
MORRIS W. CASTER
RECORDER

This Space for Recorder's Use Only

TITLE OF DOCUMENT:

Assignment of Mor



610 049193684 D4 001 005

Document is
NOT OFFICIAL!

*** This Assignment of Mortgage is re-recording to add Deed of Trust recording information, and to add notary name after verbiage in notary.

Recorded on February 4, 2004 Doc # 2004009323. ***

STOP

THIS SPACE ADDED TO PROVIDE ADEQUATE SPACE FOR RECORDING INFORMATION
(Additional recording fee applies)



► 059-TITLE PAGE (R7/95)

15.00
210
897900

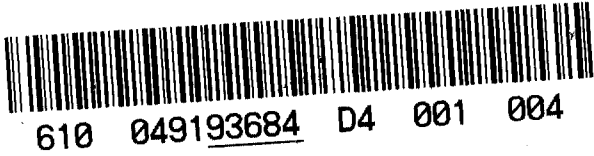

IN

2004 009323

STATE OF INDIANA
LAKE COUNTY
FILED FOR RECORD
2004 FEB -4 AM 9:11
MORRIS W. CARTER
RECORDER

After Recording Return To:
COUNTRYWIDE HOME LOANS, INC.
MS SV-79 DOCUMENT PROCESSING
P.O.Box 10423
Van Nuys, CA 91410-0423

[Space Above This Line For Recording Data]

IN1517486123703
[Case #]

920039378
[Escrow/Closing #]

0004919368401004
[Doc ID #]

ASSIGNMENT OF MORTGAGE

KNOW ALL MEN BY THESE PRESENTS That

COUNTRYWIDE HOME LOANS, INC.
4500 Park Granada, Calabasas, CA 91302-1613
organized and existing under the laws of NEW YORK, party of the first part, for
value received, has granted, bargained, sold, assigned, transferred and set over, and by these presents does
grant, sell, assign, transfer and set over unto

THE LEADER MORTGAGE COMPANY,

organized and existing under the laws of OHIO, whose location and mailing
address (if different) is

1015 EUCLID AVENUE, CLEVELAND, OH, 44115

party of the second part, its successors and assigns, a certain indenture of mortgage dated
JANUARY 30, 2004, made by
DANIEL TINOKO, SOLE

to it, securing the payment of one promissory note therein described for the sum of
NINETY THREE THOUSAND EIGHT HUNDRED EIGHTY SEVEN and 00/100

Dollars (\$ 93,887.00), and all its rights, title and interest in and to the premises situated in the
county of LAKE, State of Indiana, and described in said
mortgage as follows, to-wit:

Lot 9 in Boyd's 1st Subdivision, in the City of Hobart, as per plat
thereof, recorded in Plat Book 41 page 100, in the Office of the Recorder
of Lake County, Indiana.

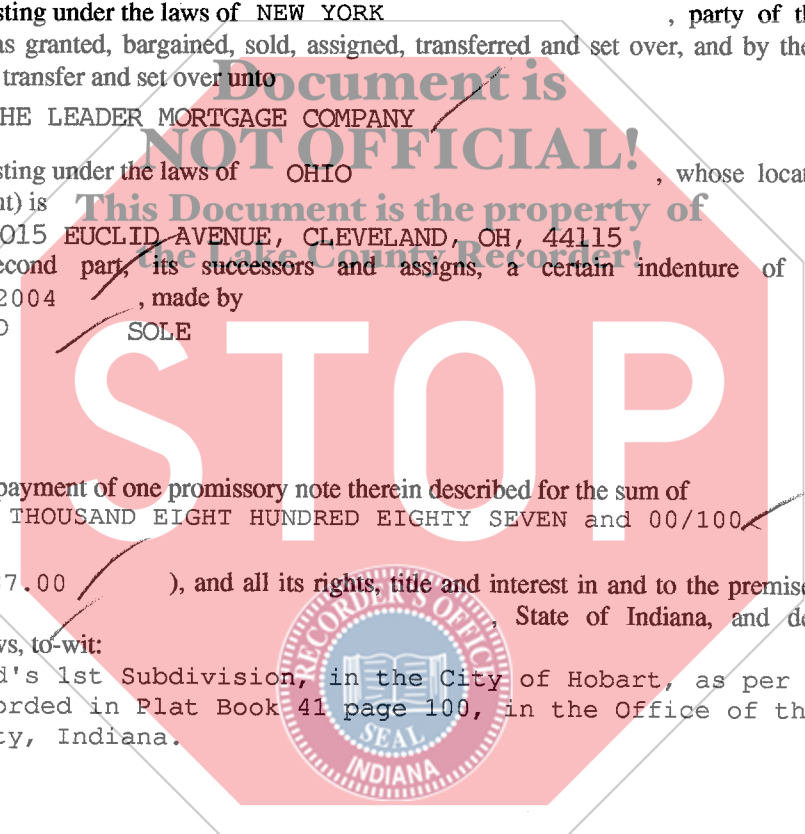

98.39378
TICOR INT

MTG 2004-009322

Indiana Assignment of Mortgage

Page 1 of 2

VMP 995(IN) (0307)

CHL (08/03)(d)

VMP Mortgage Solutions (800)521-7291

Initials:

7/03



* 2 3 9 9 1 *



* 0 4 9 1 9 3 6 8 4 0 0 0 0 2 9 9 5 - *

CASE #: IN1517486123703

DOC ID #: 0004919368401004

which said mortgage is recorded in the office of the Recorder of
LAKE County, in the State of Indiana, in Book No.
at Page as Document No. 2004009323 * together with the said note therein described
and the money due or to grow due thereon, with the interest: * 2004 009322, 2-4-04.

TO HAVE AND TO HOLD the same unto the said party of the second part, its successors and assigns,
forever, subject only to the provisions in the said indenture of mortgage contained.

IN WITNESS WHEREOF, the party of the first part has caused this instrument to be executed in its
name by JULI BELICEK
its LOAN SPECIALIST II, and attested by KELLY NEFF, its
LOAN SPECIALIST II and its corporate seal to be hereunto affixed this
THIRTIETH day of January, A.D. 2004.
ATTEST:

COUNTRYWIDE HOME LOANS, INC.

Document is NOT OFFICIAL!

Juli Belicek

By:

Kelly Neff

JULI BELICEK, LOAN SPECIALIST II
STATE OF INDIANA
COUNTY OF LAKE

KELLY NEFF, LOAN SPECIALIST II

On 1/30/04

, before me *MELINDA KAY MORGAN*

Juli Belicek, personally appeared
KELLY NEFF, personally known to me (or proved to me on the

basis of satisfactory evidence) to be the person(s) whose name(s) is/are subscribed to the within instrument and acknowledged to me that he/she/they executed the same in his/her/their authorized capacity(ies), and that by his/her/their signature(s) on the instrument the person(s), or the entity upon behalf of which the person(s) acted, executed the instrument.

WITNESS my hand and official seal.
(This area for official notarial seal)

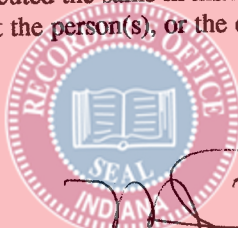
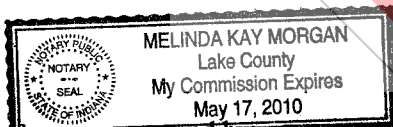

Melinda Kay Morgan

(Seal)

This instrument was prepared by: *SULLANNA BELICEK*
COUNTRYWIDE HOME LOANS, INC.
address:
1525 US HIGHWAY 41 SUITE C-26, SCHERERVILLE, IN 46375
tel. no.: (219) 322-2802