

RECORDING REQUESTED BY:
Countrywide Home Loans, Inc.
1800 Tapo Canyon Road, SV2-116
Simi Valley, CA 93063

WHEN RECORDED MAIL TO:
Countrywide Home Loans, Inc.
1800 Tapo Canyon Road
Simi Valley, CA 93063
MSN: SV2-116
Doc # 000414583482005N

2005 001781

STATE OF INDIANA
LAKE COUNTY
FILED FOR RECORD

2005 JAN 10 PM 12:01

MICHAEL J. ...
RECORDER

4

7

This Space for Recorder's Use Only

TITLE OF DOCUMENT:

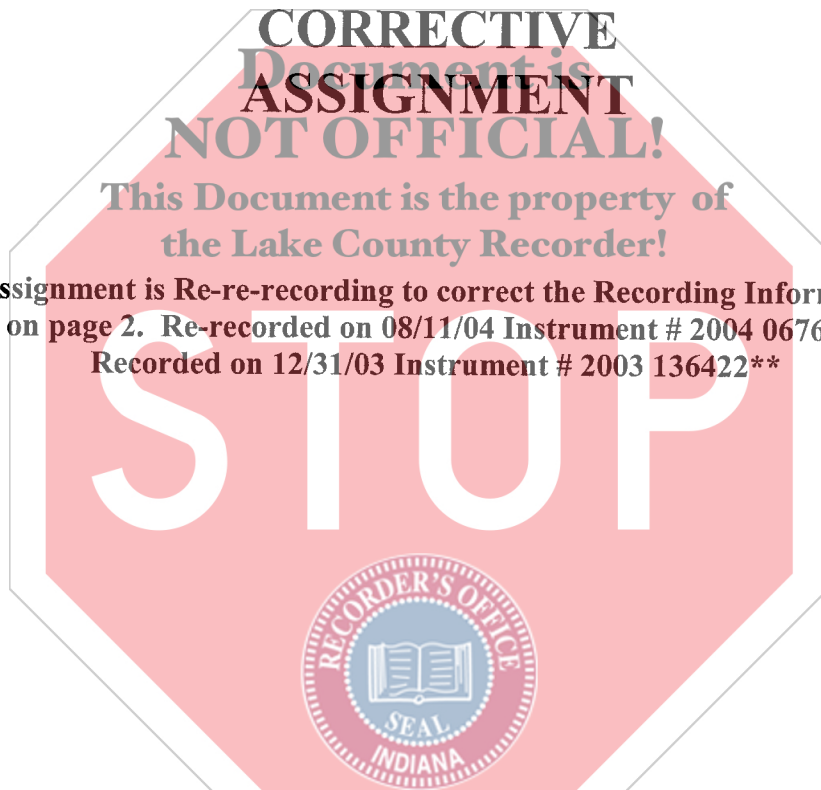

THIS SPACE ADDED TO PROVIDE ADEQUATE SPACE FOR RECORDING INFORMATION
(Additional recording fee applies)

► 059-TITLE PAGE (R7/95)

18.00
20
00014599, 000966103

3

RECORDING REQUESTED BY:
Countrywide Home Loans, Inc.

WHEN RECORDED MAIL TO:
Attn: Nicole A. Cedillo
Countrywide Home Loans
1800 Tapo Canyon Road, SV2-116
Simi Valley, CA 93063
Doc #000414583482005N



2004 067686

STATE OF INDIANA
LAKE COUNTY
FILED FOR RECORD

2004 AUG 11 AM 8:42

MORRIS W. CARTER
RECORDER

This Space for Recorder's Use Only

TITLE OF DOCUMENT:



610 041458348 D4 001 005

Assignment

2 / IN.

Document is
NOT OFFICIAL!

*** This Assignment is re-recording to add the Deed of Trust recording information, and add the proper names after verbiage on the notary.

Recorded on December 31, 2003 Doc # 2003-136422. ***

STOP

THIS SPACE ADDED TO PROVIDE ADEQUATE SPACE FOR RECORDING INFORMATION
(Additional recording fee applies)



► 059-TITLE PAGE (R7/95)

~~15.00~~
~~7.12~~
892891

2



610 041458348 D4 001 002

IN

STATE OF INDIANA
LAKE COUNTY
FILED FOR RECORD

2003 DEC 31 AM 10:33

MORAN W. CASTER
RECORDER

2003 136422

HOLD FOR MERIDIAN TITLE CORP

After Recording Return To:
COUNTRYWIDE HOME LOANS, INC.
MS SV-79 DOCUMENT PROCESSING
P.O.Box 10423
Van Nuys, CA 91410-0423

[Space Above This Line For Recording Data]

IN1517448988703
[Case #]

3387LK03
[Escrow/Closing #]

0004145834812003
[Doc ID #]

ASSIGNMENT OF MORTGAGE

KNOW ALL MEN BY THESE PRESENTS That

COUNTRYWIDE HOME LOANS, INC.
4500 Park Granada, Calabasas, CA 91302-1613
organized and existing under the laws of NEW YORK

, party of the first part, for value received, has granted, bargained, sold, assigned, transferred and set over, and by these presents does grant, sell, assign, transfer and set over unto

THE LEADER MORTGAGE COMPANY, organized and existing under the laws of OHIO, whose location and mailing address (if different) is

1015 EUCLID AVENUE, CLEVELAND, OH, 44115

party of the second part, its successors and assigns, a certain indenture of mortgage dated DECEMBER 19, 2003, made by TANYA L MOORE, SOLE

to it, securing the payment of one promissory note therein described for the sum of SIXTY ONE THOUSAND THIRTY SEVEN and 00/100

Dollars (\$ 61,037.00), and all its rights, title and interest in and to the premises situated in the county of LAKE State of Indiana, and described in said mortgage as follows, to-wit:

Lot Numbered 40 and the South 12.5 feet of Lot Numbered 41, in Block "A", as shown on the recorded plat of Elliot's Park, in the City of Lake Station, recorded in Plat Book 21, page 36, in the Office of the Recorder of Lake County, Indiana.

mort. 2003-136421

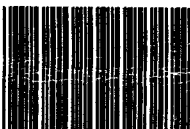
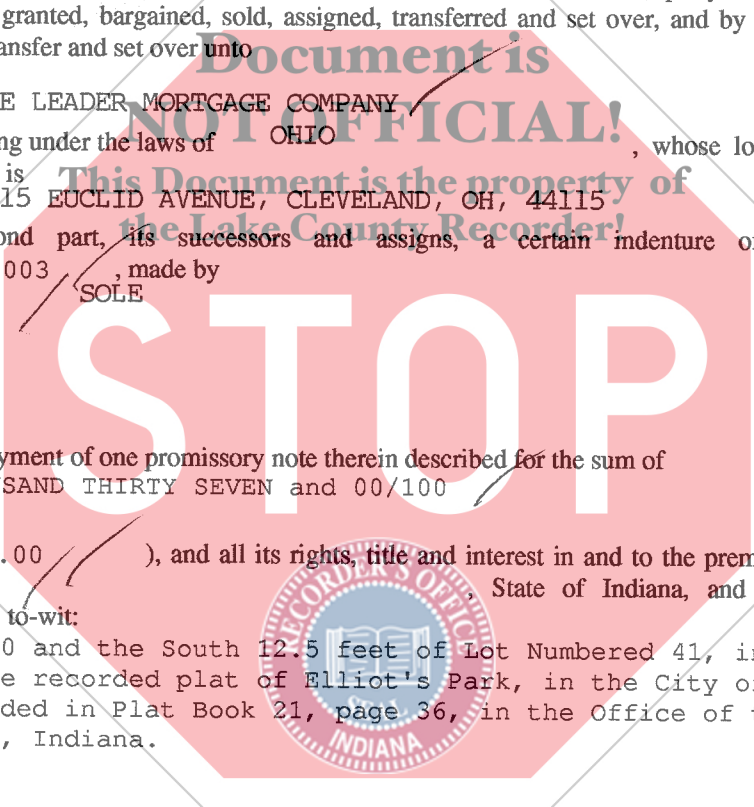

* 2 3 9 9 1 *



* 0 4 1 4 5 8 3 4 8 0 0 0 0 2 9 9 5 - *

CASE #: IN1517448988703

DOC ID #: 0004145834812003

which said mortgage is recorded in the office of the Recorder of

LAKE County, in the State of Indiana, in Book No.

at Page 2003-136422 as Document No. ~~2003-136422~~ together with the said note therein described and the money due or to grow due thereon, with the interest: * 2003 136421, 12-31-03.

TO HAVE AND TO HOLD the same unto the said party of the second part, its successors and assigns, forever, subject only to the provisions in the said indenture of mortgage contained.

IN WITNESS WHEREOF, the party of the first part has caused this instrument to be executed in its name by JULI BELICEK its LOAN SPECIALIST II, and attested by STACI FINCH, its

LOAN SPECIALIST II and its corporate seal to be hereunto affixed this NINETEENTH day of December, A.D. 2003.

ATTEST:

COUNTRYWIDE HOME LOANS, INC.

Document is NOT OFFICIAL!

Juli Belicek

Staci Finch

JULI BELICEK, LOAN SPECIALIST II
STATE OF INDIANA
COUNTY OF LAKE

By: *Staci Finch*
STACI FINCH, LOAN SPECIALIST II

On 12/19/03, before me

MELINDA KAY MORGAN

Juli Belicek personally appeared
& *STACI FINCH*

basis of satisfactory evidence) to be the person(s) whose name(s) is/are subscribed to the within instrument and acknowledged to me that he/she/they executed the same in his/her/their authorized capacity(ies), and that by his/her/their signature(s) on the instrument the person(s), or the entity upon behalf of which the person(s) acted, executed the instrument.

WITNESS my hand and official seal.
(This area for official notarial seal)

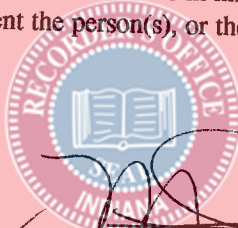

Melinda Kay Morgan (Seal)

This form was prepared by: *SOLANNA BELICEK*
COUNTRYWIDE HOME LOANS, INC.

address:
1525 US HIGHWAY 41 SUITE C-26, SCHERERVILLE, IN 46375
tel. no.: (219) 322-2802