

RECORDING REQUESTED BY:
Countrywide Home Loans, Inc.
1800 Tapo Canyon Road, SV2-116
Simi Valley, CA 93063

STATE OF INDIANA
LAKE COUNTY
FILED FOR RECORD

4
7
WHEN RECORDED MAIL TO:
Countrywide Home Loans, Inc.
1800 Tapo Canyon Road
Simi Valley, CA 93063
MSN: SV2-116
Doc # 000414583402005N

2005 001771

2005 JAN 10 AM 11:57

MICHAEL A. HAYES
RECORDER

This Space for Recorder's Use Only

TITLE OF DOCUMENT:



THIS SPACE ADDED TO PROVIDE ADEQUATE SPACE FOR RECORDING INFORMATION
(Additional recording fee applies)

► 059-TITLE PAGE (R7/95)

0001015899
0000966102
18.00
M

3

RECORDING REQUESTED BY:
Countrywide Home Loans, Inc.

STATE OF INDIANA
LAKE COUNTY
FILED FOR RECORD

WHEN RECORDED MAIL TO:
Attn: Nicole A. Cedillo
Countrywide Home Loans
1800 Tapo Canyon Road, SV2-116
Simi Valley, CA 93063
Doc #000414583402005N

2004 067685

2004 AUG 11 AM 8:40

MORRIS W. CARTER
RECORDER



TITLE OF DOCUMENT: _____ This Space for Recorder's Use Only

Assignment



610 041458340 D4 001 005

Document is
NOT OFFICIAL!

*** This Assignment is re-recording to add the Deed of Trust recording information, and add the proper names after verbiage on the notary.

Recorded on December 19, 2003 Doc # 2003-133567. ***

STOP

THIS SPACE ADDED TO PROVIDE ADEQUATE SPACE FOR RECORDING INFORMATION
(Additional recording fee applies)



► 059-TITLE PAGE (R7/95)

15.00
JP

89 2890

J

2003 133567

STATE OF INDIANA
LAKE COUNTY
FILED FOR RECORD
2003 DEC 19 AM 10:36
MORRIS W. CARTER
RECORDER

After Recording Return To:
COUNTRYWIDE HOME LOANS, INC.
MS SV-79 DOCUMENT PROCESSING
P.O.Box 10423
Van Nuys, CA 91410-0423

HOLD FOR MERIDIAN TITLE CORP

[Space Above This Line For Recording Data]

IN1517451885703 3393LK03 0004145834012003
[Case #] [Escrow/Closing #] [Doc ID #]

MTG. 2003-133567

ASSIGNMENT OF MORTGAGE

KNOW ALL MEN BY THESE PRESENTS That

COUNTRYWIDE HOME LOANS, INC.
4500 Park Granada, Calabasas, CA 91302-1613
organized and existing under the laws of NEW YORK, party of the first part, for
value received, has granted, bargained, sold, assigned, transferred and set over, and by these presents does
grant, sell, assign, transfer and set over unto

THE LEADER MORTGAGE COMPANY,

organized and existing under the laws of OHIO, whose location and mailing
address (if different) is

1015 EUCLID AVENUE, CLEVELAND, OH, 44115

party of the second part, its successors and assigns, a certain indenture of mortgage dated
DECEMBER 15, 2003, made by
THURMON RUSSELL, SOLE

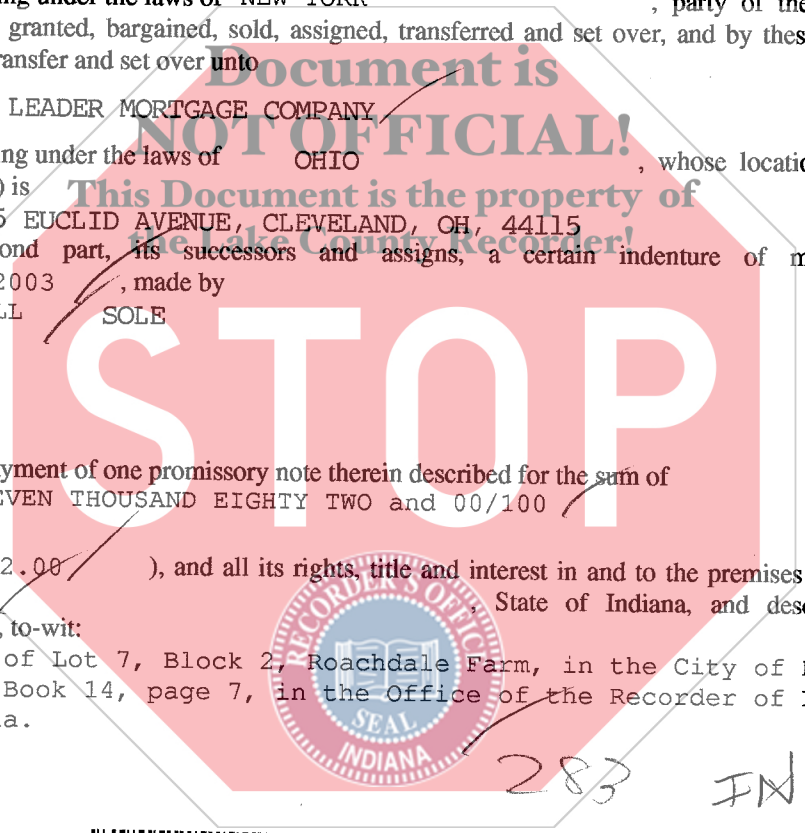

to it, securing the payment of one promissory note therein described for the sum of
ONE HUNDRED SEVEN THOUSAND EIGHTY TWO and 00/100

Dollars (\$ 107,082.00), and all its rights, title and interest in and to the premises situated in the
county of LAKE, State of Indiana, and described in said
mortgage as follows, to-wit:

The South 1/2 of Lot 7, Block 2, Roachdale Farm, in the City of Hobart, as
shown in Plat Book 14, page 7, in the Office of the Recorder of Lake
County, Indiana.

283 JN



610 041458340 D4 001 002

Indiana Assignment of Mortgage

Page 1 of 2

7/03

VMP -995(IN) (0307)

CHL (08/03)(d)

VMP Mortgage Solutions (800)521-7291

Initials *JN*



* 2 3 9 9 1 *



* 0 4 1 4 5 8 3 4 0 0 0 0 0 2 9 9 5 - *

*12-18-03
JN*

CASE #: IN1517451885703

DOC ID #: 0004145834012003

which said mortgage is recorded in the office of the Recorder of

LAKE

County, in the State of Indiana, in Book No.

at Page

as Document No. ~~2003-133567~~ together with the said note therein described

and the money due or to grow due thereon, with the interest: * 2003 133566, 12-19-03.

TO HAVE AND TO HOLD the same unto the said party of the second part, its successors and assigns, forever, subject only to the provisions in the said indenture of mortgage contained.

IN WITNESS WHEREOF, the party of the first part has caused this instrument to be executed in its name by JULI BELICEK, and attested by KELLY NEFF

its LOAN SPECIALIST II

, its

LOAN SPECIALIST II

and its corporate seal to be hereunto affixed this

FIFTEENTH day of December, A.D. 2003.

ATTEST:

COUNTRYWIDE HOME LOANS, INC.

Document is NOT OFFICIAL!

This Document is the property of Lake County Recorder!

Juli Belicek

Kelly Neff

JULI BELICEK, LOAN SPECIALIST II
STATE OF INDIANA
COUNTY OF LAKE

By: *Kelly Neff*
KELLY NEFF, LOAN SPECIALIST II

On 12/15/03, before me *MELINDA KAY MORGAN* ^{TMKM}
Juli Belicek, personally appeared
& Kelly Neff

, personally known to me (or proved to me on the basis of satisfactory evidence) to be the person(s) whose name(s) is/are subscribed to the within instrument and acknowledged to me that he/she/they executed the same in his/her/their authorized capacity(ies), and that by his/her/their signature(s) on the instrument the person(s), or the entity upon behalf of which the person(s) acted, executed the instrument.

WITNESS my hand and official seal.
(This area for official notarial seal)

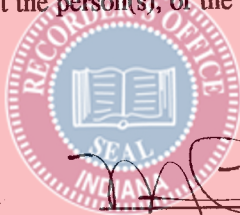

Melinda Kay Morgan (Seal)

This form was prepared by: JULIANNA BELICEK

COUNTRYWIDE HOME LOANS, INC.

address:

1525 US HIGHWAY 41 SUITE C-26, SCHERERVILLE, IN 46375

tel. no.: (219) 322-2802