

4
RECORDING REQUESTED BY:
Countrywide Home Loans, Inc.
1800 Tapo Canyon Road, SV2-116
Simi Valley, CA 93063

WHEN RECORDED MAIL TO:
Countrywide Home Loans, Inc.
1800 Tapo Canyon Road
Simi Valley, CA 93063
MSN: SV2-116
Doc # 000414580842005N

2005 001770

STATE OF INDIANA
LAKE COUNTY
FILED FOR RECORD

2005 JAN 10 AM 11:51

MICHAEL A. ...
RECORDER

This Space for Recorder's Use Only

TITLE OF DOCUMENT:

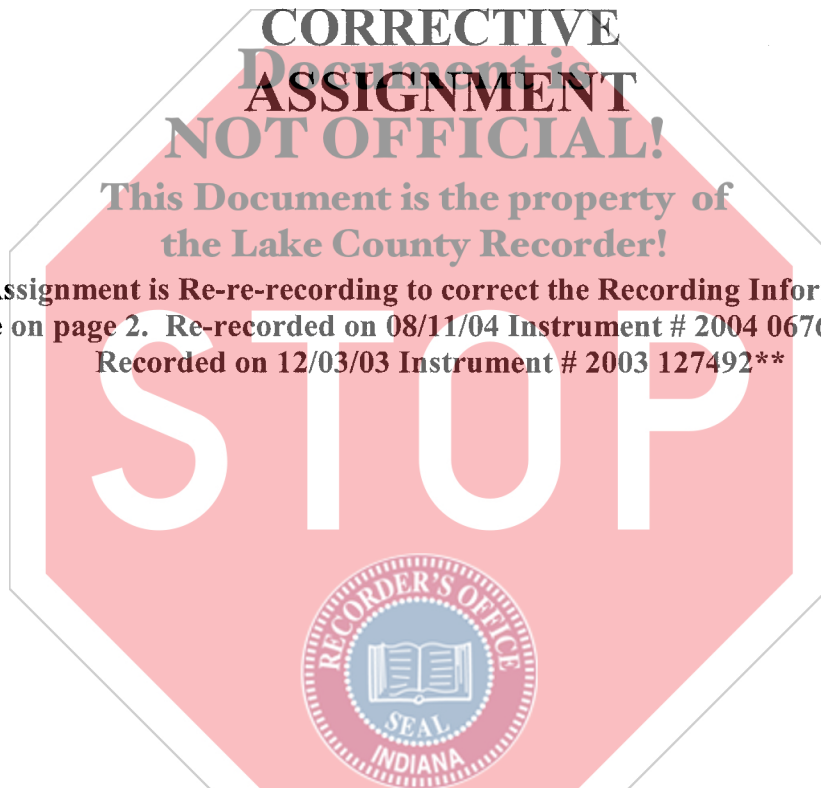

THIS SPACE ADDED TO PROVIDE ADEQUATE SPACE FOR RECORDING INFORMATION
(Additional recording fee applies)

► 059-TITLE PAGE (R7/95)

0000966101 , 0001015898
18.00
AS

3

RECORDING REQUESTED BY:
Countrywide Home Loans, Inc.

STATE OF INDIANA
LAKE COUNTY
FILED FOR RECORD

2004 067684

2004 AUG 11 AM 8:42

WHEN RECORDED MAIL TO:
Attn: Nicole A. Cedillo
Countrywide Home Loans
1800 Tapo Canyon Road, SV2-116
Simi Valley, CA 93063
Doc #000414580842005N

MORRIS W. CARTER
RECORDER



This Space for Recorder's Use Only

TITLE OF DOCUMENT:

200 / IN.

Assignment



610 041458084 D4 001 005

Document is
NOT OFFICIAL!

*** This Assignment is re-recording to add the Deed of Trust recording information, and add the proper names after verbiage on the notary. Recorded on December 3, 2003 Doc # 2003-127492. ***

STOP

THIS SPACE ADDED TO PROVIDE ADEQUATE SPACE FOR RECORDING INFORMATION
(Additional recording fee applies)



► 059-TITLE PAGE (R7/95)

15.00
24
892889

2

2003 127492

STATE OF INDIANA
LAKE COUNTY
PUBLIC RECORDER
2003 DEC -3 AM 11:02
MORRIS W. CARTER
RECORDER

After Recording Return To:
COUNTRYWIDE HOME LOANS, INC.
MS SV-79 DOCUMENT PROCESSING
P.O.Box 10423
Van Nuys, CA 91410-0423



610 041458084 D4 001 002

[Space Above This Line For

IN1517443974703
[Case #]

00027653
[Escrow/Closing #]

0004145808411003
[Doc ID #]

IN

ASSIGNMENT OF MORTGAGE

KNOW ALL MEN BY THESE PRESENTS That

COUNTRYWIDE HOME LOANS, INC.
4500 Park Granada, Calabasas, CA 91302-1613
organized and existing under the laws of NEW YORK

, party of the first part, for value received, has granted, bargained, sold, assigned, transferred and set over, and by these presents does grant, sell, assign, transfer and set over unto

THE LEADER MORTGAGE COMPANY

organized and existing under the laws of OHIO, whose location and mailing address (if different) is

1015 EUCLID AVENUE, CLEVELAND, OH, 44115

party of the second part, his successors and assigns, a certain indenture of mortgage dated NOVEMBER 26, 2003, made by TIMOTHY M ANDERSON, AND GLORIA A THOMAS JOINT

to it, securing the payment of one promissory note therein described for the sum of NINETY THREE THOUSAND SEVEN HUNDRED EIGHTY SIX and 00/100

Dollars (\$ 93,786.00), and all its rights, title and interest in and to the premises situated in the county of LAKE, State of Indiana, and described in said mortgage as follows, to-wit:

THE NORTH 50 FEET OF LOT 8, BLOCK 8, HARTMAN'S GARDENS SECOND ADDITION TO HAMMOND AS SHOWN IN PLAT BOOK 16, PAGE 9, LAKE COUNTY, INDIANA.

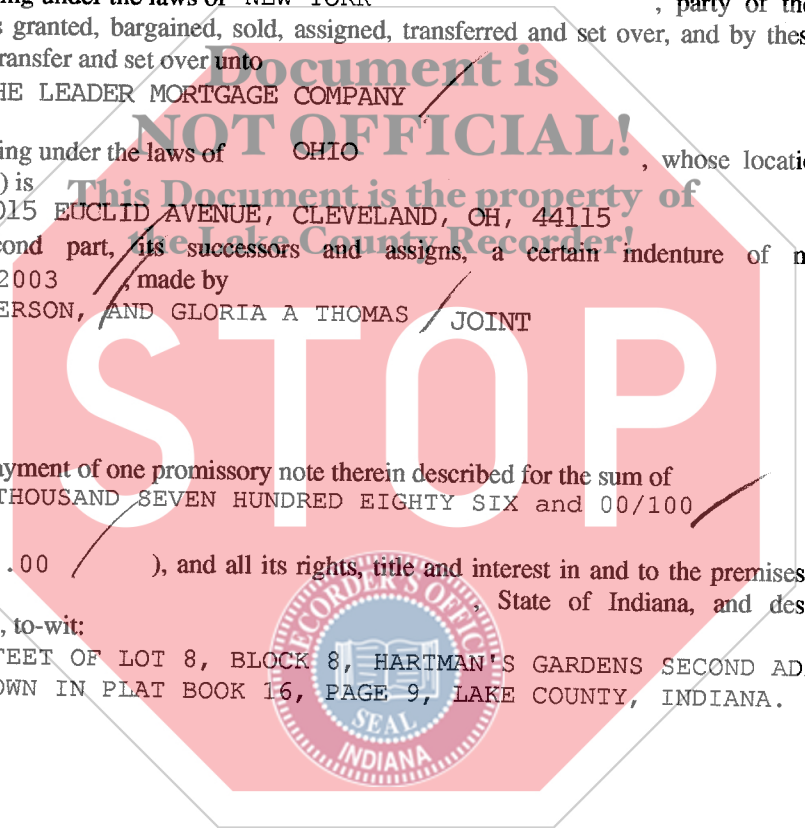

COMMUNITY TITLE COMPANY
FILE NO 27653

Indiana Assignment of Mortgage

Page 1 of 2

VMP -995(IN) (0307)

CHL (08/03)(d)

VMP Mortgage Solutions (800)521-7291

Initials: 7/03



* 2 3 9 9 1 *



* 0 4 1 4 5 8 0 8 4 0 0 0 0 2 9 9 5 - *

Wtg 2003-12-7491

CASE #: IN1517443974703

DOC ID #: 0004145808411003

which said mortgage is recorded in the office of the Recorder of
LAKE County, in the State of Indiana, in Book No.
at Page as Document No. ~~2003-127492~~ together with the said note therein described
and the money due or to grow due thereon, with the interest: *2003 127491, 12-03-03.

TO HAVE AND TO HOLD the same unto the said party of the second part, its successors and assigns,
forever, subject only to the provisions in the said indenture of mortgage contained.

IN WITNESS WHEREOF, the party of the first part has caused this instrument to be executed in its
name by JULI BELICEK
its LOAN SPECIALIST II , and attested by KELLY NEFF

LOAN SPECIALIST II and its corporate seal to be hereunto affixed this
TWENTY-SIXTH day of November , A.D. 2003 .
ATTEST:

COUNTRYWIDE HOME LOANS, INC.

Document is
NOT OFFICIAL!

Juli Belicek By: *Kelly Neff*
JULI BELICEK, LOAN SPECIALIST II
STATE OF INDIANA
COUNTY OF LAKE
KELLY NEFF, LOAN SPECIALIST II

On 11/26/03, before me *MELINDA KAY MORGAN* *MKM*
Juli Belicek *MKM*
KELLY NEFF personally appeared

, personally known to me (or proved to me on the
basis of satisfactory evidence) to be the person(s) whose name(s) is/are subscribed to the within instrument
and acknowledged to me that he/she/they executed the same in his/her/their authorized capacity(ies), and that
by his/her/their signature(s) on the instrument the person(s), or the entity upon behalf of which the person(s)
acted, executed the instrument.

WITNESS my hand and official seal.
(This area for official notarial seal)

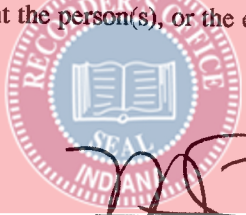

Melinda Kay Morgan (Seal)

This form was prepared by: JULIANNA BELICEK
COUNTRYWIDE HOME LOANS, INC.
address:
1525 US HIGHWAY 41 SUITE C-26, SCHERERVILLE, IN 46375
tel. no.: (219) 322-2802