

STATE OF INDIANA
LAKE COUNTY
FILED FOR RECORD

2005 000439

2005 JAN -5 AM 9:20

MICHAEL A. SWANWICK
RECORDER

Parcel No. 25-46-384-3

WARRANTY DEED

ORDER NO. 920047400

THIS INDENTURE WITNESSETH, That Sarah Lee Kelley

_____ (Grantor)
of Lake County, in the State of INDIANA CONVEY(S) AND WARRANT(S)
to Beverly Hill

_____ (Grantee)
of Lake County, in the State of INDIANA, for the sum of _____
TEN AND 00/100 Dollars (\$ 10.00)

and other valuable consideration, the receipt and sufficiency of which is hereby acknowledged, the following described real estate in Lake County, State of Indiana:

The South 1/2 of Lot 3 and all of Lot 4 in Block 1 in Pridmore, Orr & Ulrich Subdivision, in the City of Gary, as per plat thereof, recorded in Plat Book 6 page 26, in the Office of the Recorder of Lake County, Indiana.

Subject to real estate taxes for 2003 due and payable in 2004 and thereafter.

Subject to all covenants, conditions, restrictions, liens and easements of record.

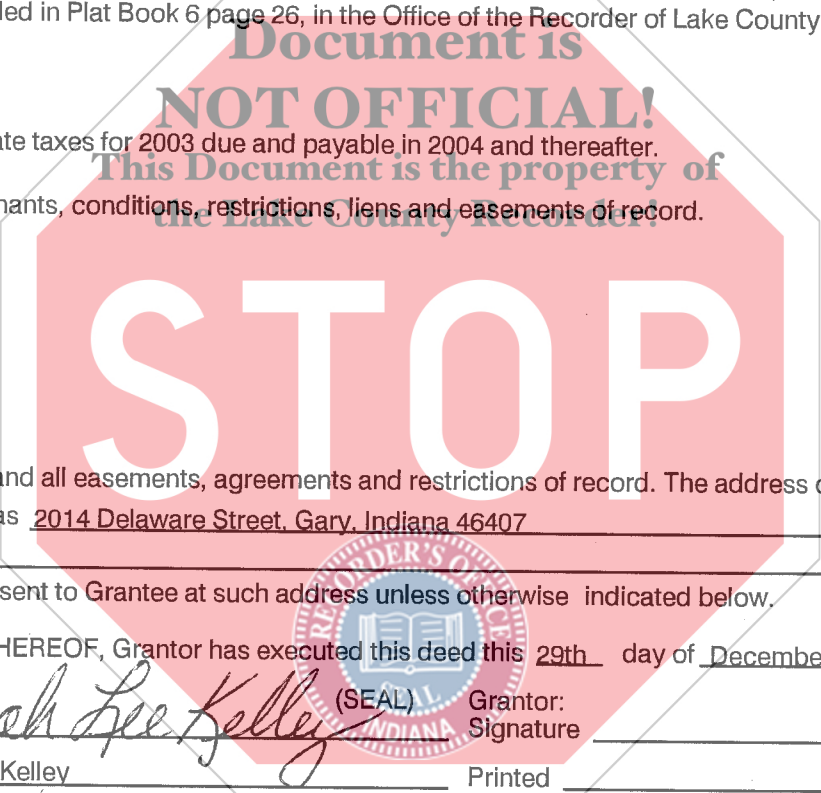

Subject to any and all easements, agreements and restrictions of record. The address of such real estate is commonly known as 2014 Delaware Street, Gary, Indiana 46407

Tax bills should be sent to Grantee at such address unless otherwise indicated below.

IN WITNESS WHEREOF, Grantor has executed this deed this 29th day of December, 2004.

Grantor: Sarah Lee Kelley (SEAL) Grantor: _____ (SEAL)
Signature _____ Signature _____
Printed Sarah Lee Kelley Printed _____

STATE OF INDIANA } SS: ACKNOWLEDGEMENT FINAL ACCEPTANCE FOR TRANSFER
COUNTY OF Lake

Before me, a Notary Public in and for said County and State, personally appeared Sarah Lee Kelley JAN 4 2005

who acknowledge the execution of the foregoing Warranty Deed, and who, having been duly sworn, stated that any representations therein contained are true. STEPHEN D. STIGLICH
LAKE COUNTY AUDITOR

Witness my hand and Notarial Seal this 29th day of December, 2004.

My commission expires: DECEMBER 5, 2010
Signature: Ivette S. Westerman
Printed Ivette S. Westerman, Notary Name
Resident of Lake County, Indiana.

This instrument prepared by Attny. Mark S. Lucas, 300 E. 90th Dr., Merrillville, IN 46410

Return deed to 2014 Delaware Street, Gary, Indiana 46407

Send tax bills to 2014 Delaware Street, Gary, Indiana 46407

000022

TICOR MO 92-47400



Handwritten initials: ti
14
B