

2

CORPORATE WARRANTY DEED

Order No. 920049499

THIS INDENTURE WITNESSETH, That Princeton Development, L.L.C. (Grantor) a corporation organized and existing under the laws of the State of INDIANA CONVEYS AND WARRANTS to Christopher N. Hoover and Kimberly S. Hoover, Husband and Wife (Grantee) of Lake County, in the State of INDIANA, for the sum of ONE AND 00/100 Dollars (\$1.00) and other valuable consideration, the receipt and sufficiency of which is hereby acknowledged, the following described real estate in Lake County, State of Indiana:

See "Exhibit A" attached hereto and made a part hereof.

Subject to any and all easements, agreements and restrictions of record. The address of such real estate is commonly known as 11718 Broadway, Crown Point, IN 46307

The undersigned persons executing this deed on behalf of Grantor represent and certify that they are duly elected officers of Grantor and have been fully empowered, by proper resolution of the Board of Directors of Grantor, to execute and deliver this deed; that Grantor has full corporate capacity to convey the real estate described herein; and that all necessary corporate action for the making of such conveyance has been taken and done.

IN WITNESS WHEREOF, Grantor has executed this deed 30th day of December, 2004.

(SEAL) ATTEST:

By _____

Printed Name, and Office

STATE OF Indiana
COUNTY OF Lake

SS:

My commission expires:
January 24, 2007

Signature Kimberly Jermolowicz
Printed Kimberly Jermolowicz, Notary Public
Resident of LAKE County, Indiana

This instrument prepared by: Scot F. Olthof, Secretary of OD Enterprises, Inc.

Return Document to: 11718 Broadway, Crown Point, IN 46307

Send Tax Bill to: 11718 Broadway, Crown Point, IN 46307

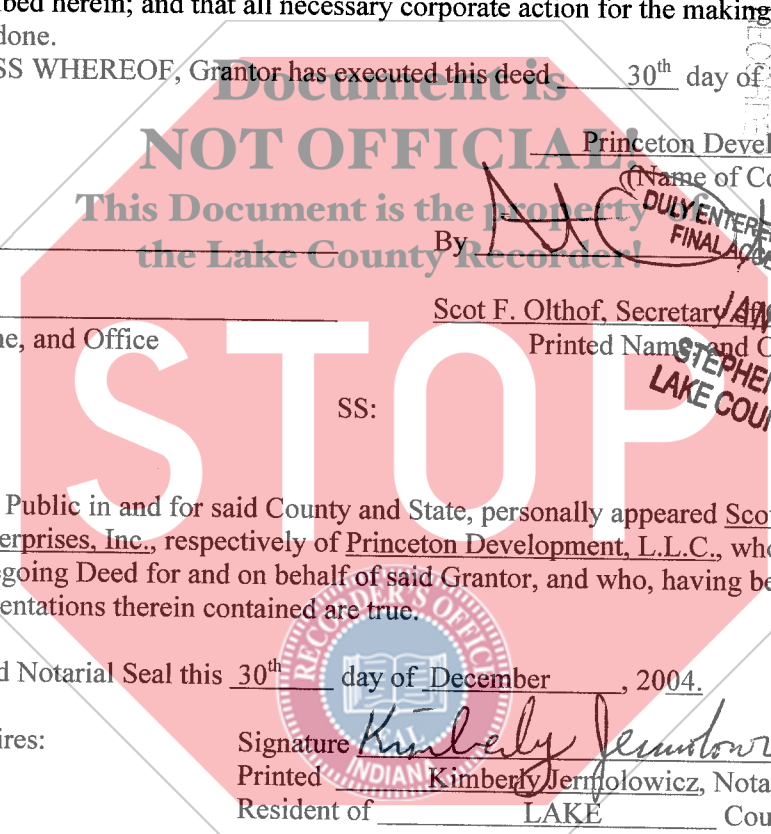
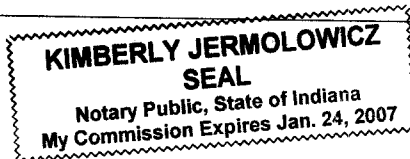

2004-12-30 00:38:14

STATE OF INDIANA
LAKE COUNTY
CLERK OF COUNTY RECORDS
DULY ENTERED FOR TAXATION SUBJECT TO FINAL ACCEPTANCE FOR TRANSFER
STEPHEN R. STIGLICH
LAKE COUNTY AUDITOR
2006

ti
17/23

No: 920049499

LEGAL DESCRIPTION

The North 20.0 feet of the South 279.4 feet of the East 82.00 feet of the West 117.00 feet of Lot 2, all by lines measured parallel to the South and West lines thereof, in Princeton Townhomes, an Addition to the City of Crown Point, as per plat thereof, recorded in Plat Book 95 page 81, in the Office of the Recorder of Lake County, Indiana.

