

STATE OF INDIANA
LAKE COUNTY
FILED FOR RECORD

2004 100639

2004 NOV 30 PM 2:05

WHEN RECORDED, MAIL TO:
AMERICA'S MORTGAGE BANC
10551 BARKLEY ST., #111
OVERLAND PARK, KANSAS 66212

MORRIS W. CENTER
RECORDER

This Instrument Prepared By:
JULIE KORTH

Order Number:
Escrow Number:
Application Number:
Loan Number: 0402180004

[Space Above This Line For Recorder's Use] 04000130

Corporation Assignment of Mortgage

FOR VALUE RECEIVED, AMERICA'S MORTGAGE BANC, KANSAS CORPORATION

having its principal place of business at 1166 QUAIL COURT, SUITE 200, PEWAUKEE, WISCONSIN, 53072

("Assignor"),

hereby grants, assigns and transfers to WELLS FARGO HOME MORTGAGE, INC.

("Assignee")

all of Assignor's rights, title and interest in, to, and under that certain Mortgage dated FEBRUARY 24, 2004 executed and delivered by ABRAHAM SEGOVIA AND MARIA SEGOVIA HUSBAND AND WIFE

and recorded either

concurrently herewith; or

as Instrument No. 2004-017746 on March 2, 2004 in book _____, page _____ of Official Records in the County Recorder's office of LAKE County,

covering certain real estate and other property described therein, more particularly described as follows:

LOT 4, BLOCK 3, WHITE OAK MANOR, THE 1ST RE-DIVISION TO CITY OF HAMMOND, PER PLAT THEREOF, FOUND IN PLAT BOOK 21 PAGE 24 IN THE OFFICE OF THE RECORDER OF LAKE COUNTY, INDIANA.
A.P.N. #: 26-36-0328-0004

ADDRESS: 7539 MAGNOLIA AVENUE, HAMMOND, INDIANA 46324

TOGETHER with the note or notes therein described or referred to therein and secured thereby, the money due and to become due thereon with interest, and all rights accrued or to accrue under said Mortgage.

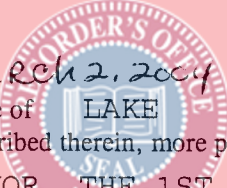
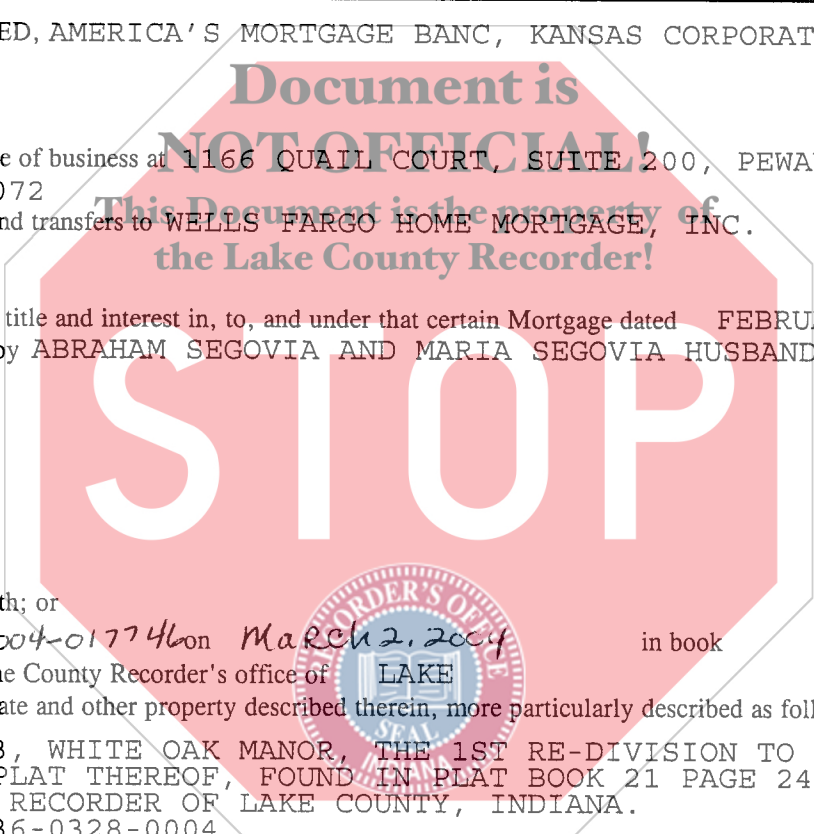

\$ 12

12
CC
CR # 4128



IN WITNESS WHEREOF, Assignor has caused this Corporation Assignment of Mortgage to be executed by its duly authorized officer as of the day and year first written below.

STATE OF KANSAS

COUNTY OF JOHNSON SS.

On FEBRUARY 24, 2004 before me,

MELISSA GRAFF Notary Public,
personally appeared, CHRISTOPHER S. CONWAY,
PRESIDENT

personally known to me (or proved to me on the basis of satisfactory evidence) to be the person(s) whose name(s) is/are subscribed to the within instrument and acknowledged to me that he/she/they executed the same in his/her/their authorized capacity(ies), and that by his/her/their signature(s) on the instrument the person(s), or the entity upon behalf of which the person(s), acted, executed the instrument.

WITNESS my hand and official seal.

Signature Melissa Graff
MELISSA GRAFF, JOHNSON COUNTY

Name (Typed or Printed)
Notary Public in for said State



MELISSA GRAFF
NOTARY PUBLIC
STATE OF KANSAS
COUNTY OF JOHNSON
MY COMM. EXPIRES 8/8/07

(Seal)

(This area for official notarial seal)

AMERICA'S MORTGAGE BANC, KANSAS CORPORATION

Christopher S. Conway
CHRISTOPHER S. CONWAY, PRESIDENT

