

2004 100374

2004 NOV 30 AM 9:38

MORRIS W. CARTER  
RECORDER

Parcel No. 29-4-155-30

**WARRANTY DEED**

ORDER NO. 620047084

CHICAGO TITLE INSURANCE COMPANY

THIS INDENTURE WITNESSETH, That Catherine L. Tylka

of Lake County, in the State of INDIANA (Grantor)  
to Charles E. Cole and Madeleine M. Cole, husband and wife CONVEY(S) AND WARRANT(S)

of Lake County, in the State of INDIANA (Grantee)  
for the sum of TEN AND 00/100 Dollars (\$ 10.00)

and other valuable consideration, the receipt and sufficiency of which is hereby acknowledged, the following described real estate in Lake County, State of Indiana:

SEE ATTACHED LEGAL DESCRIPTION

Subject to roads, highways, ditches, drains, easements, covenants and restrictions contained in all documents of record; all laws, ordinances and governmental regulations including building and zoning; any state of facts that an accurate survey might disclose; and real estate taxes and assessments for 2003 payable 2004 together with delinquency and penalty, if any, and all real estate taxes and assessments due and payable thereafter which the grantee herein assumes and agrees to pay.

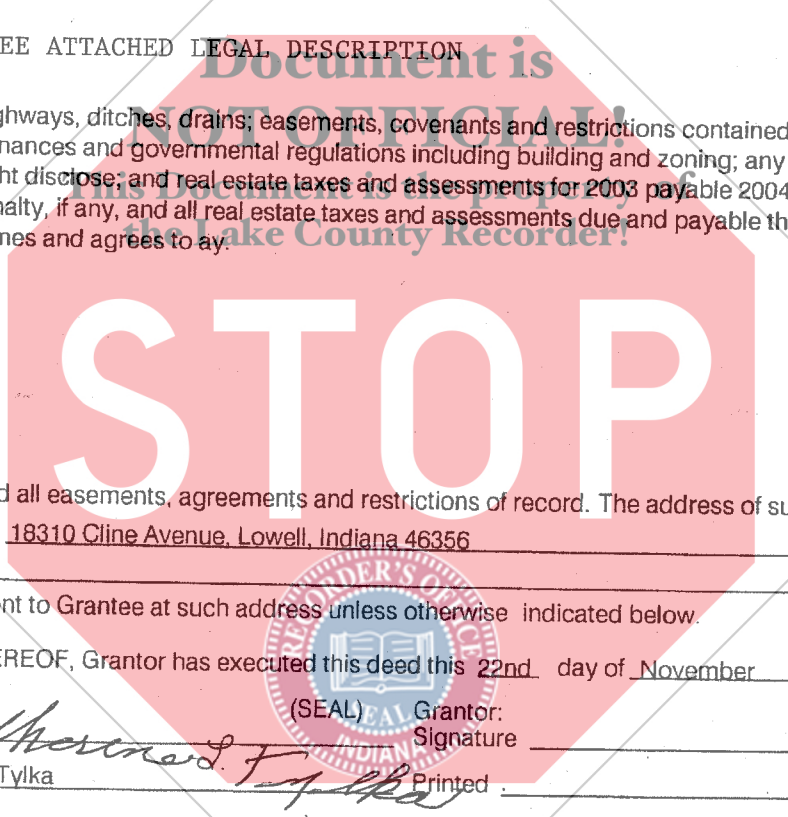

Subject to any and all easements, agreements and restrictions of record. The address of such real estate is commonly known as 18310 Cline Avenue, Lowell, Indiana 46356

Tax bills should be sent to Grantee at such address unless otherwise indicated below.

IN WITNESS WHEREOF, Grantor has executed this deed this 22nd day of November, 2004.

Grantor: Catherine L. Tylka (SEAL) Grantor: \_\_\_\_\_ (SEAL)  
Signature \_\_\_\_\_ Signature \_\_\_\_\_  
Printed Catherine L. Tylka Printed \_\_\_\_\_

STATE OF INDIANA }  
COUNTY OF Lake } SS: ACKNOWLEDGEMENT

Before me, a Notary Public in and for said County and State, personally appeared Catherine L. Tylka who acknowledge the execution of the foregoing Warranty Deed, and who, having been duly sworn, stated that any representations therein contained are true.

Witness my hand and Notarial Seal this 22nd day of November, 2004.

My commission expires: DECEMBER 28, 2006

Signature Brenda Sohovich **DULY ENTERED FOR TAXATION SUBJECT TO FINAL ACCEPTANCE FOR TRANSFER**  
Printed Brenda Sohovich NOV 29, 2004 Notary Name  
Resident of Porter STEPHEN R. STIGLICH na.  
LAKE COUNTY AUDITOR

This instrument prepared by Donna LaMere, Attorney at Law #03089-64 ss/cp

Return deed to 18310 Cline Avenue, Lowell, Indiana 46356

Send tax bills to 18310 Cline Avenue, Lowell, Indiana 46356

16-  
MV  
CT

No: 620047084

### LEGAL DESCRIPTION

Part of the Northeast Quarter of Section 27, Township 33 North, Range 9 West of the 2nd Principal Meridian, described as follows: Beginning at a point on the East line of said Section 27 and 1,524.00 feet South of the Northeast corner thereof; thence North 88 degrees 29 minutes 45 seconds West and parallel to the North line of said Section 27, a distance of 230.00 feet; thence North 00 degrees 19 minutes 37 seconds West, 2.50 feet; thence South 89 degrees 16 minutes 15 seconds East, 229.92 feet to the East line of said Section 27; thence South 00 degrees 19 minutes 37 seconds East, 5.61 feet, more or less to the Point of Beginning, in Lake County, Indiana.

