

2004 098929

2004 NOV 20 10 40

SWORN STATEMENT OF INTENTION TO HOLD LIEN (NOTICE OF MECHANIC'S LIEN)

To: PAMELA J. VANDERVOORT
710 N. MAIN ST CROWN POINT, IN 46307
Owner's Name and Address

State of Indiana, County of _____ ss

The undersigned, being first duly sworn, makes this sworn statement of intention to hold a lien upon the property described below and says that:

1. The undersigned JOHN C. RUIZ
1819 Magnolia Lane Munster, IN 46321

intends to hold a lien on land legally described as follows: KEY # 23-09-0324-0012
DESCRIPTION - PT. W2 NW SE S. 5 T. 34 R 8. 275 A
UNPAID BALANCE ON PAINT CONTRACT DOC. 2001 104823

of ADDITIONAL PAINT & CAULK WORK WITH
NO INTENTION OF CUSTOMER TO PAY.

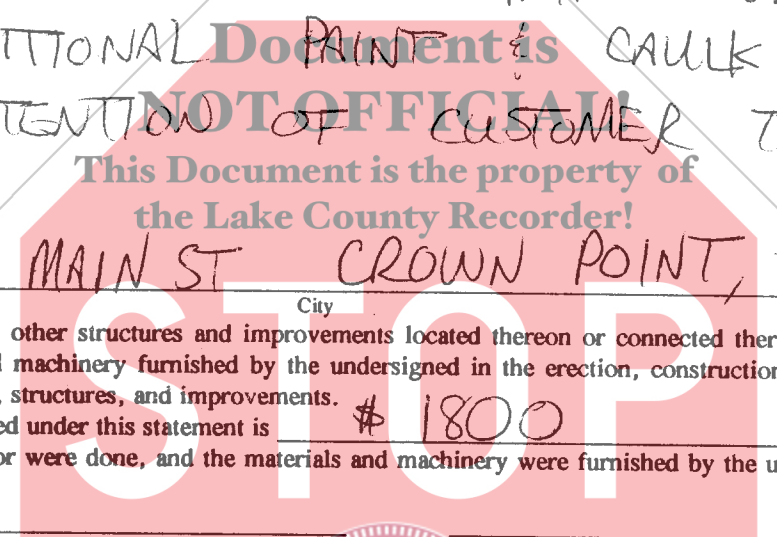

and commonly known as: 710 N. MAIN ST CROWN POINT, IN.

Street _____ City _____ State _____
as well as on all building, other structures and improvements located thereon or connected therewith for work and labor done and/or materials and machinery furnished by the undersigned in the erection, construction, altering, repairing, and removing of said buildings, structures, and improvements.

2. The amount claimed under this statement is \$ 1800 Dollars (\$ 1800).

3. The work and labor were done, and the materials and machinery were furnished by the undersigned within the last sixty (60) days.

State of Indiana, _____ County, ss

Before me, a Notary Public in and for said County and State, personally appeared John C. Ruiz
and _____ who acknowledged the execution of the foregoing Sworn Statement and Notice of Intention to Hold Mechanic's Lien, and who, having been duly sworn, under the penalties of perjury, stated that the facts and matters therein set forth are true and correct.

Witness my hand and Notarial Seal this date November 20, 2004.

My commission expires May 6, 2012 Jessica Ward Notary Public

Resident of Cane County Jessica Ward (Printed)

I hereby certify that I have this date _____, 20____, mailed a duplicate of this notice, first class, postage prepaid, to the within named property owner at (latest address shown on tax records) _____

Recorder of _____ County

This instrument prepared by: _____ Resident of _____ County

1 ADD
M.V.
CASH