

RECORDING REQUESTED BY:
Countrywide Home Loans, Inc.
1800 Tapo Canyon Road,
Simi Valley, CA 93063

2004 095253

STATE OF INDIANA
LAKE COUNTY
FILED FOR RECORD

2004 NOV -8 PM 2:42

MORRIS W. CARTER
RECORDER

3
7
WHEN RECORDED MAIL TO:
Countrywide Home Loans, Inc.
1800 Tapo Canyon Road
Simi Valley, CA 93063
MSN: SV2-116
Doc # 000622856832005N

This Space for Recorder's Use Only

TITLE OF DOCUMENT:



THIS SPACE ADDED TO PROVIDE ADEQUATE SPACE FOR RECORDING INFORMATION
(Additional recording fee applies)

► 059-TITLE PAGE (R7/95)

15.00
ck xP
962945

STATE OF INDIANA
LAKE COUNTY
FILED FOR RECORD

2004 059916

2004 JUL 16 AM 8:58

MORRIS W. CARTER
RECORDER

IN/283

After Recording Return To:
COUNTRYWIDE HOME LOANS, INC.
MS SV-79 DOCUMENT PROCESSING
P.O.Box 10423
Van Nuys, CA 91410-0423

[Space Above This Line For Recording Data]

IN1517628405703 920043817 0006228568307004
[Case #] [Escrow/Closing #] [Doc ID #]

ASSIGNMENT OF MORTGAGE

KNOW ALL MEN BY THESE PRESENTS That

COUNTRYWIDE HOME LOANS, INC.
4500 Park Granada, Calabasas, CA 91302-1613
organized and existing under the laws of NEW YORK, party of the first part, for
value received, has granted, bargained, sold, assigned, transferred and set over, and by these presents does
grant, sell, assign, transfer and set over unto

U.S. BANK, N.A.

organized and existing under the laws of OHIO, whose location and mailing
address (if different) is 17500 ROCKSIDE ROAD, BEDFORD, OH, 44146

party of the second part, its successors and assigns, a certain indenture of mortgage dated
JULY 13, 2004, made by
VINETTA C GRAHAM SOLE

to it, securing the payment of one promissory note therein described for the sum of
FIFTY THREE THOUSAND EIGHT HUNDRED NINETY SIX and 00/100

Dollars (\$ 53,896.00), and all its rights, title and interest in and to the premises situated in the
county of LAKE, State of Indiana, and described in said

mortgage as follows, to-wit:
Lot 37 and 38 in Block 4 in Highland Park Addition to Gary, as per plat
thereof, recorded in Plat Book 8, page 13, in the Office of the Recorder
of Lake County, Indiana.

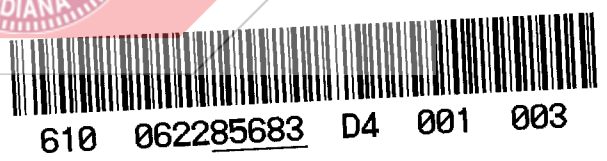
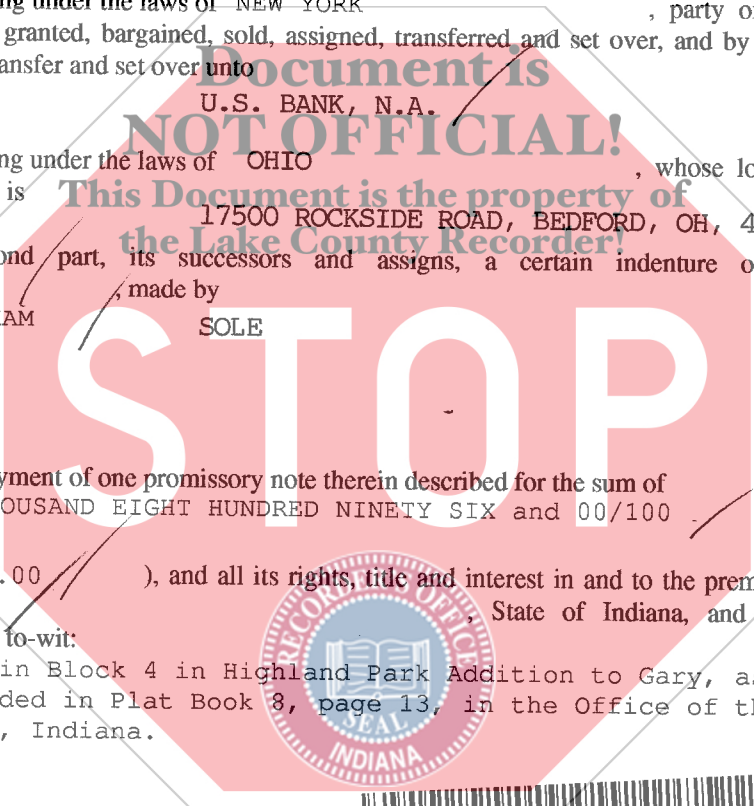

Indiana Assignment of Mortgage

Page 1 of 2

7/03

VMP -995(IN) (0307)

CHL (08/03)(d)

VMP Mortgage Solutions (800)521-7291

Initials



TICOR MO

920043817

12-60-11

mtg 2004-059915

CASE #: IN1517628405703

DOC ID #: 0006228568307004

which said mortgage is recorded in the office of the Recorder of

LAKE

County, in the State of Indiana, in Book No.

at Page

as Document No. 2004 05-9915

together with the said note therein described

and the money due or to grow due thereon, with the interest:

on 7-16-04.

TO HAVE AND TO HOLD the same unto the said party of the second part, its successors and assigns, forever, subject only to the provisions in the said indenture of mortgage contained.

IN WITNESS WHEREOF, the party of the first part has caused this instrument to be executed in its name by JULI BELICEK its LOAN SPECIALIST II, and attested by VALERIE NEFF, its

BRANCH OPERATIONS MANAGER and its corporate seal to be hereunto affixed this THIRTEENTH day of July, A.D. 2004.

ATTEST:

COUNTRYWIDE HOME LOANS, INC.

Document is NOT OFFICIAL!

Juli Belicek By *Valerie Neff*
JULI BELICEK, LOAN SPECIALIST II VALERIE NEFF, BRANCH OPERATIONS MANAGER
STATE OF INDIANA
COUNTY OF LAKE

On 7/13/04, before me

Juli Belicek, personally appeared

, personally known to me (or proved to me on the basis of satisfactory evidence) to be the person(s) whose name(s) is/are subscribed to the within instrument and acknowledged to me that he/she/they executed the same in his/her/their authorized capacity(ies), and that by his/her/their signature(s) on the instrument the person(s), or the entity upon behalf of which the person(s) acted, executed the instrument.

WITNESS my hand and official seal.
(This area for official notarial seal)

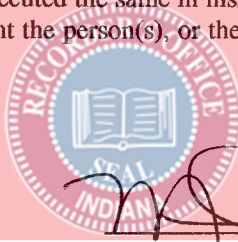
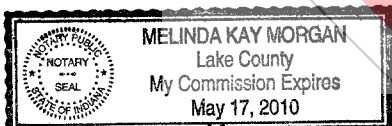

Melinda Kay Morgan (Seal)

This form was prepared by: JULI ANNA BELICEK
COUNTRYWIDE HOME LOANS, INC.
address:
1525 US HIGHWAY 41 SUITE C-26, SCHERERVILLE, IN 46375
tel. no.: (219) 322-2802