

2

STATE OF INDIANA  
LAKE COUNTY  
FILED FOR RECORD

2004 095124

2004 NOV -8 AM 10:39

MORRIS W. CARTER  
RECORDER

**SATISFACTION OF MORTGAGE**

This Certifies, That a certain Mortgage executed by LUCILLE RILEY. This Security Instrument is given to LAKE MORTGAGE COMPANY, INC. on the 15<sup>TH</sup> day of JULY 1998 calling for \$68,350.00 recorded in Mortgage Record No. Page No. Document # 98055453 LAKE COUNTY State of INDIANA has been fully paid and satisfied, and the same is hereby released.

WITNESSE our hand(s) and seal(s), this 18<sup>TH</sup> day of OCTOBER 2004.

ATTEST  
  
SUSAN M. BRISTOW, SECRETARY

Lake Mortgage Company, Inc.  
BY:   
MICHAEL J. HOWARD, TREASURER

State of Indiana, LAKE County, ss: \_\_\_\_\_ Before me, the undersigned, a Notary Public in and for said County, this 18<sup>TH</sup> day of OCTOBER 2004. Personally appeared Susan M. Bristow and Michael J. Howard respectively Secretary and Treasurer acknowledged the execution of the annexed satisfaction of mortgage.

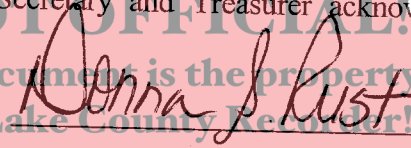
Witness my hand and official seal  /Donna S. Rust Notary Public.  
My Commission expires 11/18/08 County Residence Lake. This instrument was prepared by: Jackie Bisfelder, Lake Mortgage Co. 4000 West Lincoln Hwy. Merrillville, IN 46410

**LEGAL DESCRIPTION** →

SEE ATTACHED LEGAL DESCRIPTION.

PTN# 36-15-0257-0035, 36-15-0257-0018

501515/19262

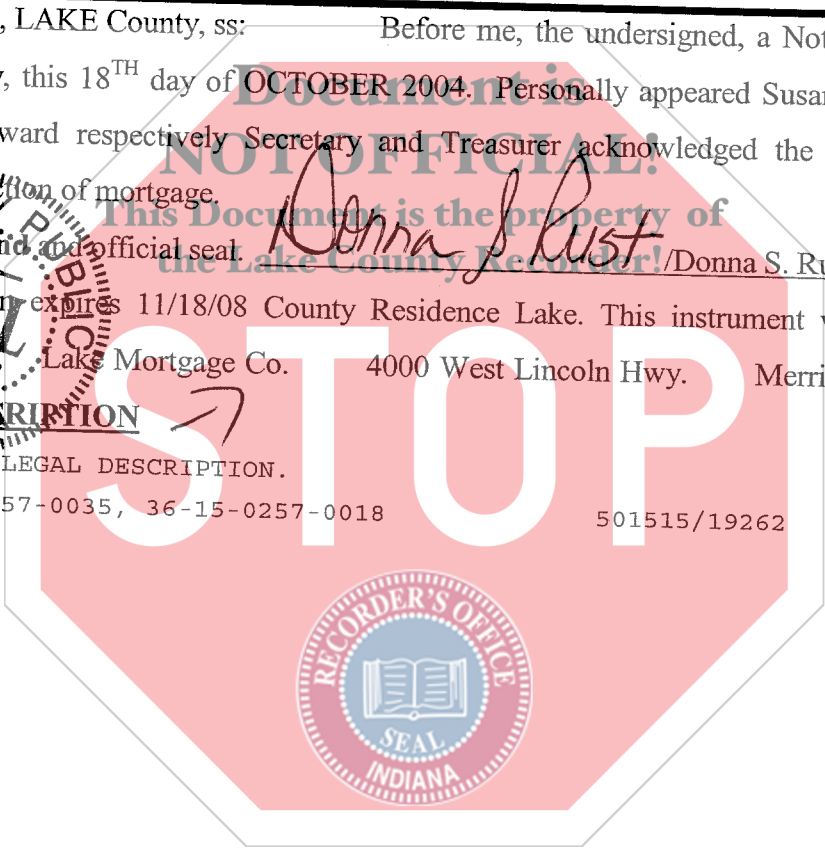

# 135450  
1200  
AB

**LEGAL DESCRIPTION**

Lot 18 and part of Lot 19 in Block "O" in Meadowland Estates Part No. 2 of Unit No. 2, as per plat thereof, recorded in Plat Book 31 page 7 in the Office of the Recorder of Lake County, Indiana; that part of Lot 19 described as follows: Commencing at the Southwest corner of said Lot 19; thence Northerly along the Westerly line of Lot 19 to the Northwest corner thereof; thence Southerly with an interior angle of 12 degrees 04 minutes a distance of 69.95 feet to a point; thence Southerly with an interior angle of 158 degrees 18 minutes 30 seconds a distance of 67 feet to a point on the Southerly line of Lot 19 and 4.11 feet Easterly of the Southwest corner of said Lot 19; thence Westerly 4.11 feet to the point of beginning.

