

CHICAGO TITLE INSURANCE COMPANY

MAIL TAX BILLS TO 123 E Pine Griffith IN 46319

620046735

WARRANTY DEED

Key # 15-26-153-45

THIS INDENTURE WITNESSETH, That **DAVID W. RIDDER**

("Grantor") of **LAKE** County in the State of **INDIANA**

CONVEYS AND WARRANTS TO **WILLIAM A. PIECH**

("Grantee") of **LAKE** County in the State of **INDIANA**

In consideration of One Dollar and other valuable consideration, the receipt and sufficiency of which are hereby acknowledged, the following described real estate in **LAKE** County, in the State of Indiana:

2004 69474

Lots 45 and 46 in Block 1 in St. Mary's Addition to Griffith, as per plat thereof, recorded in Plat Book 21 page 54, in the Office of the Recorder of Lake County, Indiana.

Common Address: 123 East Pine, Griffith, IN 46319

Tax Key #26-153-45

Subject to real estate taxes for 2003 payable in 2004, together with delinquency and penalty, if any, and all real estate taxes due and payable thereafter.

Subject to recorded liens, encumbrances, easements, restrictions, ditches and drains, highways and legal rights of way, and matters which would be disclosed by an accurate survey or inspection of the premises.

Dated this 29th day of OCT, 2004.

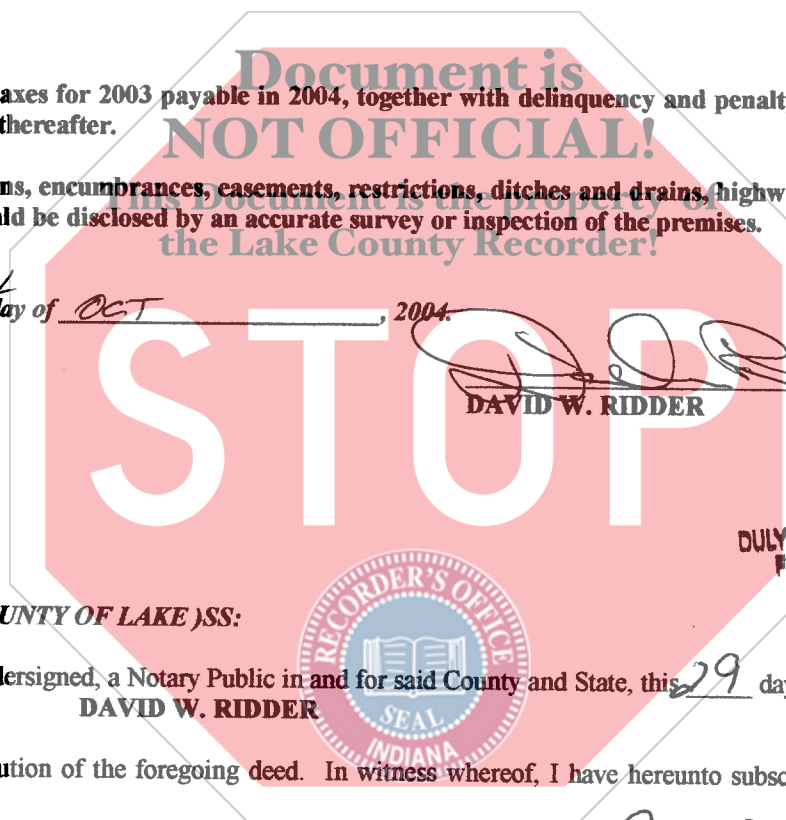

[Signature]
DAVID W. RIDDER

2004 NOV 5 AM 10:00
LAKE COUNTY RECORDER

DULY ENTERED FOR TAXATION SUBJECT TO FINAL ACCEPTANCE FOR TRANSFER

NOV 4 2004

STATE OF INDIANA; COUNTY OF LAKE)SS:

Before Me, the undersigned, a Notary Public in and for said County and State, this 29 day of OCT, 2004, personally appeared: **DAVID W. RIDDER**

STEPHEN B. STIGLICH
LAKE COUNTY AUDITOR

and acknowledged the execution of the foregoing deed. In witness whereof, I have hereunto subscribed my name and affixed my official seal.

My Commission Expires: 12-28-06

Signature *[Signature]*

Resident of Porter County

Printed Brenda Schover, Notary Public

000385

This instrument prepared by **Thomas K. Hoffman #7731-45, Crown Point, Indiana, Attorney at Law**

"OFFICIAL SEAL"
Brenda Sohovich
Notary Public, State of Indiana
Resident of Porter County
My Commission Expires 12-28-2006

MAIL TO: 123 E Pine Griffith IN 46319

①

