

2

STATE OF INDIANA
LAKE COUNTY
FILED FOR RECORD

2004 094505

2004 NOV -4 PM 3:25

MORRIS W. CARTER
RECORDER

QUITCLAIM DEED

THIS QUITCLAIM DEED, Executed this 26th day of OCTOBER, 2004
(year), by first party, Grantor, EMERSON HOUSING, LP/GARY URBAN ENTERPRISE ASSOCIATION
whose post office address is, 825 South Lake Street, Gary, Indiana 46403
to second party, Grantee, Urban Development Group, Inc.
whose post office address is 825 South Lake Street, Gary, Indiana 46403

WITNESSETH, That the said first party, for good consideration and for the sum
of ONE Dollars (\$ 1.00) paid by the said second party, the receipt
whereof is hereby acknowledged, does hereby remise, release and quitclaim unto the said
second party forever, all the right, title, interest and claim which the said first party has in
and to the following described parcel of land, and improvements and appurtenances
thereto in the County of Lake, State of Indiana to wit:

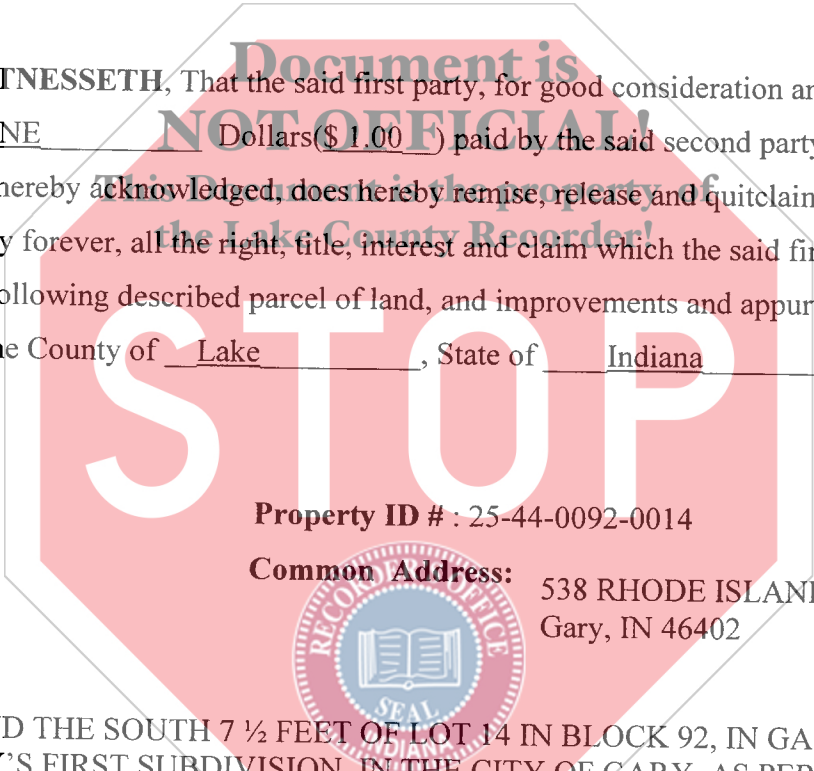

Property ID # : 25-44-0092-0014

Common Address: 538 RHODE ISLAND STREET
Gary, IN 46402

LOT 15 AND THE SOUTH 7 ½ FEET OF LOT 14 IN BLOCK 92, IN GARY LAND
COMPANY'S FIRST SUBDIVISION, IN THE CITY OF GARY, AS PER PLAT
THEREOF, RECORDED IN PLAT BOOK 6 PAGE 15, IN THE OFFICE OF THE
RECORDER OF LAKE COUNTY, INDIANA .

DULY ENTERED FOR TAXATION SUBJECT TO
FINAL ACCEPTANCE FOR TRANSFER

NOV 4 2004

STEPHEN R. STIGLICH
LAKE COUNTY AUDITOR

000440

16
108/10

IN WITNESS WHEREOF, The said first party has signed and sealed these presents the day and year first above written. Signed, sealed and delivered in presence of:

Brandi Bullock
Signature of Witness

J. Lynn Meeks
Signature of First Party

Brandi Bullock
Print name of Witness

J. Lynn Meeks
Print name of First Party

Signature of Witness

Signature of First Party

Print name of Witness

Print name of First Party

State of Indiana

County of Lake

On October 26, 2014 before me,
appeared Brandi Bullock & J. Lynn Meeks

personally known to me (or proved to me on the basis of satisfactory evidence) to be the person(s) whose name(s) is/are subscribed to the within instrument and acknowledged to me that he/she/they executed the same in his/her/their authorized capacity(ies), and that by his/her/their signature(s) on the instrument the person(s), or the entity upon behalf of which the person(s) acted, executed the instrument.

WITNESS my hand and official seal.

Charmaine Pratchett
Signature of Notary

Affiant _____ Known Produced ID _____
Type of ID Indiana
(Seal)

State of _____

County of _____

On _____ before me,
appeared _____

personally known to me (or proved to me on the basis of satisfactory evidence) to be the person(s) whose name(s) is/are subscribed to the within instrument and acknowledged to me that he/she/they executed the same in his/her/their authorized capacity(ies), and that by his/her/their signature(s) on the instrument the person(s), or the entity upon behalf of which the person(s) acted, executed the instrument.

WITNESS my hand and official seal.

Signature of Notary

Affiant _____ Known _____ Produced ID _____
Type of ID _____
(Seal)

Signature of Preparer

Print Name of Preparer

Address of Preparer

