

2

STATE OF INDIANA
LAKE COUNTY
FILED FOR RECORD

2004 094147

2004 NOV -4 AM 11:10

MORRIS W. CARTER
RECORDER

A298-10
R298-04

QUITCLAIM DEED

THIS QUITCLAIM DEED, Executed this 4th day of Nov. 2004 (year),

by first party, Grantor, *LUECENDIA BROWN*

whose post office address is *BROWN (995 CLINTON ST) GARY, IN*

to second party, Grantee, *VENESSA STEELE*

whose post office address is *995 CLINTON ST, GARY IN 46406*

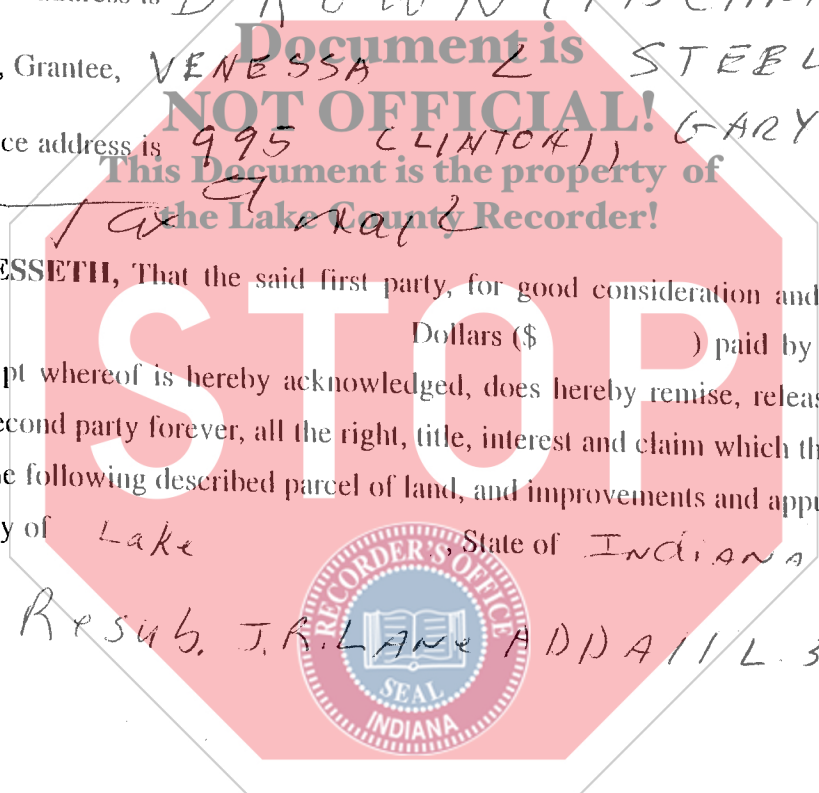

WITNESSETH, That the said first party, for good consideration and for the sum of _____ Dollars (\$) paid by the said second party, the receipt whereof is hereby acknowledged, does hereby remise, release and quitclaim unto the said second party forever, all the right, title, interest and claim which the said first party has in and to the following described parcel of land, and improvements and appurtenances there- to in the County of *Lake* State of *Indiana* to wit:

King's Resub. J.R. LANE ADDA 11 L. 30 TO 32 BL. 3

ONLY ENTERED FOR TAXATION SUBJECT TO
FINAL ACCEPTANCE FOR TRANSFER

NOV 4 2004

STEPHEN R. STIGLICH
LAKE COUNTY AUDITOR (1)

Key # 45-218-31

000418

Rev. 4/99

If your state requires 8 1/2" x 11" forms, cut off the bottom of this page at the dotted line.



*16-
CS DG*

IN WITNESS WHEREOF, The said first party has signed and sealed these presents the day and year first above written. Signed, sealed and delivered in presence of:

Signature of Witness

X LUECENDIA BROWN
Signature of First Party

Print name of Witness

Luecendia Brown
Print name of First Party

Signature of Witness

Vanessa Steele
Signature of First Party

Print name of Witness

VANESSA Steele
Print name of First Party

State of Indiana

County of Lake

On 4th Nov-2004 before me, Lonnie P Carter

appeared LUECENDIA BROWN

personally known to me (or proved to me on the basis of satisfactory evidence) to be the person(s) whose name(s) is/are subscribed to the within instrument and acknowledged to me that he/she/they executed the same in his/her/their authorized capacity(ies), and that by his/her/their signature(s) on the instrument the person(s), or the entity upon behalf of which the person(s) acted, executed the instrument.

WITNESS my hand and official seal.

Lonnie P Carter
Signature of Notary

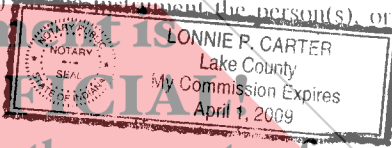

Document is NOT OFFICIAL
This Document is the property of the Lake County Recorder!

Alfiant _____ Known _____ Produced ID _____
Type of ID DRIVER (Seal)

State of _____

County of _____

On _____

appeared _____

personally known to me (or proved to me on the basis of satisfactory evidence) to be the person(s) whose name(s) is/are subscribed to the within instrument and acknowledged to me that he/she/they executed the same in his/her/their authorized capacity(ies), and that by his/her/their signature(s) on the instrument the person(s), or the entity upon behalf of which the person(s) acted, executed the instrument.

WITNESS my hand and official seal.

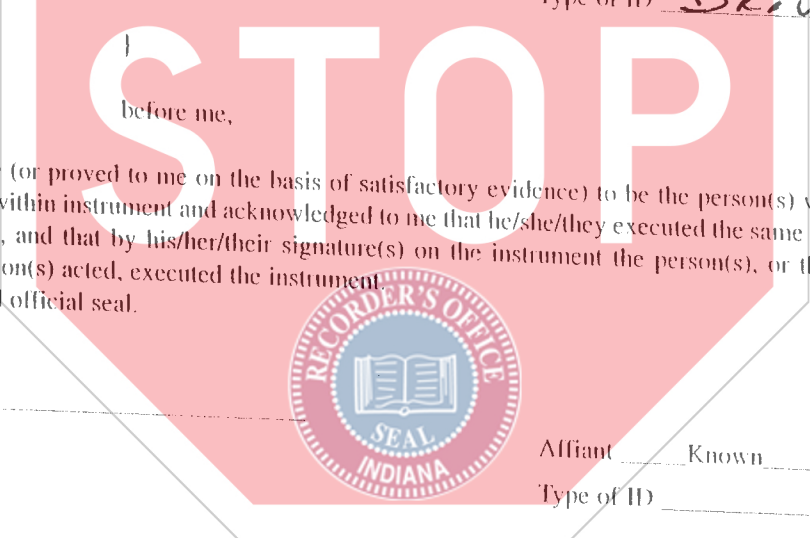

Signature of Notary

Alfiant _____ Known _____ Produced ID _____
Type of ID _____ (Seal)

Signature of Preparer

Print Name of Preparer

Address of Preparer