

2004 093903

2004 NOV -3 PM 2:25

MORRIS W. CARTER
RECORDER

**SWORN STATEMENT OF INTENTION TO HOLD LIEN
(NOTICE OF MECHANIC'S LIEN)**

TO: **CMS/SUMMERWOOD RETAIL VENTURE, LLC; CMS/SUMMER WOOD APARTMENTS, L.P.;
PENNINGTON I-HUSMAN LIMITED PARTNERSHIP, HOBBY PLACE I - HUSMAN LIMITED
PARTNERSHIP; and POINT I - HUSMAN LIMITED PARTNERSHIP**
ADDRESS: c/o Comprehensive Management Services, Inc., 1996 South Kirk Road, Suite 320, Geneva, IL 60134

STATE OF INDIANA, COUNTY OF LAKE, SS:

The undersigned, being first duly sworn, makes this sworn statement of intention to hold a lien upon the property described below and says that:

1. The undersigned, **GWE Painting, Inc. by its President, Julie A. Keene**, of 2307 Four Seasons Parkway, Crown Point, IN 46307, intends to hold a lien on land commonly known as Summerwood Apartments, 8101 Polo Club Drive, Merrillville, Indiana, and legally described as follows:

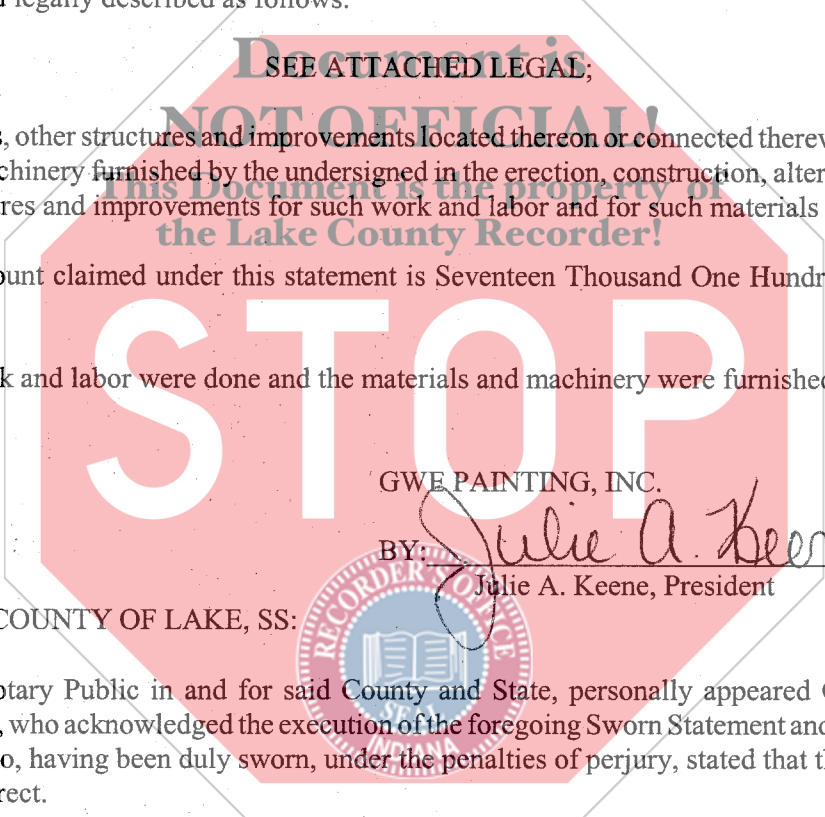

SEE ATTACHED LEGAL;

as well as on all buildings, other structures and improvements located thereon or connected therewith for work and labor done and for materials and machinery furnished by the undersigned in the erection, construction, altering, repairing and removing of said buildings, structures and improvements for such work and labor and for such materials and machinery.

2. The amount claimed under this statement is Seventeen Thousand One Hundred Twenty-two and 79/100 Dollars (\$17,599.79).

3. The work and labor were done and the materials and machinery were furnished by the undersigned within the last sixty days.

GWE PAINTING, INC.

BY: Julie A. Keene

Julie A. Keene, President

STATE OF INDIANA, COUNTY OF LAKE, SS:

Before me, a Notary Public in and for said County and State, personally appeared GWE Painting, Inc., by its President, Julie A. Keene, who acknowledged the execution of the foregoing Sworn Statement and Notice of Intention to Hold Mechanic's Lien, and who, having been duly sworn, under the penalties of perjury, stated that the facts and matters therein set forth are true and correct.

WITNESS my hand and Notarial Seal this 3rd day of November, 2004.

My Commission Expires
04-03-2009
Resident of Lake County

Sandra L. Schinkel
Notary Public (Signature)
Sandra L. Schinkel
Notary Public (Printed Name)

I hereby certify that I have this _____ day of November, 2004 mailed a duplicate of this notice, first-class, postage prepaid, to the within named property owner at c/o Comprehensive Management Services, Inc., 1996 South Kirk Road, Suite 320, Geneva, IL 60134. Recorder of LAKE County

THIS INSTRUMENT PREPARED BY: **ROBERT L. MEINZER, JR. #9132-45
MEINZER & BABINEAUX, Attorneys at Law
9190 Wicker Avenue, P.O. Box 111, St. John, IN 46373-0111
Tel: (219) 365-4321 Fax: 365-9510**

17.00
CS
EP

Parcel 1: Part of the Amended Final Plat of Polo Club Apartments, a Planned Unit Development in the Town of Merrillville, as recorded in Plat Book 77 page 41, in the Office of the Recorder of Lake County, Indiana, more particularly described as follows: Beginning at the Northwest corner of said Polo Club Apartments, said point being on a line that is 40 feet South of and parallel to the South right of way line of U.S. Highway No. 30; thence South 89 degrees 08 minutes 15 seconds East, along the boundary line of said Polo Club Apartments, a distance of 37.00 feet; thence South 00 degrees 02 minutes 41 seconds West a distance of 1,054.03 feet to the point of curve; thence Southeasterly along a curve concave to the East and having a radius of 191.50 feet, an arc distance of 100.42 feet, to the point of tangent of said curve (the chord of said curve bears South 14 degrees 58 minutes 39 seconds East, a distance of 99.27 feet); thence South 30 degrees 00 minutes 00 seconds East a distance of 206.44 feet; thence North 89 degrees 36 minutes 49 seconds West a distance of 166.09 feet; thence North 00 degrees 02 minutes 41 seconds East, along the boundary line of said Polo Club Apartments, a distance of 1,328.14 feet to the point of beginning, all in the Town of Merrillville, Lake County, Indiana.

Parcel 2: Part of the Amended Final Plat of Polo Club Apartments, a Planned Unit Development in the Town of Merrillville, as recorded in Plat Book 77, page 41, in the Office of the Recorder of Lake County, Indiana, more particularly described as follows: Commencing at the Northwest corner of said Polo Club Apartments, said point being on a line that is 40 feet South of and parallel to the South right of way line of U.S. Highway 30; thence South 89 degrees 08 minutes 15 seconds East, along the boundary line of said Polo Club Apartments, a distance of 220.02 feet; thence South 00 degrees 02 minutes 41 seconds West, along the boundary line of said Polo Club Apartments, a distance of 363.31 feet to the point of beginning; thence continue South 00 degrees 02 minutes 41 seconds West, along the boundary line of said Polo Club Apartments, a distance of 963.00 feet; thence North 89 degrees 36 minutes 49 seconds West a distance of 53.91 feet; thence North 30 degrees 00 minutes 00 seconds West a distance of 206.44 feet to a point of curve; thence Northwesterly, along a curve concave to the East and having a radius of 191.50 feet, an arc distance of 100.42 feet to the point of tangent of said curve (the chord of said curve bears North 14 degrees 58 minutes 39 seconds West, a distance of 99.27 feet); thence North 00 degrees 02 minutes 41 seconds East, a distance of 629.52 feet; thence North 90 degrees 00 minutes 00 seconds East a distance of 48.28 feet; thence North 60 degrees 00 minutes 00 seconds East a distance of 49.66 feet; thence North 00 degrees 00 minutes 00 seconds East, a distance of 33.61 feet; thence North 90 degrees 00 minutes 00 seconds East, a distance of 91.76 feet to the point of beginning, all in the Town of Merrillville, Lake County, Indiana.

Parcel 6: Part of the Amended Final Site Plan of the Polo Club Apartments, a Planned Unit Development in the Town of Merrillville, as recorded in Plat Book 77, page 41, in the Office of the Recorder of Lake County, Indiana, more particularly described as follows: Commencing at the Northwest corner of said Polo Club Apartments, said point being on a line that is 40 feet South of and parallel to the South right of way line of U.S. Highway No. 30; thence South 89 degrees 08 minutes 15 seconds East, a distance of 37.00 feet to the point of beginning; thence South 00 degrees 02 minutes 41 seconds West, a distance of 424.51 feet to the Northwest corner of Parcel "2"; thence North 90 degrees 00 minutes 00 seconds East, a distance of 48.28 feet; thence North 60 degrees 00 minutes 00 seconds East, a distance of 49.66 feet; thence North 00 degrees 00 minutes 00 seconds East, a distance of 33.61 feet; thence North 90 degrees 00 minutes 00 seconds East, a distance of 91.76 feet to the Northeast corner of Parcel "2"; thence North 00 degrees 02 minutes 41 seconds East, a distance of 363.31 feet to the Northeast corner of Polo Club Apartments; thence South 89 degrees 08 minutes 15 seconds West, a distance of 183.02 feet to the point of beginning, all in the Town of Merrillville, Lake County, Indiana.



15-669-9

Parcel 3: Part of the Amended Final Plat of Polo Club Apartments, a Planned Unit Development in the Town of Merrillville, as recorded in Plat Book 77 page 41, in the Office of the Recorder of Lake County, Indiana, more particularly described as follows: Commencing at the Northwest corner of said Polo Club Apartments, said point being on a line that is 40 feet South of and parallel to the South right of way line of U.S. Highway No. 30; thence South 89 degrees 08 minutes 15 seconds East, along the boundary line of said Polo Club Apartments, a distance of 220.02 feet; thence South 00 degrees 02 minutes 41 seconds West, along the boundary line of said Polo Club Apartments, a distance of 1,326.31 feet to the point of beginning; thence continue South 00 degrees 02 minutes 41 seconds West, along the boundary line of said Polo Club Apartments, a distance of 360.07 feet; thence South 89 degrees 40 minutes 00 seconds East, along the boundary line of said Polo Club Apartments, a distance of 0.37 feet; thence South 00 degrees 00 minutes 00 seconds East, a distance of 257.54 feet; thence North 90 degrees 00 minutes 00 seconds West, a distance of 234.27 feet; thence South 5 degrees 00 minutes 00 seconds West a distance of 285.95 feet; thence North 45 degrees 00 minutes 00 seconds West a distance of 44.58 feet; thence North 90 degrees 00 minutes 00 seconds West, a distance of 186.24 feet to a point on the boundary line of said Polo Club Apartments; thence North 00 degrees 03 minutes 30 seconds East, along the boundary line of said Polo Club Apartments, a distance of 792.69 feet; thence South 89 degrees 36 minutes 49 seconds East, along the boundary line of said Polo Club Apartments and said boundary line extended East, a distance of 653.34 feet to the point of beginning, all in the Town of Merrillville, Lake County, Indiana.

Parcel 4: Part of the Amended Final Plat of Polo Club Apartments, a Planned Unit Development, in the Town of Merrillville, as recorded in Plat Book 77, page 41, in the Office of the Recorder of Lake County, Indiana, more particularly described as follows: Commencing at the northwest corner of said Polo Club Apartments, said point being on a line that is 40 feet South of and parallel to the South right of way line of U.S. Highway No. 30; thence South 00 degrees 02 minutes 41 seconds West, along the boundary line of said Polo Club Apartments, a distance of 1,328.14 feet; thence North 89 degrees 36 minutes 49 seconds West, along the boundary line of said Polo Club Apartments, a distance of 433.34 feet; thence South 0 degrees 03 minutes 30 seconds West, along the boundary line of said Polo Club Apartments, a distance of 792.69 feet to the point of beginning; thence North 90 degrees 00 minutes 00 seconds East a distance of 186.24 feet; thence South 45 degrees 00 minutes 00 seconds East a distance of 44.58 feet; thence North 45 degrees 00 minutes 00 seconds East a distance of 285.95 feet; thence North 90 degrees 00 minutes 00 seconds East a distance of 234.27 feet; thence South 00 degrees 00 minutes 00 seconds East a distance of 541.92 feet; thence North 90 degrees 00 minutes 00 seconds West a distance of 654.60 feet; thence North 00 degrees 03 minutes 30 seconds West, along the boundary line of said Polo Club Apartments and said line extended South a distance of 371.25 feet to the point of beginning, all in the Town of Merrillville, Lake County, Indiana.

Parcel 5: Part of the Amended Final Plat of Polo Club Apartments, a Planned Unit Development in the Town of Merrillville, as recorded in Plat Book 77, page 41, in the Office of the Recorder of Lake County, Indiana, more particularly described as follows: Commencing at the Southwest corner of said Polo Club Apartments; thence North 00 degrees 05 minutes 30 seconds West, along the boundary line of said Polo Club Apartments, a distance of 120.01 feet; thence South 89 degrees 40 minutes 00 seconds East, along the boundary line of said Polo Club Apartments, a distance of 92.00 feet to the point of beginning; thence North 00 degrees 05 minutes 30 seconds West, along the boundary line of said Polo Club Apartments, a distance of 550.00 feet; thence South 89 degrees 40 minutes 00 seconds East, along the boundary line of said Polo Club Apartments, a distance of 492.48 feet; thence South 00 degrees 03 minutes 30 seconds West, a distance of 39.59 feet; thence South 90 degrees 00 minutes 00 seconds East, a distance of 654.60 feet; thence South 00 degrees 00 minutes 00 seconds West, a distance of 443.93 feet; thence North 90 degrees 00 minutes 00 seconds West, a distance of 48.00 feet; thence North 00 degrees 00 minutes 00 seconds East, a distance of 266.72 feet; thence North 90 degrees 00 minutes 00 seconds West a distance of 197.58 feet; thence South 00 degrees 00 minutes 00 seconds East, a distance of

①



122.79 feet; thence North 90 degrees 00 minutes 00 seconds West, a distance of 450.28 feet; thence South 00 degrees 00 minutes 00 seconds East, a distance of 330.17 feet to a point on the South boundary line of said Polo Club Apartments; thence North 89 degrees 40 minutes 00 seconds West, along the South boundary line of said Polo Club Apartments, a distance of 450.10 feet; thence North 00 degrees 05 minutes 30 seconds West a distance of 120.01 feet to the point of beginning, all in Merrillville, Lake County, Indiana.

Parcel 7: Part of the Amended Final Plat of Polo Club Apartments, a Planned Unit Development in the Town of Merrillville, as recorded in Plat Book 77, page 41, in the Office of the Recorder of Lake County, Indiana, more particularly described as follows:

9

The West 92 feet of the following described tract, to-wit: Part of the Northeast Quarter of Section 29, Township 35 North, Range 8 West of the 2nd Principal Meridian, described as follows: Commencing at the Northeast corner of said Section 29, thence North 89 degrees 40 minutes 00 seconds West along the North line of said Section 29 a distance of 681.02 feet to the point of beginning; thence South 0 degrees 02 minutes 41 seconds West, 210.0 feet; thence North 89 degrees 40 minutes 00 seconds West, 170.0 feet; thence South 0 degrees 02 minutes 41 seconds West, 460.0 feet to the South line of the North 670 feet of said Section 29; thence North 89 degrees 40 minutes 00 seconds West parallel with the North line of said Section 29 a distance of 1,066.48 feet; thence North 0 degrees 05 minutes 50 seconds West parallel with the West line of the Northeast Quarter of said Section 29 a distance of 120.01 feet; thence South 89 degrees 40 minutes 00 seconds East parallel with the North line of said Section 29 a distance of 92.0 feet; thence North 0 degrees 05 minutes 30 seconds West parallel with the West line of the Northeast Quarter of said Section 29 a distance of 550.0 feet to the North line of said Section 29; thence South 89 degrees 40 minutes 00 seconds East along the North line of said Section 29 a distance of 1,145.08 feet to the point of beginning, all in the Town of Merrillville, Lake County, Indiana.

10

Parcel 8: Part of the Amended Final Plat of Polo Club Apartments, a Planned Unit Development in the Town of Merrillville, as recorded in Plat Book 77, page 41, in the Office of the Recorder of Lake County, Indiana, more particularly described as follows: Commencing at the Southwest corner of said Polo Club Apartments; thence South 89 degrees 40 minutes 00 seconds East, along the South line of said Polo Club Apartments, a distance of 542.10 feet to the point of beginning; thence North 00 degrees 00 minutes 00 seconds East, a distance of 330.17 feet; thence North 90 degrees 00 minutes 00 seconds East, a distance of 450.28 feet; thence North 00 degrees 00 minutes 00 seconds East, a distance of 122.79 feet; thence North 90 degrees 00 minutes 00 seconds East, a distance of 197.58 feet; thence South 00 degrees 00 minutes 00 seconds East, a distance of 266.72 feet; thence North 90 degrees 00 minutes 00 seconds East, 24.00 feet; thence South 00 degrees 00 minutes 00 seconds East, a distance of 190.15 feet to the South line of said Polo Club Apartments; thence North 89 degrees 40 minutes 00 seconds West, along said South line, a distance of 671.67 feet to the point of beginning, all in the Town of Merrillville, Lake County, Indiana.

Parcel 9: Part of the Amended Final Plat of Polo Club Apartments, a Planned Unit Development in the Town of Merrillville, as per plat thereof, recorded in Plat Book 77 page 41, in the Office of the Recorder of Lake County, Indiana, more particularly described as follows: Commencing at the Southwest corner of said Polo Club Apartments; thence South 89 degrees 40 minutes 00 seconds East, along the South line of said Polo Club Apartments, a distance of 1,213.97 feet to the point of beginning; thence North 00 degrees 00 minutes 00 seconds East, a distance of 190.15 feet; thence North 90 degrees 00 minutes 00 seconds East, a distance of 24.00 feet; thence South 00 degrees 00 minutes 00 seconds West, a distance of 190.29 feet; thence North 89 degrees 40 minutes 00 seconds West, along said South line of said Polo Club Apartments, a distance of 24.00 feet to the point of beginning.

