

2

STATE OF INDIANA
LAKE COUNTY
FILED FOR RECORD

2004 081540

2004 SEP 22 AM 10:30

WARRANTY DEED

MORRIS W. CARTER
RECORDER

THIS INDENTURE WITNESSETH, That WILLIAM J. MAGER, GRANTORS of LAKE County in the State of INDIANA, CONVEYS AND WARRANTS to CHARLOTTE OELBERG of LAKE County in the State of INDIANA, as GRANTEES in consideration of One Dollar (\$1.00) and other valuable consideration, the receipt and sufficiency of which are hereby acknowledged, the following described real estate in LAKE County, in the State of Indiana:

PARCEL 1: THE EAST 44 FEET OF LOT NO. THREE (3), IN BLOCK NO. FOUR (4), AS MARKED AND LAID DOWN ON THE RECORDED PLAT OF HOLZWORTH'S ADDITION TO THE TOWN OF ROSS, IN LAKE COUNTY, INDIANA, AS THE SAME APPEARS OF RECORD IN BOOK "A", PAGE 482 IN THE RECORDER'S OFFICE OF LAKE COUNTY, INDIANA, TOGETHER WITH ALL IMPROVEMENTS THEREON AND APPURTENANCES THEREUNTO BELONGING.

Tax No. 01-39-0159-0003, No. 01-39-0023-0018

PARCEL 2: THE EAST 44 FEET OF THAT TRACT OF LAND OF THE

SEE REVERSE SIDE HEREOF FOR CONTINUATION OF LEGAL DESCRIPTION

COMMONLY KNOW AS: 3340 W. 47TH AVENUE, GARY, IN. 46408

SUBJECT TO SPECIAL, 2003 TAXES PAYABLE 2004, 2004 TAXES PAYABLE 2005, AND ALL REAL ESTATE TAXES DUE AND PAYABLE HEREAFTER.

SUBJECT TO EASEMENTS, RESTRICTIONS AND COVENANTS OF RECORD, IF ANY.

Dated this 17 day of September, 2004.

William J. Mager
WILLIAM J. MAGER

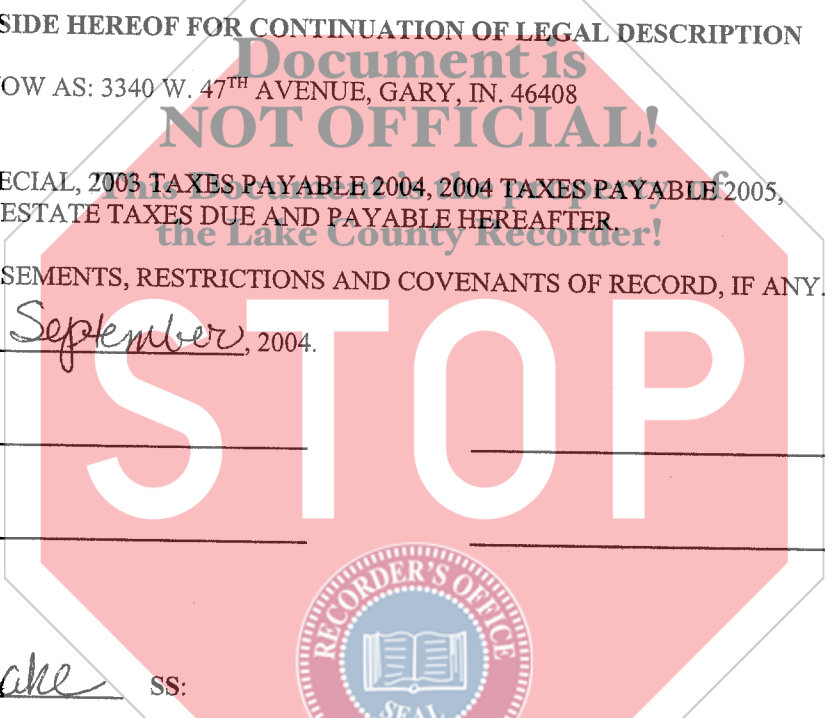

STATE OF INDIANA
COUNTY OF Lake SS:

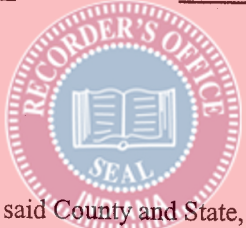

Before me, the undersigned, a Notary Public in and for said County and State, this 17 day of September, 2004, personally appeared: WILLIAM J. MAGER, and acknowledged the execution of the foregoing deed. In witness whereof, I have hereunto subscribed my name and affixed my official seal.

My commission expires: 5/9/09
Resident of Lake County

Signature
Printed

Elizabeth R. Kinzie
ELIZABETH R. KINZIE
NOTARY PUBLIC, Lake County, Indiana
My Commission Expires May 18, 2009
Resident of Gary, Indiana
SEP 22 2004
ONLY ENTERED FOR TAXATION SUBJECT TO FINAL ACCEPTANCE FOR TRANSFER
Notary Public

STEPHEN R. STIGLICH
LAKE COUNTY AUDITOR

This instrument prepared by PATRICK J. McMANAMA, Attorney at Law, No legal opinion given to Grantor. All information used in preparation of Document was supplied by title company.

Return Deed To : CHARLOTTE OELBERG
Send Tax Bills To: CHARLOTTE OELBERG

3340 West 47th Avenue
Gary, In. 46408

001797

COMMUNITY TITLE COMPANY
FILE NO L 29589
CASH

16-DC
cm

**Document is
NOT OFFICIAL!**

**This Document is the property of
the Lake County Recorder!**

STOP



NORTHEAST QUARTER OF THE NORTHEAST QUARTER OF SECTION 31,
TOWNSHIP 36 NORTH, RANGE 8 WEST OF THE 2ND P.M. BEING MORE
PARTICULARLY DESCRIBED AS FOLLOWS: BEGINNING AT THE NORTHWEST
CORNER OF LOT 3, BLOCK 4, IN HOLZWORTH'S ADDITION TO THE TOWN OF
ROSS; THENCE DUE NORTH 167 FEET, MORE OR LESS, TO THE SOUTH
LINE OF THE TIGHT OF WAY OF JOLIET AND NORTHERN INDIANA
RAILROAD; THENCE NORTHEASTERLY ALONG THE SOUTH LINE OF SAID
RIGHT OF WAY 126 1/2 FEET, MORE OR LESS, TO A POINT DUE NORTH
OF THE NORTHEAST CORNER OF LOT 3, BLOCK 4 IN HOLZWORTH'S
ADDITION TO THE TOWN OF ROSS; THENCE DUE SOUTH 205 FEET, MORE
OR LESS, TO THE NORTHEAST CORNER OF LOT 3, BLOCK 4 IN
HOLZWORTH'S ADDITION TO THE TOWN OF ROSS; THENCE DUE WEST ALONG
THE NORTH LINE OF SAID LOT TO THE PLACE OF BEGINNING, IN LAKE
COUNTY, INDIANA TOGETHER WITH ALL IMPROVEMENTS THEREON AND
APPURTENANCES THEREUNTO BELONGING.