

3
RELEASE OF
MORTGAGE
OR TRUST DEED

2004 080221

STATE OF INDIANA
LAKE COUNTY
FILED FOR RECORD

2004 SEP 20 AM 9:37

MORRIS V. CARTER
RECORDER

FOR THE PROTECTION OF THE OWNER, THIS RELEASE SHALL BE FILED WITH THE RECORDER OF DEEDS OR THE REGISTRAR OF TITLES IN WHOSE OFFICE THE MORTGAGE OR DEED OR TRUST WAS FILED.

KNOW ALL MEN BY THESE PRESENTS, that First National Bank of Joliet n/k/a Harris Bank Joliet, N.A., 78 N. Chicago St., Joliet, IL 60432 of the County of WILL and State of ILLINOIS, for and in consideration of the payment of the indebtedness secured by the Mortgage hereinafter mentioned, and the cancellation of all the notes thereby secured, and of the sum of one dollar, the receipt whereof is hereby acknowledged, does hereby REMISE, RELEASE, CONVEY and QUIT CLAIM unto Ervin Brandau, A Married Person, heirs, legal representatives and assigns, all the right, title, interest, claim or demand whatsoever that they may have acquired in, through or by a certain Mortgage bearing date the 13th day of November, 2000, and recorded in the Recorders Office of Lake County, in the State of Indiana, as document number 2000083856, to the premises therein described as follows, situated in the County of Lake, State of Indiana to wit:

REFER TO EXHIBIT "A" WHICH IS ATTACHED HERETO AND MADE A PART HEREOF.

together with all appurtenances and privileges thereunto belonging and appertaining.

PERMANENT INDEX NUMBER:

COMMON ADDRESS: 75.21 Acres, Cedar Lake, IN.

WITNESS OUR hands, this 11th day of December, 2003.

HARRIS BANK

BY:

Jane Krogh
JANE KROGH, COLLATERAL MANAGER

ATTEST

BY:

Lisa Turner
LISA TURNER, COLLATERAL MANAGER

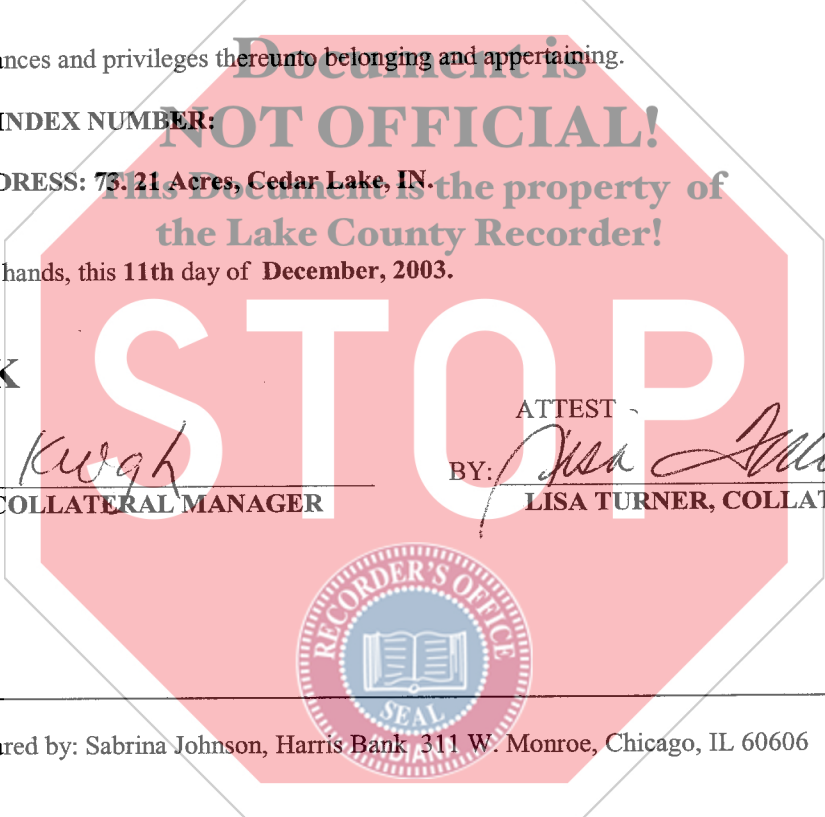

This instrument was prepared by: Sabrina Johnson, Harris Bank 311 W. Monroe, Chicago, IL 60606

Ervin Brandau Brandau
15230 Calfax Joliet 46356

H.O. AS JP

STATE OF ILLINOIS

COUNTY OF COOK

} SS.

I, THE UNDERSIGNED, a notary public in and for said County, in the State aforesaid, DO HEREBY CERTIFY that **JANE C. KROGH**, personally known to me to be the **COLLATERAL MANAGER** and **LISA TURNER**, personally known to me to be the **COLLATERAL MANAGER** of Harris Bank and personally known to me to be the same persons whose names are subscribed to the foregoing instrument, appeared before me this day in person and acknowledged that they signed and delivered the said instrument as their free and voluntary act, for the uses and purposes therein set forth.

GIVEN under my hand and notarial seal this 11th day of December, 2003.

Kathleen Espinosa
NOTARY PUBLIC



MAIL TO:
Ervin Brandau
Anna M. Terry Brandau
15230 Colfax St.
Lowell, IN. 46356-1044



EXHIBIT "A"

A parcel of land being in the Southwest Quarter of the Northwest Quarter and the Northwest Quarter of the Southwest Quarter of Fractional Section 1, Township 33 North, Range 10 West of the Second Principal Meridian, in Lake County, Indiana and being more particularly described as follows: Commencing at the Northwest corner of said Section 1; thence along the West line of said Section 1 South 01 degrees 21 minutes 05 seconds West a distance of 1384.84 feet to the Northwest corner of the Southwest Quarter of the Northwest Quarter of said Section 1 said corner also being the point of beginning; thence along the North line of the Southwest Quarter of the Northwest Quarter of said Section 1 South 88 degrees 57 minutes 47 seconds East a distance of 1173.63 feet to the Northeast corner of the Southwest Quarter of the Northwest Quarter of said Section 1; thence along the East line of the Southwest Quarter of the Northwest Quarter of said Section 1 South 00 degrees 00 minutes 17 seconds West a distance of 1324.32 feet to the Southeast corner of the Southwest Quarter of the Northwest Quarter of said Section 1; thence along the East line of the Northwest Quarter of the Southwest Quarter of said Section 1 South 00 degrees 00 minutes 17 seconds West a distance of 1324.38 feet to the Southeast corner of the Northwest Quarter of the Southwest Quarter of said Section 1; thence along the South line of the Northwest Quarter of the Southwest Quarter of said Section 1 North 88 degrees 49 minutes 38 seconds West a distance of 1235.87 feet to the Southwest corner of the Northwest Quarter of the Southwest Quarter of said Section 1; thence along the West line of the Northwest Quarter of the Southwest Quarter of said Section 1 North 01 degrees 21 minutes 05 seconds East a distance of 1322.69 feet to the Northwest corner of the Northwest Quarter of the Southwest Quarter of said Section 1; thence along the West line of the Southwest Quarter of the Northwest Quarter of said Section 1 North 01 degrees 21 minutes 05 seconds East a distance of 1322.69 feet to the point of beginning.

