

2

STATE OF INDIANA
LAKE COUNTY
FILED FOR RECORD

2004 050406

2004 JUN 16 PM 12:41

MORRIS W. CARTER
RECORDER

A298-10
R298-04

QUITCLAIM DEED

THIS QUITCLAIM DEED, Executed this 8th day of June, 2004 (year),

by first party, Grantor, Tommie and Georgia Davis, Husband and Wife

whose post office address is Lake County, Indiana

to second party, Grantee, Kia K. Thomas

whose post office address is Lake County, Indiana

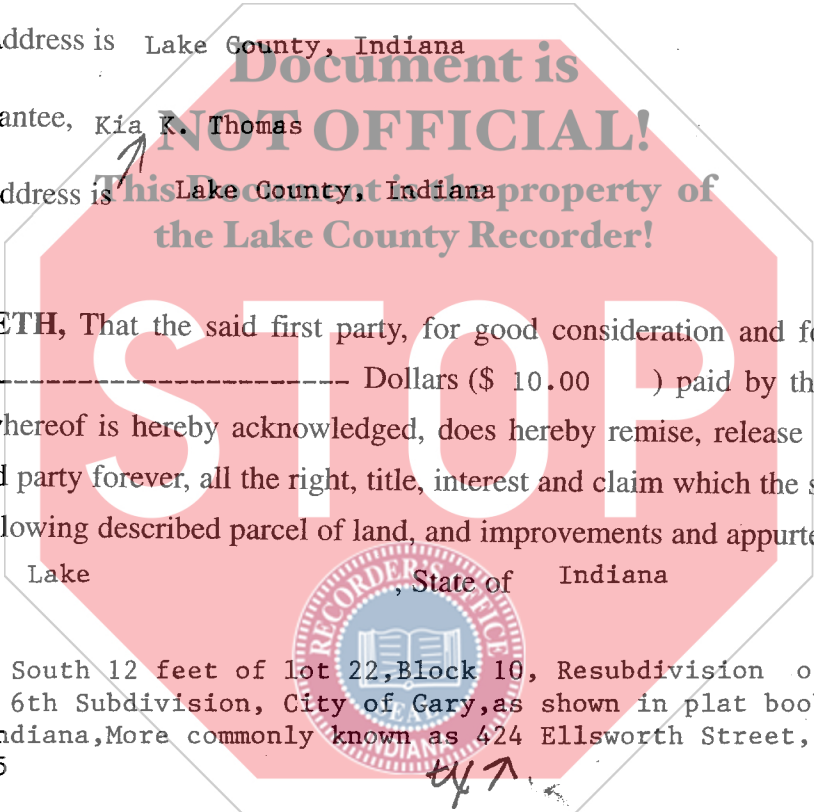

WITNESSETH, That the said first party, for good consideration and for the sum of

Ten----- Dollars (\$ 10.00) paid by the said second

party, the receipt whereof is hereby acknowledged, does hereby remise, release and quitclaim unto the said second party forever, all the right, title, interest and claim which the said first party has in and to the following described parcel of land, and improvements and appurtenances there- to in the County of Lake, State of Indiana to wit:

Lot 21 and the South 12 feet of lot 22, Block 10, Resubdivision of Gary Land Company's 6th Subdivision, City of Gary, as shown in plat book 14, page 21 Lake County, Indiana, More commonly known as 424 Ellsworth Street, Gary, Indiana Key #44-225-25

(1)

© 1992-2000 E-Z Legal Forms, Inc.

ZBAA

Rev. 6/00

This product does not constitute the rendering of legal advice or services. This product is intended for informational use only and is not a substitute for legal advice. State laws vary, so consult an attorney on all legal matters. This product was not necessarily prepared by a person licensed to practice law in this state.

If your state requires 8 1/2" x 11" forms, cut off the bottom of this page at the dotted line.

DULY ENTERED FOR TAXATION SUBJECT TO
FINAL ACCEPTANCE FOR TRANSFER

JUN 16 2004

STEPHEN R. STIGLICH
LAKE COUNTY AUDITOR

001334

16095

IN WITNESS WHEREOF, The said first party has signed and sealed these presents the day and year first above written. Signed, sealed and delivered in presence of:

Signature of Witness

Print name of Witness

Signature of Witness

Print name of Witness

Signature of First Party

Print name of First Party

Signature of First Party

Print name of First Party

Tommie Davis

Tommie Davis

Georgia O. Davis

Georgia O. Davis

State of *Indiana* }
County of *Lake*

On *June 14, 2004* before me, *Angela R. McDuffie*
appeared *Tommie Davis and Georgia Davis*

personally known to me (or proved to me on the basis of satisfactory evidence) to be the person(s) whose name(s) is/are subscribed to the within instrument and acknowledged to me that he/she/they executed the same in his/her/their authorized capacity(ies), and that by his/her/their signature(s) on the instrument the person(s), or the entity upon behalf of which the person(s) acted, executed the instrument.
WITNESS my hand and official seal.

Angela R. McDuffie
Signature of Notary *exp. date 9-20-2010*

Affiant _____ Known Produced ID
Type of ID *State Drivers Lic.*
(Seal)

State of _____ }
County of _____
On _____
appeared _____

personally known to me (or proved to me on the basis of satisfactory evidence) to be the person(s) whose name(s) is/are subscribed to the within instrument and acknowledged to me that he/she/they executed the same in his/her/their authorized capacity(ies), and that by his/her/their signature(s) on the instrument the person(s), or the entity upon behalf of which the person(s) acted, executed the instrument.
WITNESS my hand and official seal.

Signature of Notary

Affiant _____ Known _____ Produced ID
Type of ID _____
(Seal)

Signature of Preparer

Print Name of Preparer

Address of Preparer

(2)

If your state requires 8 1/2" x 11" forms, cut off the bottom of this page at the dotted line.