

2



QUITCLAIM DEED

2004 050003

Tax Key # 16-27-0637-0095

THIS INDENTURE WITNESSETH, That ELIZABETH M. DORKIN

_____ ("Grantor") of Lake County in the State of Indiana

QUITCLAIM (S) to Elizabeth M. Dorkin and Louise G. O'Keefe as tenants in common.

_____ of Lake County in the State of Indiana for the sum of

Ten Dollars and 00/00 Dollars (\$ 10.00 and

valuable consideration, the receipt of which is hereby acknowledged, the following described real estate in Lake County, Indiana:

See attached Legal Description

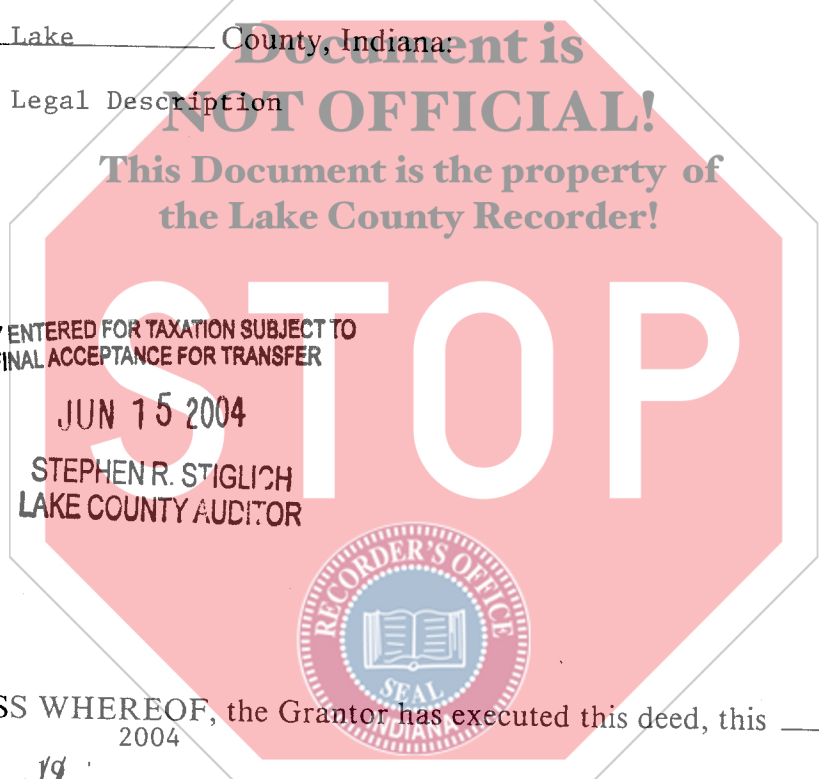

2004 JUN 15 PM 2:07
LAKE COUNTY INDIANA
FILED FOR RECORD
MORRIS V. CAMPBELL
RECORDER

IN WITNESS WHEREOF, the Grantor has executed this deed, this 14th day of April, 2004

Signature Elizabeth M. Dorkin
Printed Elizabeth M. Dorkin

Signature _____
Printed _____

Signature _____
Printed _____

Signature _____
Printed _____

STATE OF IN
COUNTY OF Lake SS

Before me, a Notary Public in and for said County and State, personally appeared Elizabeth M. Dorkin

_____, who acknowledged the execution of the foregoing Quitclaim Deed, and who, having been duly sworn, stated that any representations therein contained are true.

Witness my hand and Notarial Seal this 14th day of April, 14 2004

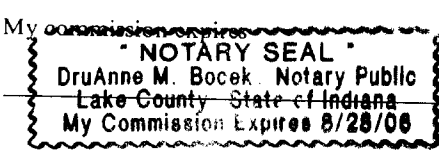

Signature DruAnne M Bocek

Printed _____, Notary Public

Residing in _____ County, Indiana.

This instrument was prepared by E. Dorkin

17
00
001261 CASH

- LEGAL DESCRIPTION -

GRANTEE: JOHN L. DORKIN SR. & ELIZABETH M. DORKIN
PARCEL NO: 16-27-0637-0095

PARCEL 3

THAT PART OF BLOCK 5 IN PARK PLACE, ADDITION TO THE TOWN OF HIGHLAND, LAKE COUNTY, INDIANA, RECORDED DECEMBER 12, 1997 AS DOCUMENT NUMBER 97062300, IN PLAT BOOK 83, PAGE 82 AND BY PLAT OF CORRECTION RECORDED MARCH 26, 1998 IN PLAT BOOK 84, PAGE 34, PLAT BOOK 84 PAG 34, AND FFURTHER AMENDED BY 2ND PLAT OF CORRECTION RECORDED IN PLAT BOOK 85 PAGE 61 AS DOCUMENT NUMBER 98020433, IN THE OFFICE OF THE RECORDER OF LAKE COUNTY, INDIANA, THE WSEST 20 FEET OF THAT PART OF BLOCK 5 LYING EAST OF THE FOLLOWING DESCRIBED LINE:

COMMENCING AT THE POINT OF CURVE IN BLOCK 5, SAID POINT BEING ON THE NORTH LINE OF BLOCK 5, AND 13.42 FEET WEST OF THE NORTHERLY PROJECTION OF THE EAST TANGENT LINE OF SAID BLOCK 5; THENCE NORTH 86 DEGREES 45 MINUTES WEST ON THE NORTH LINE OF BLOCK 5, A DISTANCE OF 60.45 FEET TO THE POINT OF BEGINNING AND THE NORTHWEST CORNER OF PARCEL THREE; THENCE SOUTH 03 DEGREES 15 MINUTES WEST, A DISTANCE OF --20 FEET TO THE SOUTH LINE OF BLOCK 5 AND THE SOUTHWEST CORNER OF PARCEL THREE.

