

STATE OF INDIANA  
LAKE COUNTY  
FILED FOR RECORD

2004 049630

2004 JUN 15 AM 9:35

MORRIS W. CARTER  
RECORDER

**WARRANTY DEED**

**THIS INDENTURE WITNESSETH:** That **LARMI II CONSTRUCTION, INC.** of the State of Illinois, conveys and warrants to **JAMES R. COLBY and ANN MARIE COLBY, husband and wife**, of Lake County, in the State of Indiana, for and in consideration of Ten Dollars (\$10.00) and other good and valuable consideration, the receipt whereof is hereby acknowledged, the following described real estate in Lake County, in the State of Indiana, to-wit:

Key No. 13-756-3

Lot 24 in Autumn Creek, Block Nine, Phase Two, an Addition to the Town of Schererville, as per plat thereof, recorded in Plat Book 92 page 82, in the Office of the Recorder of Lake County, Indiana.

Current real estate taxes;  
Covenants, restrictions, and easements of record; and  
Highways and legal rights-of-ways, ditches and drained, if any, and all rights therein.

Send Tax Statements To: 7333 Dale Drive, Schererville, Indiana 46375

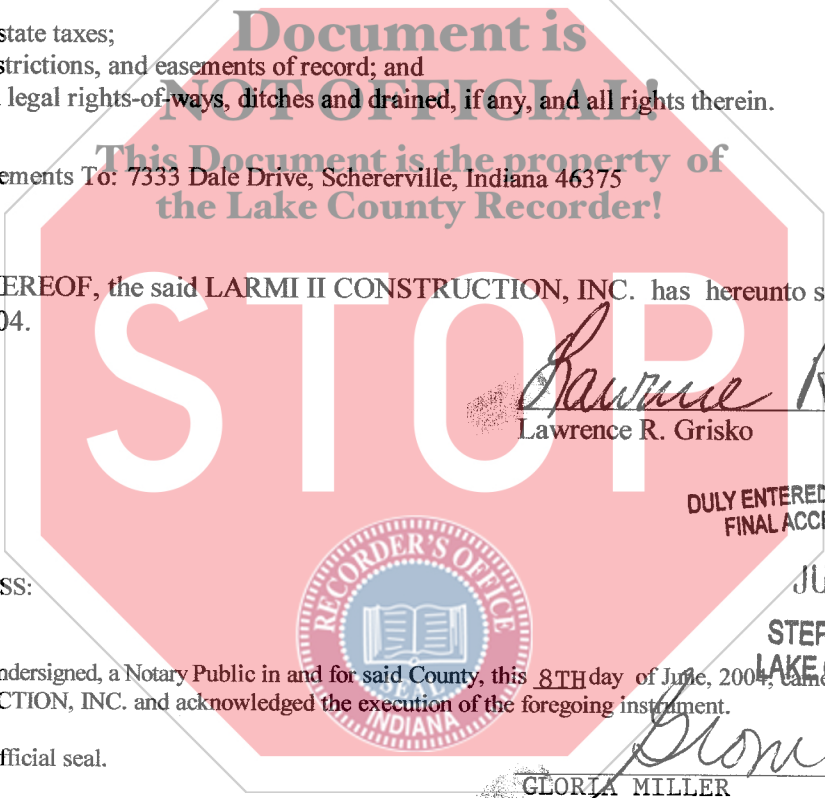

IN WITNESS WHEREOF, the said **LARMI II CONSTRUCTION, INC.** has hereunto set its hand and seal this 8TH day of June, 2004.

*Lawrence R. Grisko*  
Lawrence R. Grisko

DULY ENTERED FOR TAXATION SUBJECT TO  
FINAL ACCEPTANCE FOR TRANSFER

JUN 11 2004

STEPHEN R. STIGLICH  
LAKE COUNTY AUDITOR

STATE OF INDIANA )  
                                  ) SS:  
COUNTY OF LAKE )

Before me, the undersigned, a Notary Public in and for said County, this 8TH day of June, 2004, LAWRENCE R. GRISKO for **LARMI II CONSTRUCTION, INC.** and acknowledged the execution of the foregoing instrument.

WITNESS my hand and official seal.

*Gloria Miller*  
GLORIA MILLER, Notary Public

My Commission Expires: 10-29-08

Resident of LAKE County, Indiana

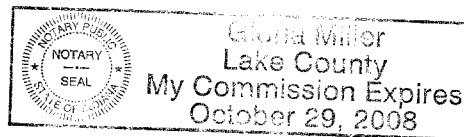

**TICOR TITLE INSURANCE**  
11055 BROADWAY SUITE A  
CROWN POINT, INDIANA 46307

This Instrument Prepared By: **D. Eric Neff, Attorney at Law,**  
270 North Main Street, Suite A, Crown Point, IN 46307

920043748

001048

14  
#56