

2004 049310

2004 JUN 11 AM 9:17

MORRIS W. CARTER
RECORDER

After Recording Return To:
COUNTRYWIDE HOME LOANS, INC.
MS SV-79 DOCUMENT PROCESSING
P.O.Box 10423
Van Nuys, CA 91410-0423

[Space Above This Line For Recording Data]

IN1517587492703
[Case #]

920042697
[Escrow/Closing #]

0006233799806004
[Doc ID #]

ASSIGNMENT OF MORTGAGE

KNOW ALL MEN BY THESE PRESENTS That

COUNTRYWIDE HOME LOANS, INC.
4500 Park Granada, Calabasas, CA 91302-1613
organized and existing under the laws of NEW YORK, party of the first part, for
value received, has granted, bargained, sold, assigned, transferred and set over, and by these presents does
grant, sell, assign, transfer and set over unto

U.S. BANK N.A.

organized and existing under the laws of OHIO, whose location and mailing
address (if different) is

17500 ROCKSIDE ROAD, BEDFORD, OH 44146

party of the second part, its successors and assigns, a certain indenture of mortgage dated
JUNE 7, 2004, made by

JAIME J ARREOLA - JOINT

to it, securing the payment of one promissory note therein described for the sum of
SIXTY EIGHT THOUSAND NINE HUNDRED EIGHTEEN and 00/100

Dollars (\$ 68,918.00), and all its rights, title and interest in and to the premises situated in the
county of LAKE, State of Indiana, and described in said
mortgage as follows, to-wit:

LOT 10, EXCEPT THE WEST 10 FEET THEREOF, AND THE WEST 8 FEET OF LOT 11 IN
BLOCK 2 IN BRIARGATE FIRST ADDITION TO THE CITY OF HAMMOND, AS SHOWN IN
PLAT BOOK 29 PAGE 102, IN THE OFFICE OF THE RECORDER OF LAKE COUNTY,
INDIANA.

2004-049309
ms

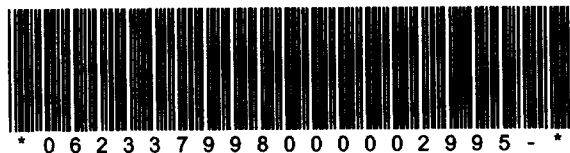
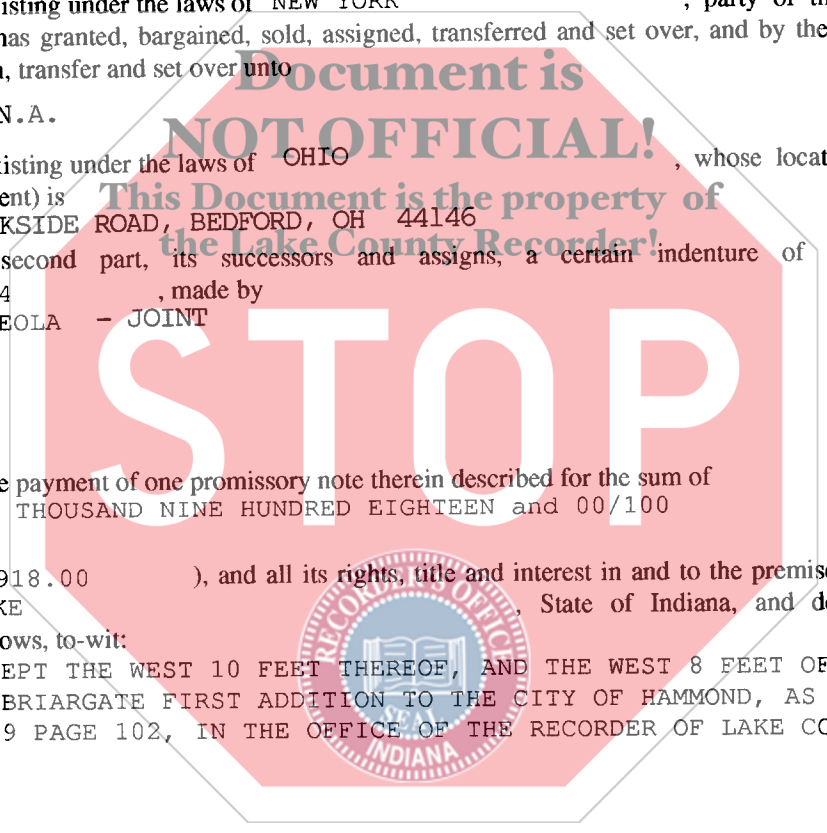

12-DC
TZ

CASE #: IN1517587492703

DOC ID #: 0006233799806004

which said mortgage is recorded in the office of the Recorder of

LAKE

County, in the State of Indiana, in Book No.

at Page

as Document No.

together with the said note therein described

and the money due or to grow due thereon, with the interest:

TO HAVE AND TO HOLD the same unto the said party of the second part, its successors and assigns, forever, subject only to the provisions in the said indenture of mortgage contained.

IN WITNESS WHEREOF, the party of the first part has caused this instrument to be executed in its name by VALERIE NEFF its ASSISTANT BRANCH MANAGER

, and attested by KELLY NEFF LOAN SPECIALIST II, its and its corporate seal to be hereunto affixed this

SEVENTH day of June, A.D. 2004.
ATTEST:

COUNTRYWIDE HOME LOANS, INC.

Valerie Neff
VALERIE NEFF, ASST BRANCH MANAGER
COUNTY OF LAKE
STATE OF INDIANA
By: *Kelly Neff*
KELLY NEFF, LOAN SPECIALIST II

On 6/4/04, before me

Kelly Neff

, personally appeared

, personally known to me (or proved to me on the basis of satisfactory evidence) to be the person(s) whose name(s) is/are subscribed to the within instrument and acknowledged to me that he/she/they executed the same in his/her/their authorized capacity(ies), and that by his/her/their signature(s) on the instrument the person(s), or the entity upon behalf of which the person(s) acted, executed the instrument.

WITNESS my hand and official seal.
Notary Public
Porter County, State of Indiana
My commission expires: June 5, 2011



[Signature] (Seal)

This form was prepared by: KELLY M. NEFF
COUNTRYWIDE HOME LOANS, INC.
address:

1525 US HIGHWAY 41 SUITE C-26, SCHERERVILLE, IN 46375
tel. no.: (219) 322-2802