

2

LAKE COUNTY
FILED FOR RECORD

2004 047611

2004 JUN 7 11 11 AM

MOBILE

A298-10
R298-04

QUITCLAIM DEED

THIS QUITCLAIM DEED, Executed this 25th day of May, 2004 (year),

by first party, Grantor, **ESSIE H. WILEY AKA ESSIE HENRY WILEY - CW**

whose post office address is 655 STATE STREET

to second party, Grantee, **CAROLYN R. WILEY Carolyn Rae Wiley - CW**

whose post office address is PO Box 923 East Chicago, IN 46312

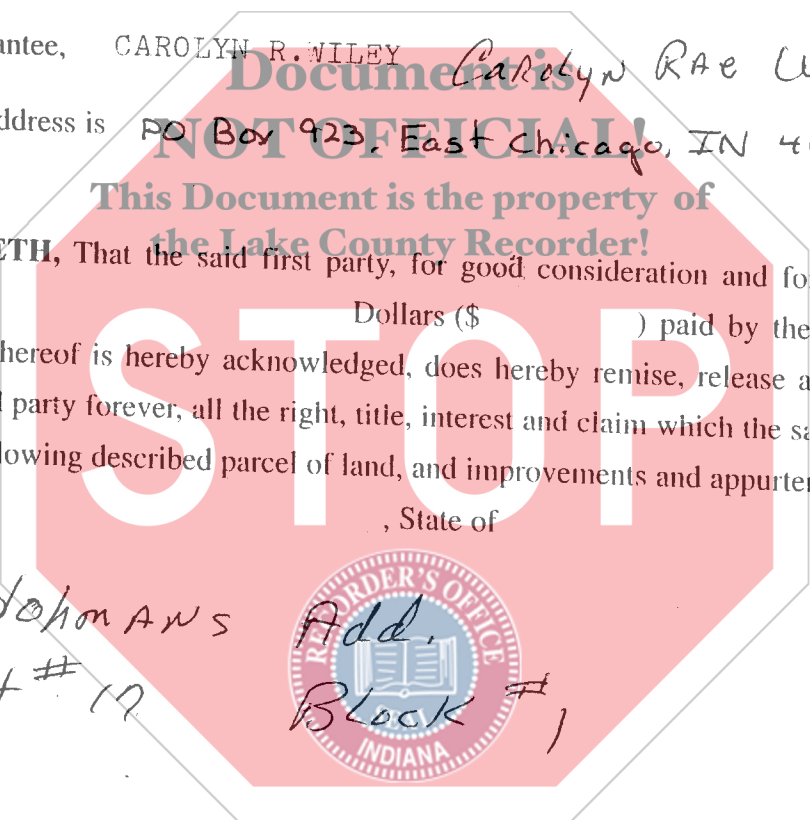

WITNESSETH, That the said first party, for good consideration and for the sum of Dollars (\$) paid by the said second

party, the receipt whereof is hereby acknowledged, does hereby remise, release and quitclaim unto the said second party forever, all the right, title, interest and claim which the said first party has in and to the following described parcel of land, and improvements and appurtenances there- to in the County of , State of to wit:

LE Hohmanns
Lot # 12

Add. Block # 1

AQAA (1)

Rev. 4/99

If your state requires 8 1/2" x 11" forms, cut off the bottom of this page at the dotted line.



DULY ENTERED FOR TAXATION SUBJECT TO
FINAL ACCEPTANCE FOR TRANSFER

JUN 7 2004

STEPHEN R STIGLICH
LAKE COUNTY CLERK

16-
CSDC

000585

IN WITNESS WHEREOF, The said first party has signed and sealed these presents the day and year first above written. Signed, sealed and delivered in presence of:

ESSIE H. WILEY
Signature of First Party
Essie H. Wiley
Print name of First Party
Signature of First Party
Essie H. Wiley
Print name of First Party
Signature of First Party
Essie H. Wiley
Print name of First Party

Margie Coulter
Signature of Witness
Margie Coulter
Print name of Witness
John Taylor
Signature of Witness
John Taylor
Print name of Witness

State of Indiana
County of Lake
On 08/20/18
before me, Jessica M. Gwert
appeared
Essie H. Wiley
personally known to me (or proved to me on the basis of satisfactory evidence) to be the person(s) whose name(s) is/are subscribed to the within instrument and acknowledged to me that he/she/they executed the same in his/her/their authorized capacity(ies), and that by his/her/their signature(s) on the instrument the person(s), or the entity upon behalf of which the person(s) acted, executed the instrument.
WITNESS my hand and official seal.



Signature of Notary
Type of ID IN DL
Affiant X Known Produced ID
(Seal)

Signature of Notary
Type of ID _____
Affiant _____ Known Produced ID
(Seal)

Signature of Preparer
Print Name of Preparer
Address of Preparer

