

Notary Public
Lake County, Indiana
Commission Expires 11/19/2010

2004 045503

2004 045503

100
100

Mail tax bills to:
351 E. 60TH DRIVE
MERRILLVILLE, IN 46410

Key No. 15-512-50

WARRANTY DEED

THIS INDENTURE WITNESSETH, That **ROUSSOS SAVVAS** ("Grantor") of Lake County in the State of Indiana CONVEY (S) AND WARRANT (S) TO **TRINIA L. BYNUM** ("Grantee") of Lake County in the State of Indiana in consideration of One Dollar and other valuable consideration, the receipt and sufficiency of which are hereby acknowledged, the following described real estate in Lake County, in the State of Indiana:

SEE ATTACHED SHEET FOR LEGAL DESCRIPTION

Subject to: Taxes for 2003 and subsequent years, building lines, covenants and restrictions.

Dated this 25th day of May, 2004.

NORTHWEST INDIANA TITLE SERVICES, INC
162 Washington Street
Lowell, Indiana 46356

Roussos Savvas
ROUSSOS SAVVAS

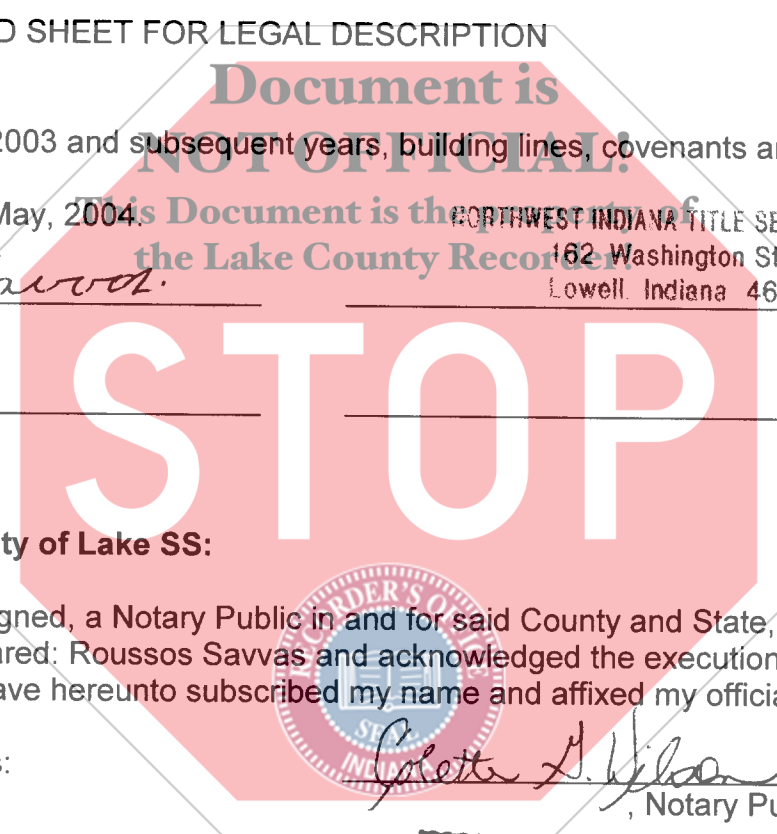

State of Indiana County of Lake SS:

Before me, the undersigned, a Notary Public in and for said County and State, this 25th day of May, 2004, personally appeared: Roussos Savvas and acknowledged the execution of the foregoing deed. In witness whereof, I have hereunto subscribed my name and affixed my official seal.

My commission expires:

Colette G. Wilson
Notary Public

Resident of

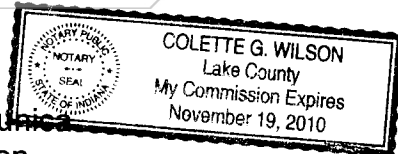

This instrument prepared by: Attorney Richard A. Zunic
162 Washington
Lowell, In 46356

File No. 04-13002

DULY ENTERED FOR TAXATION SUBJECT TO
FINAL ACCEPTANCE FOR TRANSFER

MAY 3 2004

STEPHEN R. STIGLICH
LAKE COUNTY CLERK

000289

16 DG
10674

Commonwealth Land Title

Commitment Number: 04-13002

**SCHEDULE C
PROPERTY DESCRIPTION**

The land referred to in this Commitment is described as follows:

PARCEL 14-2 BEING A PART OF PHASES "E" AND "F", LOT 1, OLD AIRPORT ADDITION, LAKE COUNTY, INDIANA, AS THE SAME APPEARS OF RECORD IN THE OFFICE OF LAKE COUNTY RECORDER IN PLAT BOOK 38, PAGE 99, MORE PARTICULARLY DESCRIBED AS COMMENCING AT THE SOUTHWEST CORNER OF SAID LOT 1; THENCE SOUTH 89 DEGREES 44 MINUTES 50 SECONDS EAST ALONG THE SOUTH LINE OF SAID LOT 1, A DISTANCE OF 134.67 FEET; THENCE NORTH 36 DEGREES 15 MINUTES 10 SECONDS EAST A DISTANCE OF 368.85 FEET; THENCE NORTH 53 DEGREES 44 MINUTES 50 SECONDS WEST A DISTANCE OF 19.0 FEET; THENCE NORTH 53 DEGREES 24 MINUTES 39 SECONDS WEST A DISTANCE OF 37.60 FEET TO THE PLACE OF BEGINNING; THENCE CONTINUING NORTH 53 DEGREES 24 MINUTES 39 SECONDS WEST A DISTANCE OF 30.32 FEET; THENCE NORTH 36 DEGREES 35 MINUTES 21 SECONDS EAST A DISTANCE OF 45.0 FEET; THENCE SOUTH 53 DEGREES 24 MINUTES 39 SECONDS EAST A DISTANCE OF 30.32 FEET; THENCE SOUTH 36 DEGREES 35 MINUTES 21 SECONDS WEST A DISTANCE OF 45.0 FEET, TO THE POINT OF BEGINNING.

