

Mail Tax Bills to:

5614 Aspen St.  
Portage In  
46368

Tax Key No.: 36-0322.  
0014. 26-  
Hammond

# WARRANTY DEED

1400LK04

**HOLD FOR MERIDIAN TITLE CORP**

This indenture witnesseth that MARY ANN HARTLERODE

of LAKE County in the State of FLORIDA

Conveys and warrants to SAMUEL BRUCE SPIVAK

of LAKE County in the State of INDIANA  
for and in consideration of Ten Dollars (\$10.00) and other valuable consideration  
the receipt whereof is hereby acknowledged, the following Real Estate in Lake County  
in the State of Indiana, to wit:

2004 045167

Lot No. 14 and the West 2 feet of Lot No. 13 as marked and laid down on the recorded plat of F. J. White's Addition to Hammond, in Lake County, Indiana,

Subject to: **This Document is the property of the Lake County Recorder!**

- a.) Real Estate Taxes now and hereafter a lien on the premises
- b.) Easements, restrictions and rights of way of record.

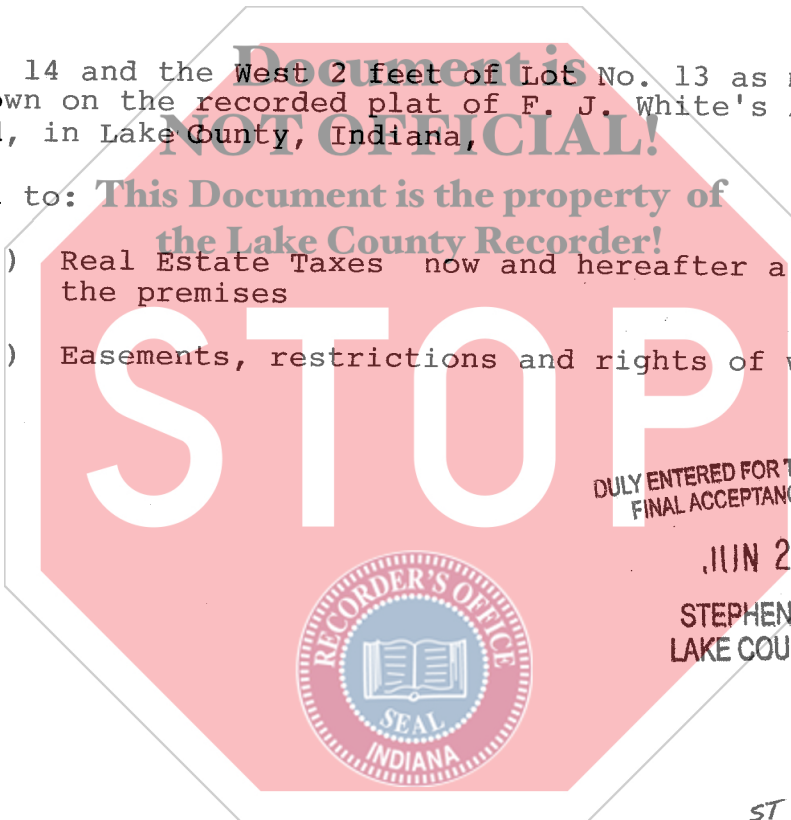

DULY ENTERED FOR TAXATION SUBJECT TO FINAL ACCEPTANCE FOR TRANSFER

JUN 2 2004

STEPHEN R. STIGLICH  
LAKE COUNTY AUDITOR

State of Florida LAKE County, ss:  
Before me, the undersigned, a Notary Public in and for said County and State, this 21<sup>st</sup> day of May 2004 personally appeared:

MARY ANN HARTLERODE

Dated this 21<sup>ST</sup> Day of MAY 2004

*Mary Ann Hartlerode*  
MARY ANN HARTLERODE

And acknowledged the execution of the foregoing deed. In witness whereof, I have hereunto subscribed my name and affixed my official seal. My Commission expires: March 18, 2007



Christina Barganier  
My Commission DD175236  
Expires March 18, 2007

*Christina Barganier*  
Notary Public

Resident of Lake County.

000158

This instrument prepared by DONALD STEPANOVICH, Attorney at Law Attorney No. 709-45.

Exempt 11

15-  
PT DG