

J

LAKE COUNTY  
FILED FOR RECORD

LF298-04

2004 045623

2004 JUN 1 11:14 AM

MOBILE RECORDER

# QUITCLAIM DEED

THIS QUITCLAIM DEED, executed this 1st day of June (year), 2004

by first party, Grantor, Marion R. Williams  
 whose post office address is P.O. Box 2690, Gary, IN 46403  
 to second party, Grantee, Doris J. Reed  
 whose post office address is 2216 East 19th Place, Gary, IN 46407

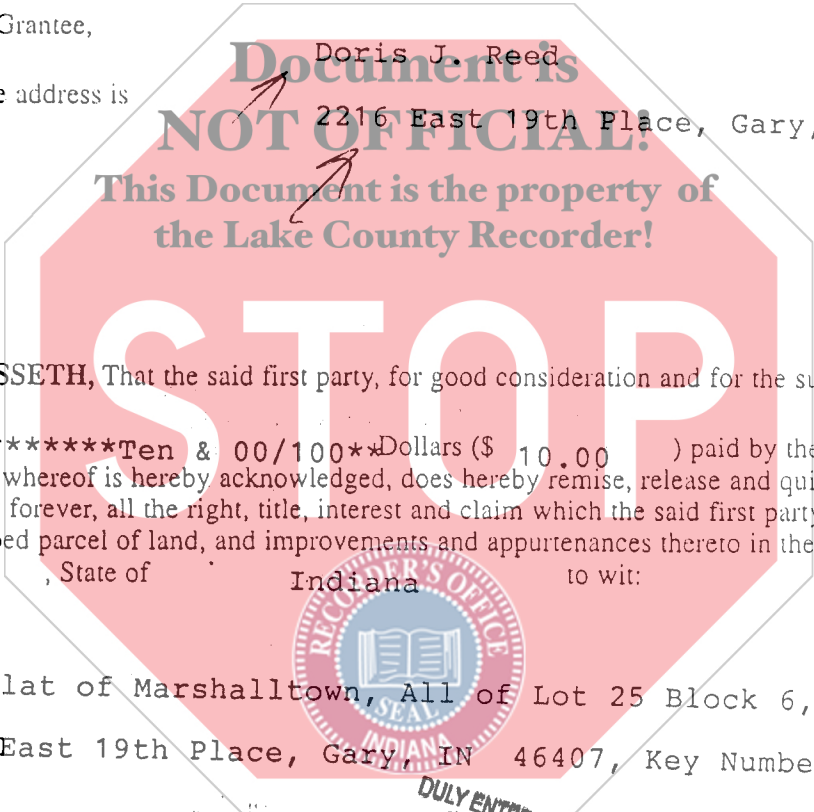

WITNESSETH, That the said first party, for good consideration and for the sum of

\*\*\*\*\*Ten & 00/100\*\*Dollars (\$ 10.00 ) paid by the said second party, the receipt whereof is hereby acknowledged, does hereby remise, release and quitclaim unto the said second party forever, all the right, title, interest and claim which the said first party has in and to the following described parcel of land, and improvements and appurtenances thereto in the County of Lake, State of Indiana to wit:

Corrected Plat of Marshalltown, All of Lot 25 Block 6, Commonly known as 2208-14 East 19th Place, Gary, IN 46407, Key Number 46-540-25

DULY ENTERED FOR TAXATION SUBJECT TO FINAL ACCEPTANCE FOR TRANSFER

JUN 7 2004  
 STEPHEN R. STIGELICH  
 LAKE COUNTY AUDITOR

16.00  
 @Sp  
 000094

IN WITNESS WHEREOF, The said first party has signed and sealed these presents the day and year first above written. Signed, sealed and delivered in presence of:

\_\_\_\_\_  
Signature of Witness

Marion R. Williams  
Signature of First Party

Marion R. Williams

\_\_\_\_\_  
Print name of Witness

\_\_\_\_\_  
Print name of First Party

\_\_\_\_\_  
Signature of Witness

\_\_\_\_\_  
Signature of First Party

\_\_\_\_\_  
Print name of Witness

\_\_\_\_\_  
Print name of First Party

State of Indiana  
County of Lake

On June 01, 2004 before me, Earlene D. Griffin  
appeared Marion R. Williams

personally known to me (or proved to me on the basis of satisfactory evidence) to be the person(s) whose name(s) is/are subscribed to the within instrument and acknowledged to me that he/she/they executed the same in his/her/their authorized capacity(ies), and that by his/her/their signature(s) on the instrument the person(s), or the entity upon behalf of which the person(s) acted, executed the instrument. WITNESS my hand and official seal.

Earlene D. Griffin  
Signature of Notary

**Document is NOT OFFICIAL!**  
**This Document is the property of the Lake County Recorder!**

Affiant  Known  Produced ID  
Type of ID Indiana DL (Seal)

State of  
County of  
On

before me,

appeared  
personally known to me (or proved to me on the basis of satisfactory evidence) to be the person(s) whose name(s) is/are subscribed to the within instrument and acknowledged to me that he/she/they executed the same in his/her/their authorized capacity(ies), and that by his/her/their signature(s) on the instrument the person(s), or the entity upon behalf of which the person(s) acted, executed the instrument. WITNESS my hand and official seal.

\_\_\_\_\_  
Signature of Notary



Affiant \_\_\_\_\_ Known \_\_\_\_\_ Produced ID  
Type of ID \_\_\_\_\_ (Seal)

\_\_\_\_\_  
Signature of Preparer

\_\_\_\_\_  
Print Name of Preparer

\_\_\_\_\_  
Address of Preparer