

A WARNING TO THE PARTIES TO A TRANSFER OF PROPERTY:

620310344cm

IT IS HIGHLY UNLIKELY THAT THE SINGLE ACT OF READING THIS DOCUMENT WOULD BE FOUND TO CONSTITUTE "ALL APPROPRIATE INQUIRY INTO THE PREVIOUS OWNERSHIP AND USES OF THE PROPERTY" SO AS TO PROTECT YOU AGAINST LIABILITY UNDER THE "INNOCENT PURCHASER" PROVISION OF THE FEDERAL COMPREHENSIVE ENVIRONMENTAL RESPONSE, COMPENSATION AND LIABILITY ACT, 42 U.S.C. § 9601(35)(B). YOU ARE STRONGLY ENCOURAGED NOT ONLY TO READ THIS DOCUMENT CAREFULLY, BUT ALSO TO TAKE ALL OTHER ACTIONS NECESSARY TO THE EXERCISE OF DUE DILIGENCE IN YOUR INQUIRY INTO THE PREVIOUS OWNERSHIP AND USES OF THE PROPERTY.

**ENVIRONMENTAL DISCLOSURE DOCUMENT FOR
TRANSFER OF REAL PROPERTY**

2004 041273

The following information is provided under IC 13-25-3 the Responsible Property Transfer Law

For Use By County Recorder's Office
County _____
Date _____
Doc. No. _____
Vol. _____
Page _____
Rec'd by: _____

Document is NOT OFFICIAL!

This Document is the property of the Lake County Recorder!

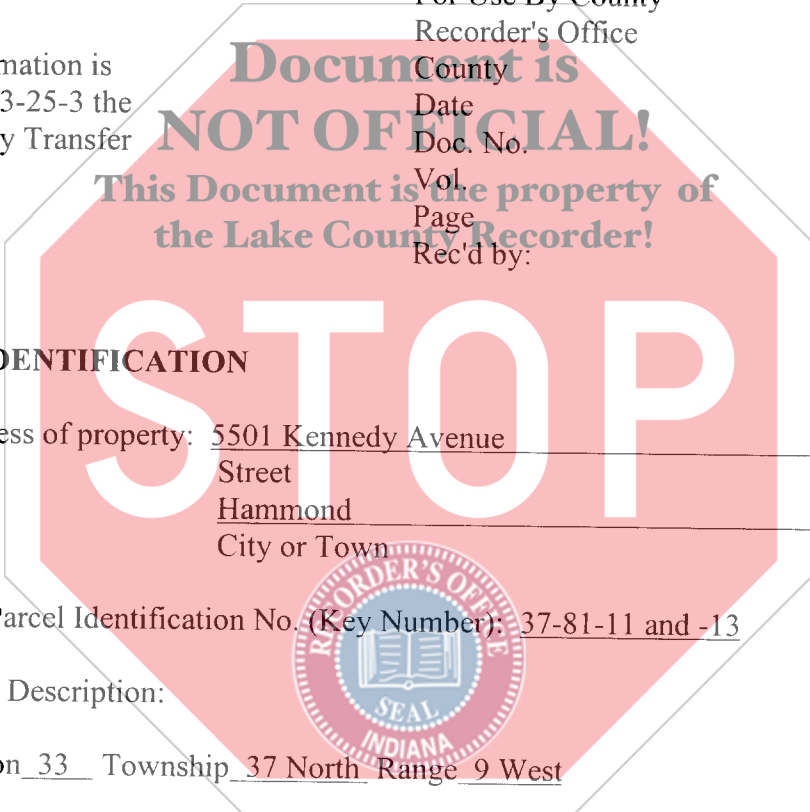

STATE OF INDIANA
LAKE COUNTY
FILED FOR RECORD
2004 MAY 19 AM 9:11
MORNING
REC'D

Chicago Title Insurance Company

I. PROPERTY IDENTIFICATION

A. Address of property: 5501 Kennedy Avenue
Street
Hammond
City or Town

Tax Parcel Identification No. (Key Number): 37-81-11 and -13

B. Legal Description:

Section 33 Township 37 North Range 9 West

Enter or attach complete legal description in this area:

See Exhibit "A" attached hereto

Record and Return to:
Donnamarie B. Hammet
Fidelity National Title Insurance Company
1500 Walnut Street, Suite #400
Philadelphia, Pennsylvania 19102

Handwritten initials/signature: *DS*

#03-2835(Resco)

LIABILITY DISCLOSURE

Transferors and transferees of real property are advised that their ownership or other control of such property may render them liable for environmental cleanup costs whether or not they caused or contributed to the presence of environmental problems in association with the property.

C. Property Characteristics:

Lot Size _____ Acreage 69.56 acres more or less

Check all types of improvement and uses that pertain to the property:

- _____ Apartment building (6 units or less)
- _____ Commercial apartment (over 6 units)
- _____ Store, office, commercial building
- X Industrial building
- _____ Farm, with buildings
- _____ Other (specify)

II. NATURE OF TRANSFER

		Yes	No
A. (1)	Is this a transfer by deed or other instrument of conveyance of fee title to property?	_____	<u> X </u>
(2)	Is this a transfer by assignment of over 25% of beneficial interest of a land trust?	_____	<u> X </u>
(3)	A lease exceeding a term of 40 years?	_____	<u> X </u>
(4)	A collateral assignment of beneficial interest	_____	<u> X </u>
(5)	An installment contract for the sale of property?	_____	<u> X </u>
(6)	A mortgage or trust deed	<u> X </u>	_____
(7)	A lease of any duration that includes an option to purchase?	_____	<u> X </u>

B. (1) Identify Transferor:

Resco Products, Inc., 2 Penn Center West, Suite 430, Pittsburgh, PA 15276
Name and Current Address of Transferor

Name and Address of Trustee if this is a transfer of beneficial interest of a land trust.
N/A

(2) Identify person who has completed this form on behalf of the Transferor and who has knowledge of the information contained in this form:

Name, Position (if any), and Address Telephone No.

Robert L. Williamson
Hammond Plant Manager
173w150s
Valparaiso, IN
46385

219-465-9263

C. Identify Transferee:

PNC Bank, National Association
Two PNC Plaza
620 Liberty Street
Pittsburgh, Pa. 15222

Name and Current Address of Transferee

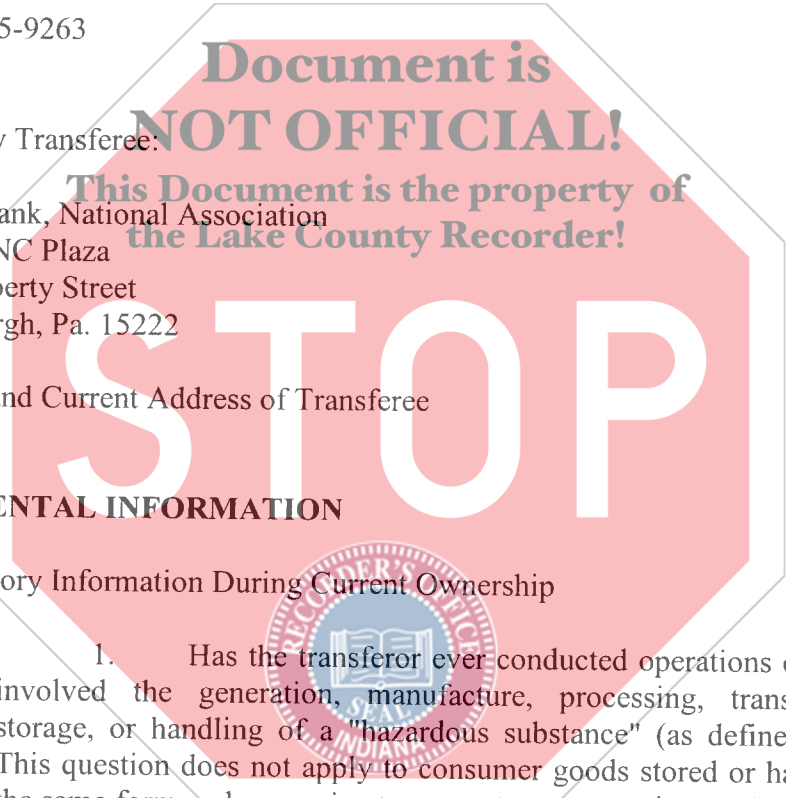

III. ENVIRONMENTAL INFORMATION

A. Regulatory Information During Current Ownership

1. Has the transferor ever conducted operations on the property which involved the generation, manufacture, processing, transportation, treatment, storage, or handling of a "hazardous substance" (as defined by IC 13-11-2.98)? This question does not apply to consumer goods stored or handled by a retailer in the same form and approximate amount, concentration, and manner as they are sold to consumers, unless the retailer has engaged in any commercial mixing (other than paint mixing or tinting of consumer sized containers), finishing, refinishing, servicing, or cleaning operations on the property.

Yes X No _____

2. Has the transferor ever conducted operations on the property which involved the processing, storage, or handling of petroleum, other than that which was associated directly with the transferor's vehicle usage?

Yes X No _____

3. Has the transferor ever conducted operations on the property which involved the generation, transportation, storage, treatment, or disposal of "hazardous waste" (as defined in IC 13-11-2-99(a))?

Yes X No _____

4. Are there any of the following specific units (operating or closed) at the property that are used or were used by the transferor to manage hazardous wastes, hazardous substances, or petroleum?

	YES	NO
Landfill	_____	<u> X </u>
Surface Impoundment	_____	<u> X </u>
Land Application	_____	<u> X </u>
Waste Pile	_____	<u> X </u>
Incinerator	_____	<u> X </u>
Storage Tank (Above Ground)	<u> X </u>	_____
Storage Tank (Underground)	_____	<u> X </u>
Container Storage Area	<u> X </u>	_____
Injection Wells	_____	<u> X </u>
Wastewater Treatment Units	_____	<u> X </u>
Septic Tanks	_____	<u> X </u>
Transfer Stations	_____	<u> X </u>
Waste Recycling Operations	_____	<u> X </u>
Waste Treatment Detoxification	_____	<u> X </u>
Other Land Disposal Area	_____	<u> X </u>

If there are "YES" answers to any of the above items and the transfer of property that requires the filing of this document is other than a mortgage or trust deed or collateral assignment of beneficial interest in a land trust, you must attach to the copies of this document that you file with the county recorder and the department of environmental management a site plan that identifies the location of each unit.

5. Has the transferor ever held any of the following in regard to this real property?

(A) Permits for discharges of wastewater to waters of Indiana.

Yes X
No _____

- (B) Permits for emissions to the atmosphere. Yes X
No _____
- (C) Permits for any waste storage, waste treatment, or waste disposal operation. Yes _____
No X
6. Has the transferor ever discharged any waste water (other than sewage) to a publicly owned treatment works? Yes _____
No X
7. Has the transferor been required to take any of the following actions relative to this property?
- (A) Filed an emergency and hazardous chemical inventory form pursuant to the federal Emergency Planning and Community Right-to-Know Act of 1986 (42 U.S.C.11022). Yes X
No _____
- (B) Filed a toxic chemical release form pursuant to the federal Emergency Planning and Community Right-to-Know Act of 1986 (42 U.S.C. 11023). Yes X
No _____
8. Has the transferor or any facility on the property or the property been the subject of any of the following state or federal governmental actions?
- (A) Written notification regarding known, suspected, or alleged contamination on or emanating from the property. Yes _____
No X
- (B) Filing an environmental enforcement case with a court or the solid waste management board for which a final order or consent decree was entered. Yes _____
No X
- (C) If the answer to question (B) was Yes, then indicate whether or not the final order or decree is still in effect for this property. Yes _____
No _____ N/A
9. Environmental Releases During Transferor's Ownership.
- (A) Has any situation occurred at this site which resulted in a reportable "release" of any hazardous substances or petroleum as required under state or federal laws? Yes _____
No X
- (B) Have any hazardous substances or petroleum which were released come into direct contact with the ground at this site? Yes _____
No X

If the answer to question (A) or (B) is Yes, have any of the following actions or events been associated with a release on the property?

_____ Use of a cleanup contractor to remove or treat materials including soils, pavement, or other surficial materials?

_____ Assignment of in-house maintenance staff to remove or treat materials including soils, pavement, or other surficial materials?

_____ Sampling and analysis of soils?

_____ Temporary or more long term monitoring of groundwater at or near the site?

N/A

_____ Impaired usage of an onsite or nearby water well because of offensive characteristics of the water?

_____ Coping with fumes from subsurface storm drains or inside basements?

_____ Signs of substances leaching out of the ground along the base of slopes or at other low points on or immediately adjacent to the site?

(C) Is there an environmental defect (as defined in IC 13-11-2-70) on the property that is not reported under question (A) or (B)?

Yes _____
No X

If the answer is Yes, describe the environmental defect:

N/A

10. Is the facility currently operating under a variance granted by the commissioner of the Indiana department of environmental management?
Yes _____ No X

11. Has the transferor ever conducted an activity on the site without obtaining a permit from the U.S. Environmental Protection Agency, the commissioner of the department of environmental management, or another administrative agency or authority with responsibility for the protection of the environment, when such a permit was required

by law?

Yes _____ No X

If the answer is Yes, describe the activity:

N/A

12. Is there any explanation needed for clarification of any of the above answers or responses?

NO

B. Site Information Under Other Ownership or Operation

1. Provide the following information about the previous owner or about any entity or person to whom the transferor leased the property or with whom the transferor contracted for the management of the property:

Name: Harbison-Walker Refractories Company

Type of business or property usage Fireproof refractory products and services

2. If the transferor has knowledge, indicate whether the following existed under prior ownerships, leaseholds granted by the transferor, or other contracts for management or use of the property:

	YES	NO
Landfill	<u>X</u>	_____
Surface Impoundment	_____	<u>X</u>
Land Application	_____	<u>X</u>
Waste Pile	_____	<u>X</u>
Incinerator	_____	<u>X</u>
Storage Tank (Above Ground)	<u>X</u>	_____
Storage Tank (Underground)	_____	<u>X</u>
Container Storage Area	<u>X</u>	_____
Injection Wells	_____	<u>X</u>
Wastewater Treatment Units	_____	<u>X</u>
Septic Tanks	_____	<u>X</u>
Transfer Stations	_____	<u>X</u>

Waste Recycling Operations
Waste Treatment Detoxification
Other Land Disposal Area

____ X
____ X
____ X

IV. CERTIFICATION

A. Based on my inquiry of those persons directly responsible for gathering the information, I certify that the information submitted is, to the best of my knowledge and belief, true and accurate.

RESCO PRODUCTS, INC.

By: Robert L. Willamsen
Name: Robert L. Willamsen
Title: PLANT MANAGER

TRANSFEROR

B. This form was delivered to me with all elements completed on ~~January~~ ^{February} 13, 2004

