

[Handwritten Signature]
2004 039594

STATE OF INDIANA
LAKE COUNTY
FILED FOR RECORD

2004 MAY 13 PM 3:09

MORRIS W. CARTER
RECORDER

QUITCLAIM DEED

THIS QUITCLAIM DEED, Executed this 11th day of MAY, 2004 (year),

by first party, Grantor, Northwest Indiana Commercial Industrial Investment, INC. (NICII) #1

whose post office address is 825 South Lake Street, Gary, Indiana 46403

to second party, Grantee, Gary Urban Enterprise Association

whose post office address is 825 South Lake Street, Gary, Indiana 46403

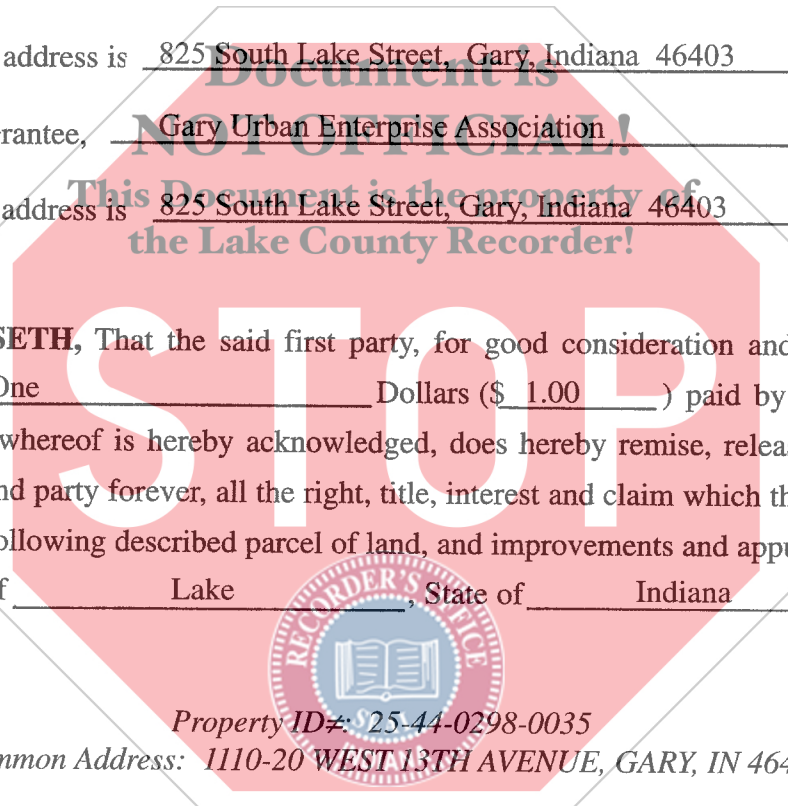

WITNESSETH, That the said first party, for good consideration and for the sum of One Dollars (\$ 1.00) paid by the said second party, the receipt whereof is hereby acknowledged, does hereby remise, release and quitclaim unto the said second party forever, all the right, title, interest and claim which the said first party has in and to the following described parcel of land, and improvements and appurtenances there- to in the County of Lake, State of Indiana to wit:

Property ID#: 25-44-0298-0035
Common Address: 1110-20 WEST 13TH AVENUE, GARY, IN 4640

LOTS 26 AND 27 IN BLOCK 6 IN GARY LAND COMPANY'S ELEVENTH SUBDIVISION IN THE CITY OF GARY, AS PER PLAT THEREOF, RECORDED IN PLAT BOOK 15 PAGE 25, IN THE OFFICE OF THE RECORDER OF LAKE COUNTY, INDIANA.

ABAA (1)

Rev. 4/99

If your state requires 8 1/2" x 11" forms, cut off the bottom of this page at the dotted line.

DULY ENTERED FOR TAXATION SUBJECT TO
FINAL ACCEPTANCE FOR TRANSFER

MAY 13 2004

STEPHEN R. STIGLICH
LAKE COUNTY AUDITOR

001680



[Handwritten]
161
10720

IN WITNESS WHEREOF, The said first party has signed and sealed these presents the day and year first above written. Signed, sealed and delivered in presence of:

Natalie Holmes
Signature of Witness

J. Lynn Meeks
Signature of First Party

Natalie Holmes
Print name of Witness

J. Lynn Meeks
Print name of First Party

Signature of Witness

Signature of First Party

Print name of Witness

Print name of First Party

State of Indiana

County of Lake

On 5/11/04 before me,

appeared Natalie Holmes + J. Lynn Meeks

personally known to me (or proved to me on the basis of satisfactory evidence) to be the person(s) whose name(s) is/are subscribed to the within instrument and acknowledged to me that he/she/they executed the same in his/her/their authorized capacity(ies), and that by his/her/their signature(s) on the instrument the person(s), or the entity upon behalf of which the person(s) acted, executed the instrument.

WITNESS my hand and official seal.

Charmaine Pratchett
Signature of Notary

Document is NOT OFFICIAL!
This Document is the property of the Lake County Recorder!
Affiant _____ Known Produced ID _____
Type of ID Indiana (Seal)

State of _____

County of _____

On _____ before me,

appeared

personally known to me (or proved to me on the basis of satisfactory evidence) to be the person(s) whose name(s) is/are subscribed to the within instrument and acknowledged to me that he/she/they executed the same in his/her/their authorized capacity(ies), and that by his/her/their signature(s) on the instrument the person(s), or the entity upon behalf of which the person(s) acted, executed the instrument.

WITNESS my hand and official seal.

Signature of Notary



Affiant _____ Known _____ Produced ID _____
Type of ID _____ (Seal)

Signature of Preparer

Print Name of Preparer

Address of Preparer