

2

STATE OF INDIANA
LAKE COUNTY
FILED FOR RECORD

2004 039589

2004 MAY 13 PM 3:09

MORRIS W. CARTER
RECORDER

QUITCLAIM DEED

THIS QUITCLAIM DEED, Executed this 11th day of MAY, 2004 (year),

by first party, Grantor, Northwest Indiana Commercial Industrial Investment, INC. (NICII)NH

whose post office address is 825 South Lake Street, Gary, Indiana 46403

to second party, Grantee, Gary Urban Enterprise Association

whose post office address is 825 South Lake Street, Gary, Indiana 46403

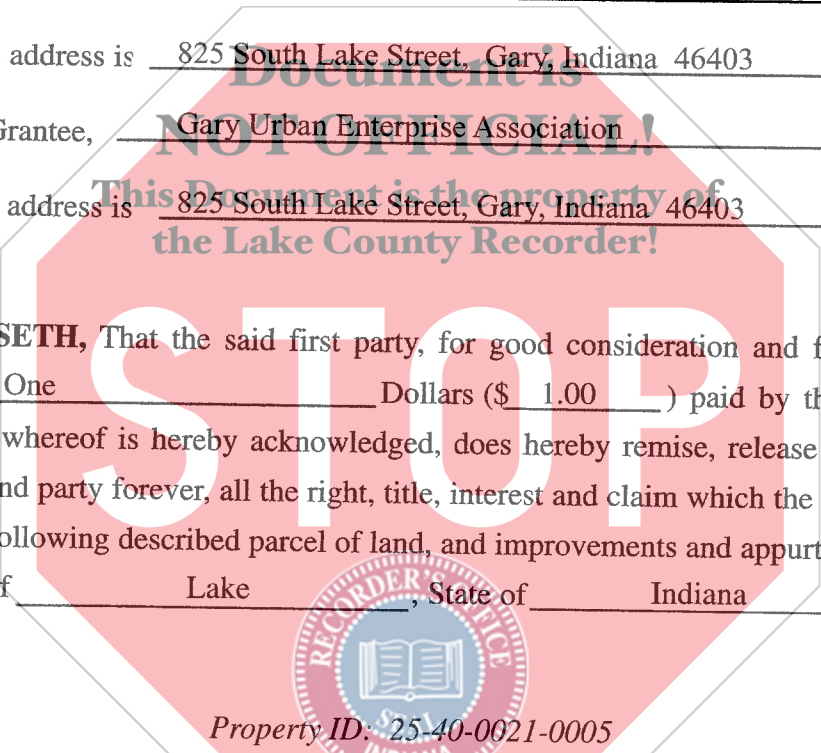

WITNESSETH, That the said first party, for good consideration and for the sum of One Dollars (\$ 1.00) paid by the said second party, the receipt whereof is hereby acknowledged, does hereby remise, release and quitclaim unto the said second party forever, all the right, title, interest and claim which the said first party has in and to the following described parcel of land, and improvements and appurtenances there- to in the County of Lake, State of Indiana to wit:

Property ID: 25-40-0021-0005

Common Address: 901 ALABAMA STREET, GARY, INDIANA 46402

COMMENCING AT ETH PT OF INTERSECTION OF THE NORTH LINE OF THE RIGHT OF WAY OF THE WABASH RAILROAD WITH THE WEST LINE OF SECTION 2, TOWNSHIP 36 NORTH, RANGE 8 WEST OF THE SECOND PRINCIPAL MERIDIAN, AND WHICH POINT IS 130.85 FT NORTH OF THE SOUTHWEST CORNER OF SAID SECTION 2 THENCE EAST ALONG THE NORTH RIGHT OF WAY LINE OF SAID WABASH RAILROAD FOR DISTANCE OF 972.89 FT.; THENCE IN A NORTHEASTERLY DIRECTON WITH A NE. AND ANGLE OF 49 DEGREES AND 64.3.2 FT. TO THE PT. OF CURVE; THENCE IN A NE. DIRECTION ON A CURVE CONVEX TO THE NW. AND WITH A RADIUS OF 477.68 FT. FOR A DISTEANCE OF 384.2 FT TO A POINT ON THE S. LINE OF A STREET; THENCE IN A NW DIRECTION ALONG THE S. LINE OF SAID STREET FOR A DISTANCE OF 987 FT. TO THE E. RIGHT OF WAY OF THE STREET BEING AT AN ANLE OF 69 DEGREES AND 45 MINUTES WITH THE LATST DESCRIBED TANGENT E. RIGHT OF WAY OF THE GARY AND WESTERN RAILWAY ON A CURVE CONVEX TO THE S. AND WITH A RADIUS OF 3,502FT. FOR A DISTANCE OF 1,191.93 FT. TO THE WEST LINE OF SECTION TWO FOR A DISTANCE FOR 1,191.93 FT TO THE WEST LINE OF SECTION 2; THENCE SOUTH ALONG THE WEST LINE OF SECTION 2 FOR A DISTANCE OF 119.28FT. TO THE PLACE OF BEGINNING; CONTAINING 19.936 ACRES.

ABAA (1)

Rev. 4/99

If your state requires 8 1/2" x 11" forms, cut off the bottom of this page at the dotted line.



DULY ENTERED FOR TAXATION SUBJECT TO
FINAL ACCEPTANCE FOR TRANSFER

MAY 13 2004

STEPHEN R. STIGLICH
LAKE COUNTY AUDITOR

001075

16-
DG
10720

IN WITNESS WHEREOF, The said first party has signed and sealed these presents the day and year first above written. Signed, sealed and delivered in presence of:

Natalie Holmes
Signature of Witness

Natalie Holmes
Print name of Witness

J. Lynn Meeks
Signature of First Party

J. Lynn Meeks
Print name of First Party

Signature of Witness

Print name of Witness

Signature of First Party

Print name of First Party

State of Indiana }
County of Lake

On 5/11/04 before me,

appeared Natalie Holmes & J. Lynn Meeks
personally known to me (or proved to me on the basis of satisfactory evidence) to be the person(s) whose name(s) is/are subscribed to the within instrument and acknowledged to me that he/she/they executed the same in his/her/their authorized capacity(ies), and that by his/her/their signature(s) on the instrument the person(s), or the entity upon behalf of which the person(s) acted, executed the instrument.
WITNESS my hand and official seal.

Charmaine Patchett
Signature of Notary

State of _____
County of _____
On _____ before me,
appeared

personally known to me (or proved to me on the basis of satisfactory evidence) to be the person(s) whose name(s) is/are subscribed to the within instrument and acknowledged to me that he/she/they executed the same in his/her/their authorized capacity(ies), and that by his/her/their signature(s) on the instrument the person(s), or the entity upon behalf of which the person(s) acted, executed the instrument.
WITNESS my hand and official seal.

Signature of Notary

Affiant _____ Known Produced ID _____
Type of ID Indiana (Seal)

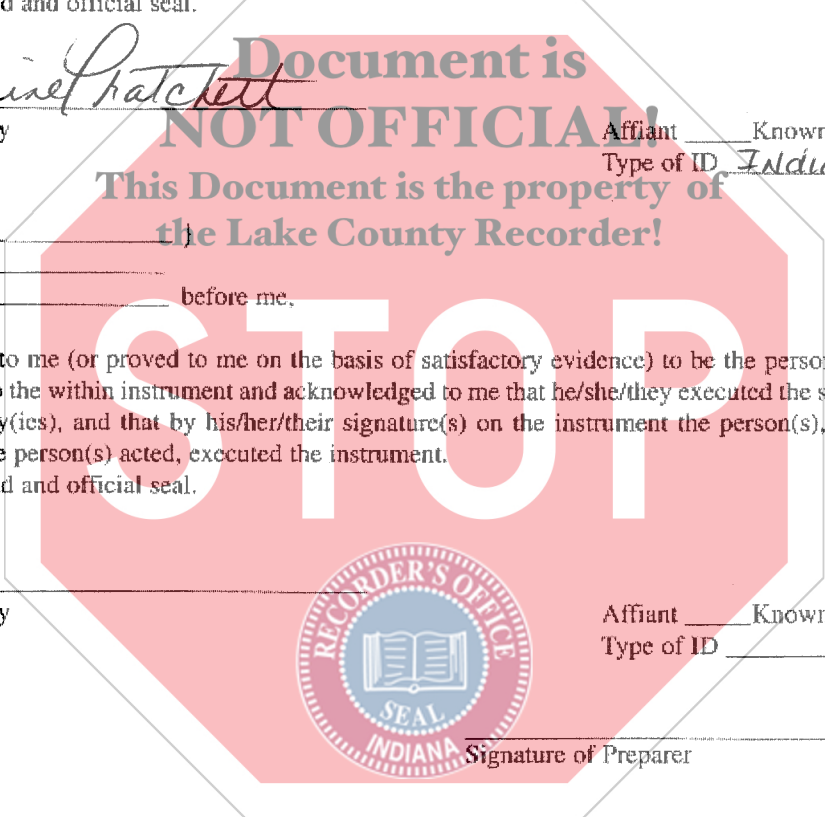

Affiant _____ Known _____ Produced ID _____
Type of ID _____ (Seal)

Signature of Preparer

Print Name of Preparer

Address of Preparer

(2)

.....
If your state requires 8 1/2" x 11" forms, cut off the bottom of this page at the dotted line.