

STATE OF INDIANA
LAKE COUNTY
FILED FOR RECORD

2004 039580

2004 MAY 13 PM 3:08

MORRIS W. CARTER
RECORDER

QUITCLAIM DEED

THIS QUITCLAIM DEED, Executed this 11th day of MAY, 2004 (year),

by first party, Grantor, Northwest Indiana Commercial Industrial Investment, INC.(NICII)

whose post office address is 825 South Lake Street, Gary, Indiana 46403

to second party, Grantee, Gary Urban Enterprise Association

whose post office address is 825 South Lake Street, Gary, Indiana 46403

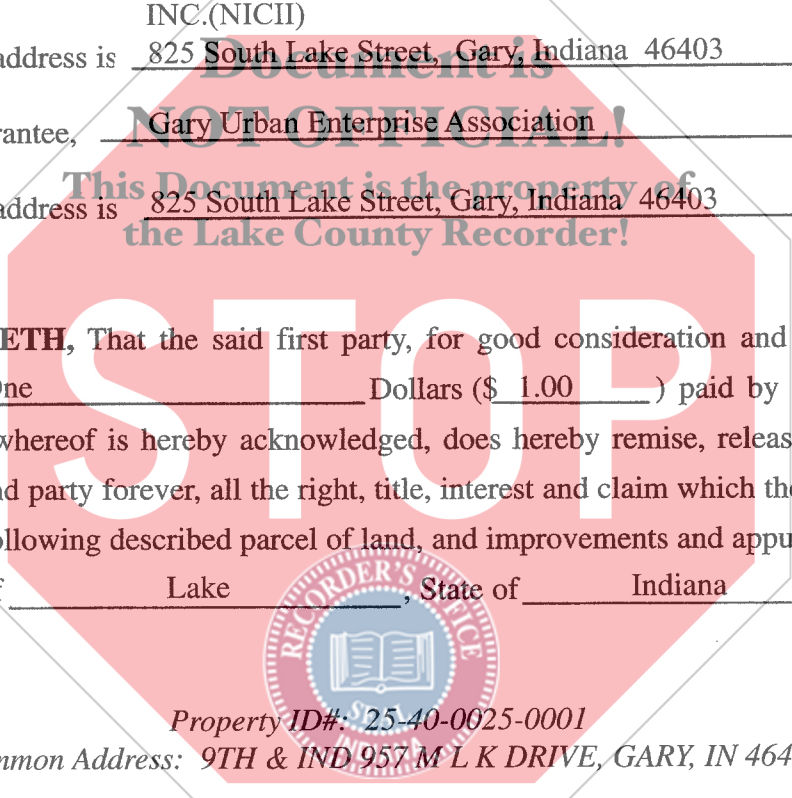

WITNESSETH, That the said first party, for good consideration and for the sum of One Dollars (\$ 1.00) paid by the said second party, the receipt whereof is hereby acknowledged, does hereby remise, release and quitclaim unto the said second party forever, all the right, title, interest and claim which the said first party has in and to the following described parcel of land, and improvements and appurtenances there- in the County of Lake, State of Indiana to wit:

Property ID#: 25-40-0025-0001
Common Address: 9TH & IND 957 M L K DRIVE, GARY, IN 4640

A TRIANGULAR PIECE IN HE SE. CORNER OF SEC. 3, TOWNSHIP 36 NORTH, RANGE 8 WEST OF THE 2ND P.M., DESCRIBED AS FOLLOWS: COMMERNING AT THE POINT OF INTERSECTION OF THE NORTH LINE OF THE RIGHT OF WAY OF THE WABASH RAILROAD WITH THE EAST LINE OF SAID SECTION 3, AND WHICH POINT IS 130.85FT. NOTH OF THE SE. CORNER OF SAID SEC. 3;THENCE WEST ALONG HE SAID NORTH RIGHT OF WAY LINE OF THE WABASH RAILROAD A DISTANCE OF 163.9 FT TO A POINT WHERE SAID NORTH LINE OF THE RIGHT OF WAY OF THE WABASH RAILROAD INTERSECTS. THE SOUTHEASTERLY RIGHT OF WAY LINE OF THE GARY AND WESTERN RAILWAY; THENCE IN A NE. DIREC- TION ALONG THE SE. RIGHT OF WA LINE OF THE GARY POINT ON THE EAST LINE OF SAID SECTION 3, WHICH IS 119.28 FT NORTH OF THE POINT OF BEGINING; THENCE S. ALONG THE SAID EAST LINE OF SAID SECTION 3 TO HE PINT OF BEGINING, IN THE CITY OF GARY, LAKE COUNTY INDIANA.

ABAA (1)

Rev. 4/99

If your state requires 8 1/2" x 11" forms, cut off the bottom of this page at the dotted line.

DULY ENTERED FOR TAXATION SUBJECT TO
FINAL ACCEPTANCE FOR TRANSFER

MAY 13 2004

STEPHEN R. STIGLICH
LAKE COUNTY AUDITOR

001066



16 DG
10720

IN WITNESS WHEREOF, The said first party has signed and sealed these presents the day and year first above written. Signed, sealed and delivered in presence of:

Natalie Holmes
Signature of Witness

Natalie Holmes
Print name of Witness

Signature of Witness

Print name of Witness

J. Lynn Meeks
Signature of First Party

J. Lynn Meeks
Print name of First Party

Signature of First Party

Print name of First Party

State of Indiana

County of Lake

On 5/1/04 before me,

appeared Natalie Holmes + J. Lynn Meeks personally known to me (or proved to me on the basis of satisfactory evidence) to be the person(s) whose name(s) is/are subscribed to the within instrument and acknowledged to me that he/she/they executed the same in his/her/their authorized capacity(ies), and that by his/her/their signature(s) on the instrument the person(s), or the entity upon behalf of which the person(s) acted, executed the instrument.
WITNESS my hand and official seal.

Charmaine Pratchett
Signature of Notary

State of _____

County of _____

On _____ before me,

appeared _____ personally known to me (or proved to me on the basis of satisfactory evidence) to be the person(s) whose name(s) is/are subscribed to the within instrument and acknowledged to me that he/she/they executed the same in his/her/their authorized capacity(ies), and that by his/her/their signature(s) on the instrument the person(s), or the entity upon behalf of which the person(s) acted, executed the instrument.
WITNESS my hand and official seal.

Signature of Notary

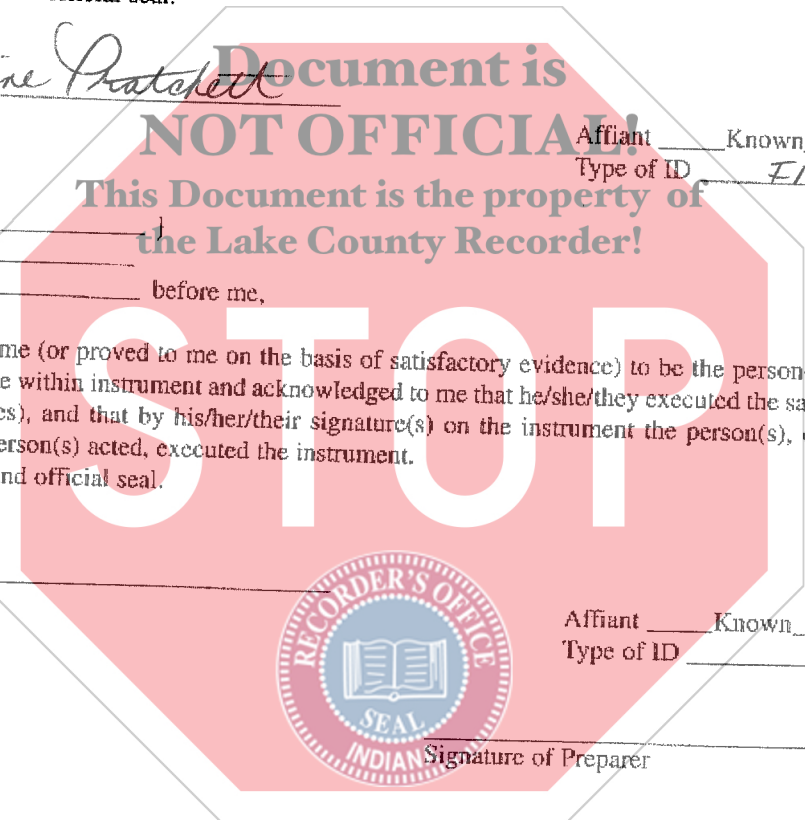

Affiant _____ Known Produced ID _____

Type of ID Indiana

(Seal)

Affiant _____ Known _____ Produced ID _____

Type of ID _____

(Seal)

Signature of Preparer

Print Name of Preparer

Address of Preparer

(2)

If your state requires 8 1/2" x 11" forms, cut off the bottom of this page at the dotted line.