

2

STATE OF INDIANA
LAKE COUNTY
FILED FOR RECORD

2004 037737

20040320

0006161572904004

Chicago Title Insurance Company

After Recording Return To:
COUNTRYWIDE HOME LOANS, INC.
MS SV-79 DOCUMENT PROCESSING
P.O.Box 10423
Van Nuys, CA 91410-0423

2004320BT

[Space Above This Line For Recording Data]

IN1517572568703
[Case #]

2004320
[Escrow/Closing #]

0006161572904004
[Doc ID #]

ASSIGNMENT OF MORTGAGE

KNOW ALL MEN BY THESE PRESENTS That

COUNTRYWIDE HOME LOANS, INC.
4500 Park Granada, Calabasas, CA 91302-1613
organized and existing under the laws of NEW YORK, party of the first part, for
value received, has granted, bargained, sold, assigned, transferred and set over, and by these presents does
grant, sell, assign, transfer and set over unto
THE LEADER MORTGAGE COMPANY

organized and existing under the laws of OHIO, whose location and mailing
address (if different) is
17500 ROCKSIDE ROAD, BEDFORD, OH 44146
party of the second part, its successors and assigns, a certain indenture of mortgage dated
APRIL 28, 2004, made by
PETRA VILLAZANA - SOLE

Mortgage Recorded 5/5/04 as Document # 2004036732

to it, securing the payment of one promissory note therein described for the sum of
ONE HUNDRED SIXTEEN THOUSAND TWO HUNDRED SEVENTEEN and 00/100

Dollars (\$ 116,217.00), and all its rights, title and interest in and to the premises situated in the
county of LAKE State of Indiana, and described in said
mortgage as follows, to-wit:

LOT 23 IN BLOCK 3 IN WICKER PARK MANOR, IN THE TOWN OF HIGHLAND, AS PER
PLAT THEREOF, RECORDED IN PLAT BOOK 25, PAGE 12 IN THE OFFICE OF THE
RECORDER OF LAKE COUNTY, INDIANA.

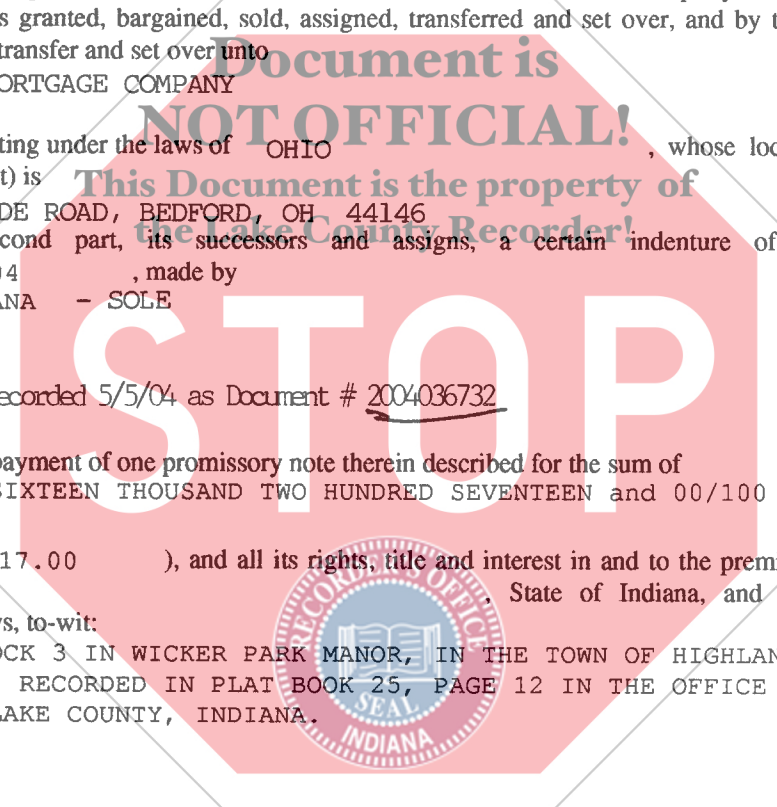

Initials: JB

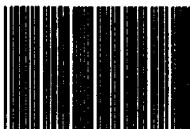

* 2 3 9 9 1 *



* 0 6 1 6 1 5 7 2 9 0 0 0 0 2 9 9 5 - *

1700 et

CASE #: IN1517572568703

DOC ID #: 0006161572904004

which said mortgage is recorded in the office of the Recorder of

LAKE

County, in the State of Indiana, in Book No.

at Page as Document No.

together with the said note therein described

and the money due or to grow due thereon, with the interest:

TO HAVE AND TO HOLD the same unto the said party of the second part, its successors and assigns, forever, subject only to the provisions in the said indenture of mortgage contained.

IN WITNESS WHEREOF, the party of the first part has caused this instrument to be executed in its name by JULI BELICEK its LOAN SPECIALIST II

, and attested by KELLY NEFF LOAN SPECIALIST II, its and its corporate seal to be hereunto affixed this

TWENTY-EIGHTH day of April, A.D. 2004.
ATTEST:

COUNTRYWIDE HOME LOANS, INC.

Document is NOT OFFICIAL!

Juli Belicek

Kelly Neff

JULI BELICEK, LOAN SPECIALIST II
STATE OF INDIANA
COUNTY OF LAKE

KELLY NEFF, LOAN SPECIALIST II

On 4-27-04, before me

, personally appeared

Juli Belicek and Kelly Neff

, personally known to me (or proved to me on the basis of satisfactory evidence) to be the person(s) whose name(s) is/are subscribed to the within instrument and acknowledged to me that he/she/they executed the same in his/her/their authorized capacity(ies), and that by his/her/their signature(s) on the instrument the person(s), or the entity upon behalf of which the person(s) acted, executed the instrument.

WITNESS my hand and official seal.



CHRISTINE ZIMMERMAN, Notary Public
Porter County, State of Indiana
My commission expires: June 5, 2011

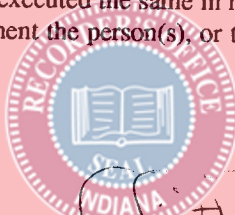

Christine Zimmerman (Seal)

This form was prepared by: KELLY M. NEFF
COUNTRYWIDE HOME LOANS, INC.

address:

1525 US HIGHWAY 41 SUITE C-26, SCHERERVILLE, IN 46375
tel. no.: (219) 322-2802