

2

LAKE COUNTY
FILED FOR RECORD

2004 034792

MORTGAGE
RECORDING

After Recording Return To:
COUNTRYWIDE HOME LOANS, INC.
MS SV-79 DOCUMENT PROCESSING
P.O.Box 10423
Van Nuys, CA 91410-0423

[Space Above This Line For Recording Data]

IN1517546618703
[Case #]

620041996
[Escrow/Closing #]

0004919503604004
[Doc ID #]

ASSIGNMENT OF MORTGAGE

KNOW ALL MEN BY THESE PRESENTS That

COUNTRYWIDE HOME LOANS, INC.
4500 Park Granada, Calabasas, CA 91302-1613
organized and existing under the laws of NEW YORK, party of the first part, for
value received, has granted, bargained, sold, assigned, transferred and set over, and by these presents does
grant, sell, assign, transfer and set over unto

THE LEADER MORTGAGE COMPANY
organized and existing under the laws of OHIO, whose location and mailing
address (if different) is 17500 ROCKSIDE ROAD, BEDFORD, OH 44146
party of the second part, its successors and assigns, a certain indenture of mortgage dated
APRIL 23, 2004, made by
ELIZABETH A PIUNTI - SOLE

to it, securing the payment of one promissory note therein described for the sum of
ONE HUNDRED FIVE THOUSAND SIXTY ONE and 00/100

Dollars (\$ 105,061.00), and all its rights, title and interest in and to the premises situated in the
county of LAKE, State of Indiana, and described in said
mortgage as follows, to-wit:

LOT 18, BLOCK 1, COUNTRY CLUB ESTATES SUBDIVISION, IN THE CITY OF HOBART,
AS PER PLAT THEREOF, RECORDED IN PLAT BOOK 20 PAGE 41, IN THE OFFICE OF
THE RECORDER OF LAKE COUNTY, INDIANA.

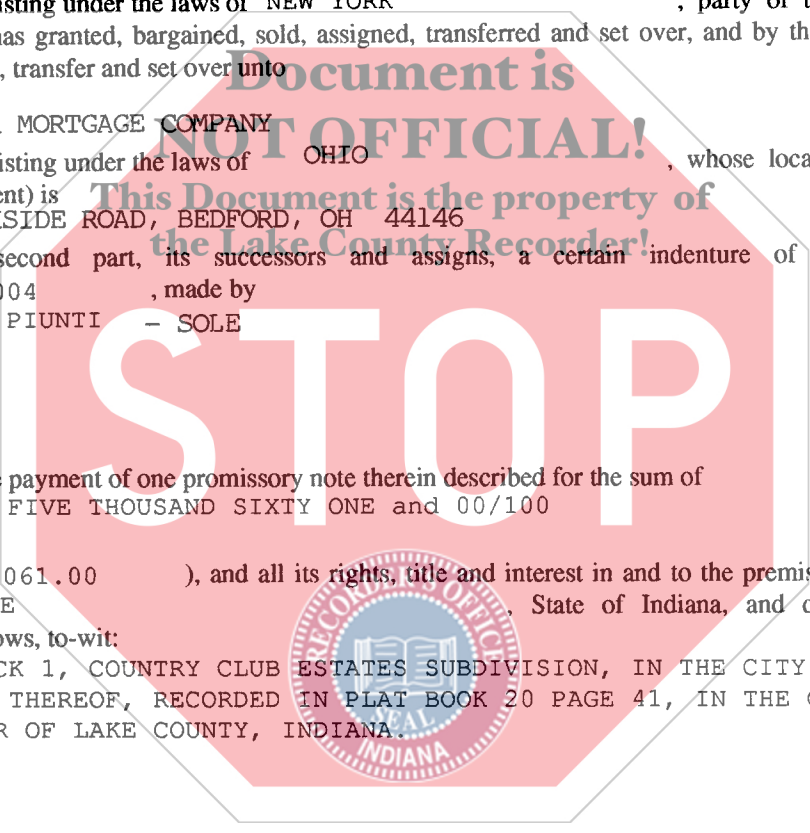

Mtg 2004-034791



TICOR TITLE INS.
HIGHLAND, INDIANA

920042046

Handwritten initials/signature

CASE #: IN1517546618703

DOC ID #: 0004919503604004

which said mortgage is recorded in the office of the Recorder of

LAKE

County, in the State of Indiana, in Book No.

at Page as Document No.

together with the said note therein described

and the money due or to grow due thereon, with the interest:

TO HAVE AND TO HOLD the same unto the said party of the second part, its successors and assigns, forever, subject only to the provisions in the said indenture of mortgage contained.

IN WITNESS WHEREOF, the party of the first part has caused this instrument to be executed in its name by JULI BELICEK

its LOAN SPECIALIST II

, and attested by KELLY NEFF

LOAN SPECIALIST II

, its and its corporate seal to be hereunto affixed this

TWENTY-THIRD day of April, A.D. 2004.

ATTEST:

COUNTRYWIDE HOME LOANS, INC.

Document is NOT OFFICIAL!

Juli Belicek

This Document is By: *Kelly Neff* of the Lake County Recorder!

JULI BELICEK, LOAN SPECIALIST II
STATE OF INDIANA.
COUNTY OF LAKE

KELLY NEFF, LOAN SPECIALIST II

On 4-22-04, before me Christine Zimmerman

, personally appeared

Juli Belicek and Kelly Neff, Loan Specialists II of Countrywide Home Loans, Inc.,

, personally known to me (or proved to me on the

basis of satisfactory evidence) to be the person(s) whose name(s) is/are subscribed to the within instrument and acknowledged to me that he/she/they executed the same in his/her/their authorized capacity(ies), and that by his/her/their signature(s) on the instrument the person(s), or the entity upon behalf of which the person(s) acted, executed the instrument.

WITNESS my hand and official seal.

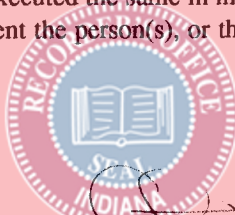

Christine Zimmerman (Seal)

This form was prepared by: KELLY M. NEFF

COUNTRYWIDE HOME LOANS, INC.

address:

1525 US HIGHWAY 41 SUITE C-26, SCHERERVILLE, IN 46375

tel. no.: (219) 322-2802