

2  
X

LAKE COUNTY  
FILED FOR RECORD

2004 034015

2004 APR 27 10:00 AM

Mail tax bills to:  
1924 SILVER CREEK COURT  
CROWN POINT, IN 46307

MORNING STAR  
Key No. 13-440-33

### WARRANTY DEED

THIS INDENTURE WITNESSETH, That **DOROTHY M. RYBICKI** ("Grantor") of Lake County in the State of Indiana CONVEY (S) AND WARRANT (S) TO **DAWN E. BUCHKO** ("Grantee") of Lake County in the State of Indiana in consideration of One Dollar and other valuable consideration, the receipt and sufficiency of which are hereby acknowledged, the following described real estate in Lake County, in the State of Indiana:

SEE ATTACHED SHEET FOR LEGAL DESCRIPTION

Subject to: Taxes for 2003 and subsequent years, building lines, covenants and restrictions.

Dated this 12<sup>th</sup> day of April, 2004.

*Dorothy M. Rybicki*  
DOROTHY M. RYBICKI

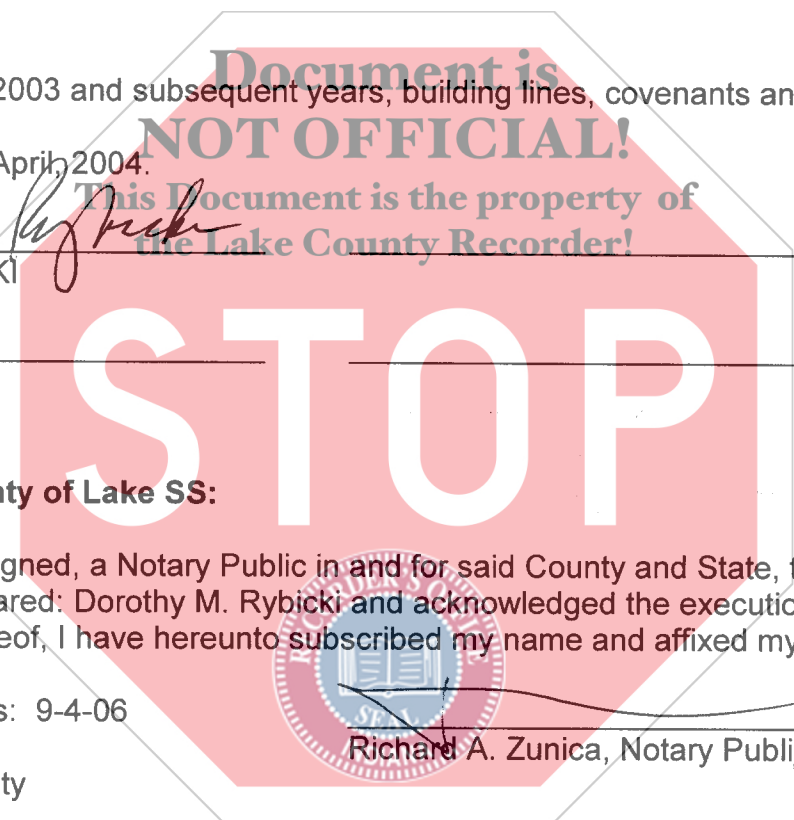

State of Indiana County of Lake SS:

Before me, the undersigned, a Notary Public in and for said County and State, this 12<sup>th</sup> day of April, 2004, personally appeared: Dorothy M. Rybicki and acknowledged the execution of the foregoing deed. In witness whereof, I have hereunto subscribed my name and affixed my official seal.

My commission expires: 9-4-06

Resident of Lake County

*Richard A. Zunica*  
Richard A. Zunica, Notary Public

This instrument prepared by: Attorney Richard A. Zunica  
162 Washington  
Lowell, In 46356

File No. 04-12916

DULY ENTERED FOR TAXATION SUBJECT TO  
FINAL ACCEPTANCE FOR TRANSFER

APR 27 2004

STEPHEN R. STIGLICH  
LAKE COUNTY AUDITOR

002151

16-  
MV  
10587

Commonwealth Land Title

Commitment Number: 04-12916

**SCHEDULE C  
PROPERTY DESCRIPTION**

The land referred to in this Commitment is described as follows:

PART OF LOT 3 IN SPRINGVALE FARMS COURT "M" IN THE TOWN OF SCHERERVILLE, AS PER PLAT THEREOF, RECORDED IN PLAT BOOK 63 PAGE 52, IN THE OFFICE OF THE RECORDER OF LAKE COUNTY, INDIANA, AND CORRECTED BY CERTIFICATE OF CORRECTION RECORDED APRIL 2, 1990 AS DOCUMENT NO. 092725, AND FURTHER AMENDED BY CERTIFICATE OF CORRECTION RECORDED OCTOBER 15, 1991 AS DOCUMENT NO. 91052151, BEING MORE PARTICULARLY DESCRIBED AS FOLLOWS: COMMENCING AT THE SOUTHEAST CORNER OF SAID LOT 3; THENCE NORTH 39 DEGREES 55 MINUTES 30 SECONDS EAST, 159.9 FEET TO THE POINT OF BEGINNING OF THIS DESCRIBED PARCEL; THENCE CONTINUING NORTH 28 DEGREES 59 MINUTES 56 SECONDS EAST, 32.58 FEET; THENCE NORTH 61 DEGREES 00 MINUTES 04 SECONDS WEST 89.00 FEET, MORE OR LESS, TO THE NORTHWESTERLY LINE OF SAID LOT 3; THENCE SOUTH 28 DEGREES 59 MINUTES 56 SECONDS WEST, 32.58 FEET; THENCE SOUTH 61 DEGREES 00 MINUTES 04 SECONDS EAST 89.0 FEET, MORE OR LESS, TO THE POINT OF BEGINNING, COMMONLY KNOWN AS BUILDING 3-5.

