

7

STATE OF INDIANA  
LAKE COUNTY  
FILED FOR RECORD

2004 015898

2004 FEB 25 PM 2:30

MORRIS W. CARLIER  
RECORDER

### QUITCLAIM DEED

**THIS QUITCLAIM DEED**, Executed this 4th day of February, 2004 (year),

by first party, Grantor, Northwest Indiana Commercial Industrial Investment, INC. (NICII, INC) *A.K.A. NH*

whose post office address is 825 South Lake Street, Gary, Indiana 46403

to second party, Grantee, Gary Urban Enterprise Association

whose post office address is 825 South Lake Street, Gary, Indiana 46403

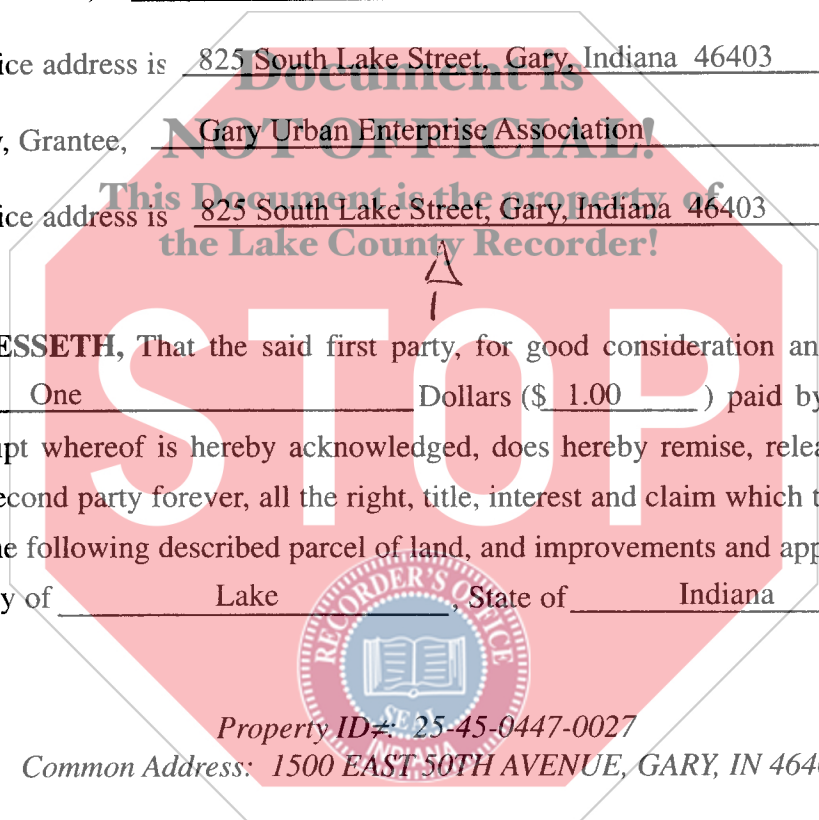

**WITNESSETH**, That the said first party, for good consideration and for the sum of One Dollars (\$ 1.00 ) paid by the said second party, the receipt whereof is hereby acknowledged, does hereby remise, release and quitclaim unto the said second party forever, all the right, title, interest and claim which the said first party has in and to the following described parcel of land, and improvements and appurtenances there- to in the County of Lake, State of Indiana to wit:

Property ID#: 25-45-0447-0027  
Common Address: 1500 EAST 50TH AVENUE, GARY, IN 4640

**HILL TERRACE WEST 30 FEET OF LOT 14, BLOCK 6, AND THE EAST 20 FEET OF LOT 15, BLOCK 6, IN THE CITY OF GARY, LAKE COUNTY, INDIANA.**

DULY ENTERED FOR TAXATION SUBJECT TO  
FINAL ACCEPTANCE FOR TRANSFER

FEB 25 2004 001788  
Rev. 4/99

ABAA (1)

If your state requires 8 1/2" x 11" forms, cut off the bottom of this page at the dotted line.

**STEPHEN B. STIGLICH**  
LAKE COUNTY AUDITOR



*DB. 16  
ACT# 10257*

IN WITNESS WHEREOF, The said first party has signed and sealed these presents the day and year first above written. Signed, sealed and delivered in presence of:

Natalie Holmes  
Signature of Witness

Natalie Holmes  
Print name of Witness

\_\_\_\_\_  
Signature of Witness

\_\_\_\_\_  
Print name of Witness

J. Lynn Meeks  
Signature of First Party

J. Lynn Meeks  
Print name of First Party

\_\_\_\_\_  
Signature of First Party

\_\_\_\_\_  
Print name of First Party

State of Indiana )

County of Lake

On 2/4/04 before me,

appeared Natalie Holmes & J. Lynn Meeks personally known to me (or proved to me on the basis of satisfactory evidence) to be the person(s) whose name(s) is/are subscribed to the within instrument and acknowledged to me that he/she/they executed the same in his/her/their authorized capacity(ies), and that by his/her/their signature(s) on the instrument the person(s), or the entity upon behalf of which the person(s) acted, executed the instrument.  
WITNESS my hand and official seal.

Charmaine Pratchett  
Signature of Notary

State of \_\_\_\_\_ )  
County of \_\_\_\_\_

On \_\_\_\_\_ before me,  
appeared

personally known to me (or proved to me on the basis of satisfactory evidence) to be the person(s) whose name(s) is/are subscribed to the within instrument and acknowledged to me that he/she/they executed the same in his/her/their authorized capacity(ies), and that by his/her/their signature(s) on the instrument the person(s), or the entity upon behalf of which the person(s) acted, executed the instrument.  
WITNESS my hand and official seal.

\_\_\_\_\_  
Signature of Notary

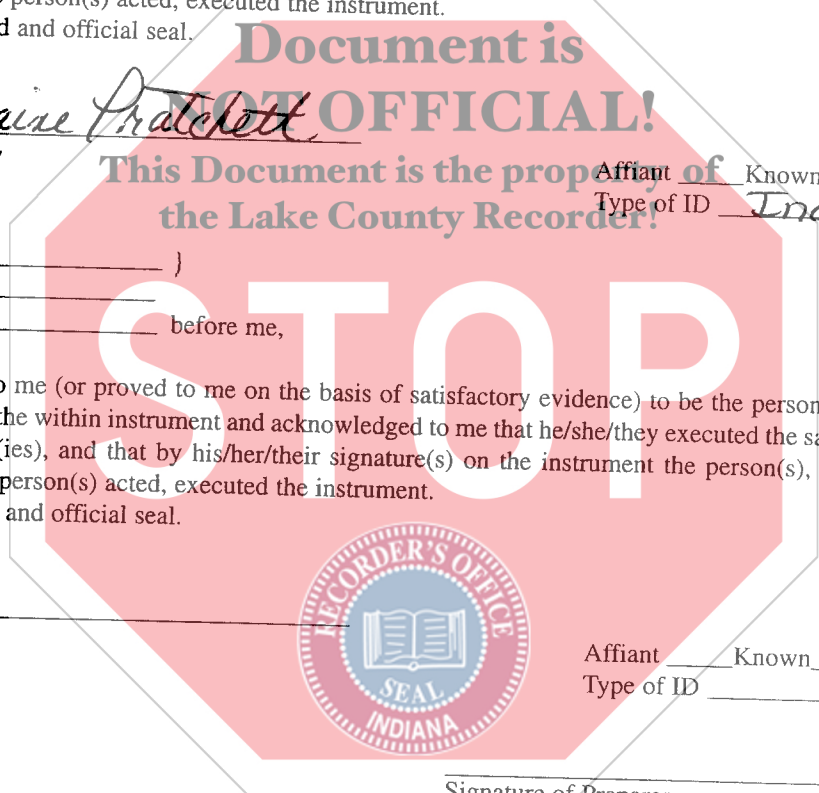

Affiant \_\_\_\_\_ Known  Produced ID \_\_\_\_\_  
Type of ID Indiana (Seal)

Affiant \_\_\_\_\_ Known \_\_\_\_\_ Produced ID \_\_\_\_\_  
Type of ID \_\_\_\_\_ (Seal)

\_\_\_\_\_  
Signature of Preparer

\_\_\_\_\_  
Print Name of Preparer

\_\_\_\_\_  
Address of Preparer