

2

STATE OF INDIANA
LAKE COUNTY
FILED FOR RECORD

2004 015888

2004 FEB 25 PM 2:06

MORRIS W. WALTER
RECORDER

QUITCLAIM DEED

THIS QUITCLAIM DEED, Executed this 4th day of February, 2004 (year),
 by first party, Grantor, Northwest Indiana Commercial Industrial Investment Inc. (NICII) (NICII/ENC)
 whose post office address is 825 South Lake Street, Gary, Indiana 46403
 to second party, Grantee, Gary Urban Enterprise Association (GUEA)
 whose post office address is 825 South Lake Street, Gary, Indiana 46403

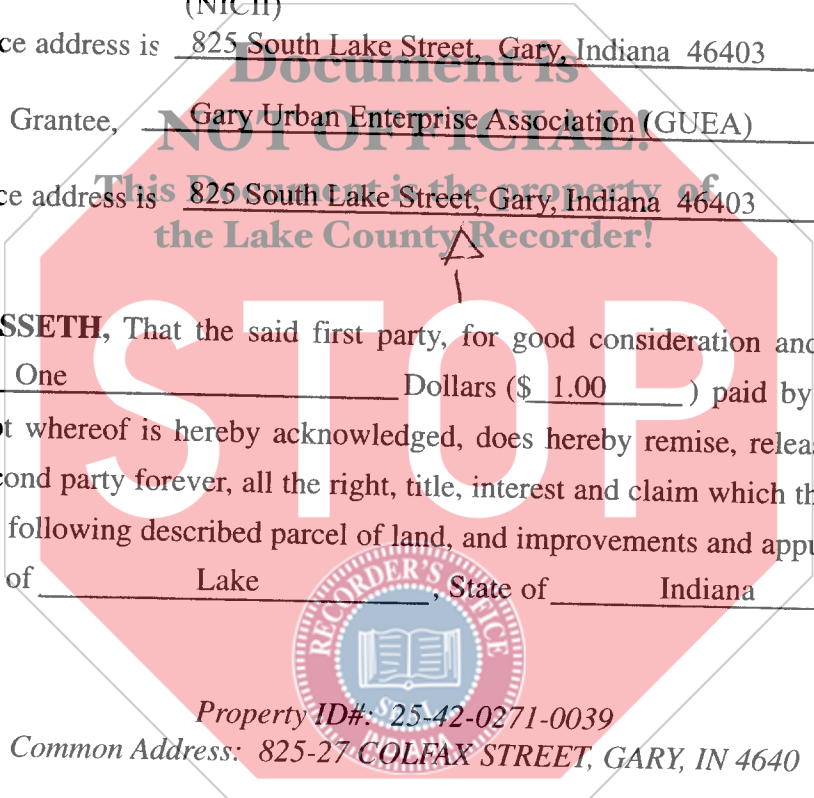

WITNESSETH, That the said first party, for good consideration and for the sum of
One Dollars (\$ 1.00) paid by the said second
 party, the receipt whereof is hereby acknowledged, does hereby remise, release and quitclaim
 unto the said second party forever, all the right, title, interest and claim which the said first party
 has in and to the following described parcel of land, and improvements and appurtenances there-
 to in the County of Lake, State of Indiana to wit:

Property ID#: 25-42-0271-0039
 Common Address: 825-27 COLFAX STREET, GARY, IN 4640

**LOT 39, BLOCK 5 IN R.L. MILLER RESUBDIVISION OF BLOCK 5, EAST HYDE PARK
 ADDITION, IN THE CITY OF GARY, LAKE COUNTY, INDIANA** DOCUMENTED FOR TAXATION SUBJECT TO
 FINAL ACCEPTANCE FOR TRANSFER

FEB 25 2004 SL6

001778 STEPHEN R. STIGLICH
LAKE COUNTY AUDITOR

ABAA (1)

Rev. 4/99

If your state requires 8 1/2" x 11" forms, cut off the bottom of this page at the dotted line.



D.B. 1600
 OK# 10257

IN WITNESS WHEREOF, The said first party has signed and sealed these presents the day and year first above written. Signed, sealed and delivered in presence of:

Natalie Holmes
Signature of Witness

J. Lynn Meeks
Signature of First Party

Natalie Holmes
Print name of Witness

J. Lynn Meeks
Print name of First Party

Signature of Witness

Signature of First Party

Print name of Witness

Print name of First Party

State of Indiana)
County of Lake

On 2/4/04 before me,
appeared Natalie Holmes & J. Lynn Meeks
personally known to me (or proved to me on the basis of satisfactory evidence) to be the person(s) whose name(s) is/are subscribed to the within instrument and acknowledged to me that he/she/they executed the same in his/her/their authorized capacity(ies), and that by his/her/their signature(s) on the instrument the person(s), or the entity upon behalf of which the person(s) acted, executed the instrument.
WITNESS my hand and official seal.

Charmaine Pratchett
Signature of Notary

Affiant _____ Known Produced ID _____
Type of ID Indiana (Seal)

State of _____)
County of _____

On _____ before me,
appeared _____
personally known to me (or proved to me on the basis of satisfactory evidence) to be the person(s) whose name(s) is/are subscribed to the within instrument and acknowledged to me that he/she/they executed the same in his/her/their authorized capacity(ies), and that by his/her/their signature(s) on the instrument the person(s), or the entity upon behalf of which the person(s) acted, executed the instrument.
WITNESS my hand and official seal.

Signature of Notary

Affiant _____ Known _____ Produced ID _____
Type of ID _____ (Seal)

Signature of Preparer

Print Name of Preparer

Address of Preparer