

FILED FOR RECORD
COUNTY CLERK
PALM BEACH COUNTY
FLORIDA

2003 113726

2003 OCT 22 PM 3:29

MORRIS H. CARTER
RECORDED

[WHEN RECORDED RETURN TO]
NTC -- ATTN: ALAN GRAHAM
2100 ALT. 19 NORTH
PALM HARBOR, FLORIDA 34683
DELTA Loan No: 0099089492

ASSIGNMENT OF MORTGAGE

This instrument Prepared by:

Delta Funding Corporation
1000 Woodbury Road
Woodbury, NY 11797



KNOW THAT Delta Funding Corporation, a corporation duly authorized to do business in the State of New York, having its principal office located at: 1000 Woodbury Road, Woodbury, New York 11797 **assignor,**

in consideration of TEN DOLLARS (\$10.00) and other valuable considerations **dollars,**

paid by:

WELLS FARGO BANK MINNESOTA, NATIONAL ASSOCIATION,
AS TRUSTEE FOR RENAISSANCE HEL TRUST 2002-2
C/O OCWEN FEDERAL BANK FSB, AS SERVICING AGENT
1675 PALM BEACH LAKES BLVD., WEST PALM BEACH, FL 33401

assignee,

Hereby assigns unto the assignee, 100% undivided interest of Mortgage dated the 19th day of March, 2002, made by BRENDA S. FRANCISCO

to DELTA FUNDING CORPORATION

in the principal sum of \$33,150.00 and recorded on the 28th day of March 2002, in the office of the Clerk of the County of Lake in Liber of Section of Mortgages, Page

covering premises commonly known as: #2002029668
Property Address: 929 STEVENSON STREET, Gary, IN 46406

Section: Block: 2 Lot: 13 & 14

District:
As shown on the Land and Tax Maps of the County of: Lake
Address #2:

Section: Block: Lot:
District:

As shown on the Land and Tax Maps of the County of:
Address #3:

Section: Block: Lot:
District:

As shown on the Land and Tax Maps of the County of:

THIS ASSIGNMENT IS NOT SUBJECT TO THE REQUIREMENTS OF SECTION 275 OF THE REAL PROPERTY LAW BECAUSE IT IS AN ASSIGNMENT WITHIN THE SECONDARY MORTGAGE MARKET.

Together with the bond or note or obligation described in said mortgage, and the moneys due and to grow due thereon with the interest; **TO HAVE AND TO HOLD** the same unto the assignee and to the successors, legal representative and assigns of the assignee forever. The word assignor; or assignee shall be construed as if it read assigns or assignees whenever the sense of this instrument so requires.

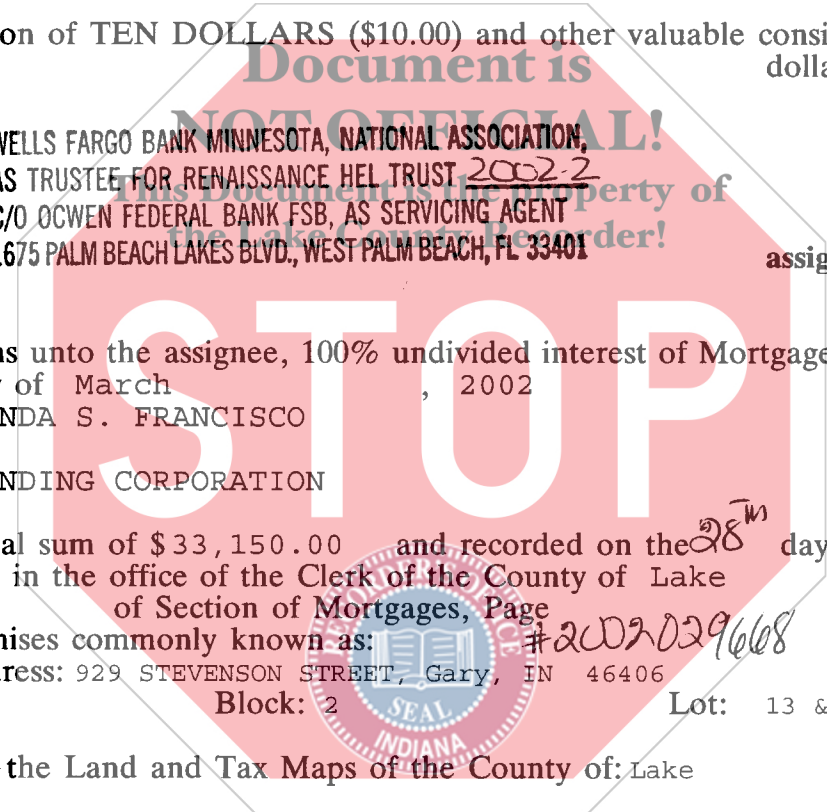

1407067
1200
BASSIGN
/s/

IN WITNESS WHEREOF, the assignor has duly executed this assignment the ^{25th}
day of November, 2002.

IN PRESENCE OF : **DELTA FUNDING CORPORATION**

Carol Hollmann
By: Carol Hollmann
Title: Vice President

Maureen McTiernan
Witness **MAUREEN MCTIERNAN**

Valerie Johnson
Witness **VALERIE JOHNSON**

STATE OF NEW YORK , COUNTY OF NASSAU ss:

On the ^{25th} day of November in the year 2002 , before me, the undersigned, a Notary Public in and for Said State, personally appeared Carol Hollmann Personally know to me or proved to me on the basis of satisfactory evidence to be the individual(s) whose name(s) is (are) subscribed to the within instrument and acknowledged to me that he/she/they executed the same in his/her/their capacity(ies), and that by his/her/their signatures(s) on the instrument, the individual(s), or the person upon behalf of which the individual(s) acted, executed the instrument.

Jessica A. Conde
NOTARY PUBLIC

JESSICA A. CONDE
Notary Public, State Of New York
No. 01CO6036683
Qualified In Queens County
Commission Expires 2/7/2006

Loan #: 0099089492
App #: 0202110783

ASSIGNMENT OF MORTGAGE WITHOUT COVENANT

TITLE NO.

DELTA FUNDING CORPORATION

TO **WELLS FARGO BANK MINNESOTA, NATIONAL ASSOCIATION,
AS TRUSTEE FOR RENAISSANCE HEL TRUST 2002-2
C/O OCWEN FEDERAL BANK FSB, AS SERVICING AGENT
1675 PALM BEACH LAKES BLVD., WEST PALM BEACH, FL 33401**

RECORD AND RETURN TO
DELTA FUNDING CORPORATION
QUALITY CONTROL DEPT.
1000 WOODBURY ROAD
WOODBURY, NEW YORK
11797

