

STATE OF INDIANA
LAKE COUNTY
RECORDS DEPARTMENT

2003 112210

2003 OCT 17 AM 11:28

RECORDS DEPARTMENT
LAKE COUNTY

STATE OF INDIANA)
) SS:
COUNTY OF LAKE)

Re: ESTATE OF SOPHIE M. GRISH

26898

PERSONAL REPRESENTATIVE'S DEED

Martha E. Jelski is the Personal Representative of the Estate of Sophie M. Grish, Deceased. This Estate is pending as Cause Number 45D01-0310-EU- 063, in the Superior Court of Lake County, Indiana, Room Number One. The Personal Representative, by virtue of the power given a Personal Representative under Indiana law, for good and sufficient consideration conveys to Valerie D. Jackson, the following described real estate in Lake County, State of Indiana:

Lots 20 and 21, Block 19, Fourth Addition to Indiana Harbor, Lake County, Indiana.
Commonly Known As: 1312 E. Columbus Drive, East Chicago, Indiana
Key Numbers: 24-30-402-20

Subject to all legal highways, rights-of-way, easements, and any restrictions or liens of record and subject to taxes for the years 2002 and 2003, and all taxes subsequent thereto.

IN WITNESS WHEREOF, said Martha E. Jelski, as Personal Representative of the Estate of Sophie M. Grish, Deceased, has hereunto set her hand and seal this 7th day of October, 2003.

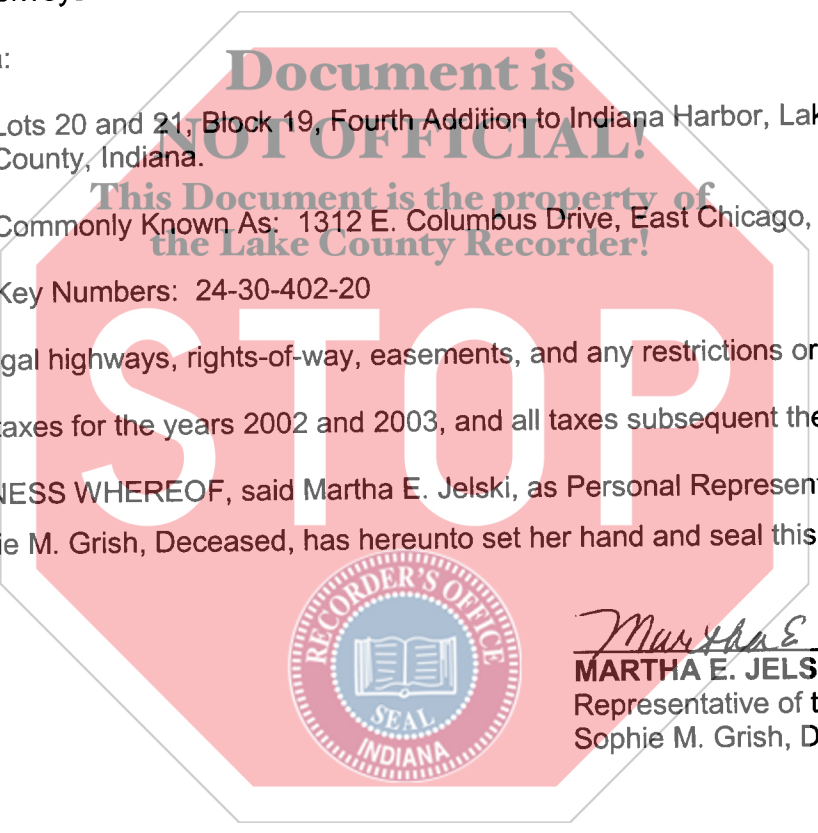

Martha E. Jelski

MARTHA E. JELSKI, as Personal Representative of the Estate of Sophie M. Grish, Deceased

COUNTY OF LAKE, STATE OF INDIANA SS:

Before me, the undersigned, a Notary Public in and for said County and State, personally appeared Martha E. Jelski, as Personal Representative of the Estate of Sophie M. Grish, and acknowledged the execution of the foregoing deed to be her free and voluntary act and deed for the uses and purposes expressed herein.

DULY ENTERED FOR TAXATION SUBJECT TO FINAL ACCEPTANCE FOR RECORD
OCT 17 2003

WITNESS my hand and Notarial seal this 7th day of October, 2003.

STEPHEN R. STIGLICH
LAKE COUNTY AUDITOR
Signed: *Sandra J. VerWeij*
Printed: SANDRA J. VerWeij
Notary Public

My Commission Expires: 3-9-07

Resident of LAKE County, Indiana

COMMUNITY TITLE COMPANY
FILE NO *26898*

001449

14- JG Allen