

2

STATE OF INDIANA
LAKE COUNTY
FILED FOR RECORD

2003 109470

2003 OCT 10 AM 11:14

MORRIS W. CARTER
RECORDER

A298-10
R298-04

QUITCLAIM DEED

THIS QUITCLAIM DEED, Executed this 10th day of October , 2003 (year),

by first party, Grantor, Russell P. McWilliams and Vicki R. Boteler

whose post office address is P. O. Box 59, Schneider, IN 46376

to second party, Grantee, Russell P. McWilliams and Vicki R. McWilliams **- H+W**

whose post office address is P. O. Box 59, Schneider, IN 46376

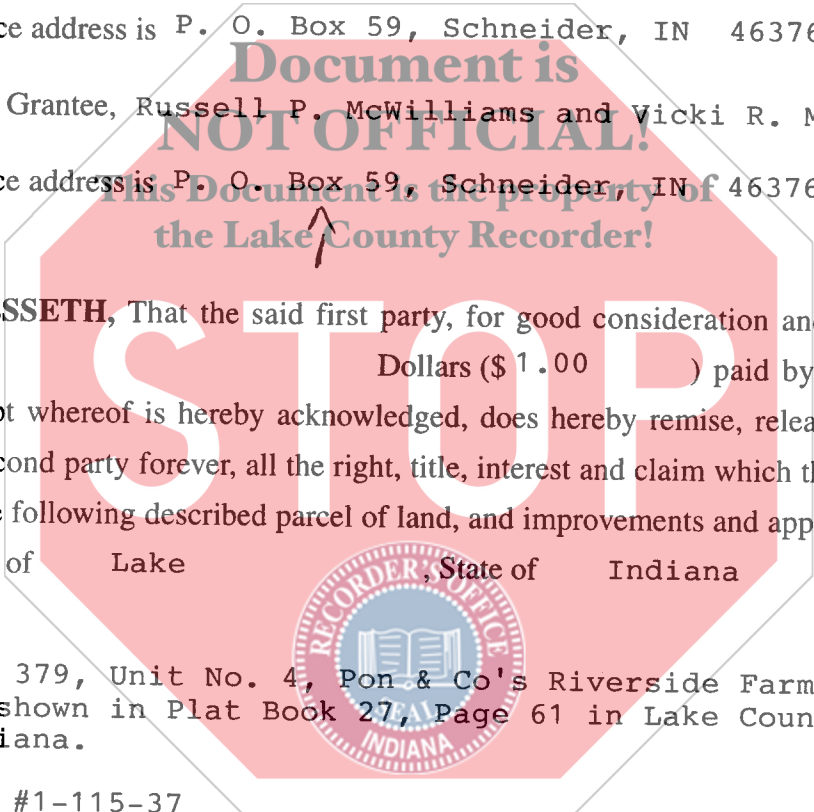

WITNESSETH, That the said first party, for good consideration and for the sum of One Dollars (\$ 1.00) paid by the said second party, the receipt whereof is hereby acknowledged, does hereby remise, release and quitclaim unto the said second party forever, all the right, title, interest and claim which the said first party has in and to the following described parcel of land, and improvements and appurtenances there- to in the County of Lake , State of Indiana to wit:

Lot 379, Unit No. 4, Pon & Co's Riverside Farms, as shown in Plat Book 27, Page 61 in Lake County, Indiana.

Key #1-115-37

DULY ENTERED FOR TAXATION SUBJECT TO
FINAL ACCEPTANCE FOR TRANSFER

OCT 10 2003

STEPHEN R. STIGLICH
LAKE COUNTY AUDITOR

AKHF
(1)

(Revised 3/98)

If your state requires 8 1/2" x 11" forms, cut off the bottom of this page at the dotted line.

*no cash
16 DB*

000955



IN WITNESS WHEREOF, The said first party has signed and sealed these presents the day and year first above written. Signed, sealed and delivered in presence of:

Debra DuBord
Signature of Witness

Debra DuBord
Print name of Witness

Mark Amberson
Signature of Witness

Mark Amberson
Print name of Witness

Russell P. McWilliams
Signature of First Party

Russell P. McWilliams and
Vicki R. Boteler
Print name of First Party

Vicki R. Boteler
Signature of First Party

Russell P. McWilliams and
Vicki R. Boteler
Print name of First Party

State of Indiana }
County of Lake

On 10-10-03 before me, Sharon Perkins
appeared Russell P. McWilliams and Vicki R. Boteler
personally known to me (or proved to me on the basis of satisfactory evidence) to be the person(s) whose name(s)
is/are subscribed to the within instrument and acknowledged to me that he/she/they executed the same in
his/her/their authorized capacity(ies), and that by his/her/their signature(s) on the instrument the person(s), or the
entity upon behalf of which the person(s) acted, executed the instrument.
WITNESS my hand and official seal.

Sharon Perkins
Signature of Notary

Affiant _____ Known _____ Produced ID
Type of ID _____
(Seal)

State of _____ }
County of _____
On _____

before me,
appeared
personally known to me (or proved to me on the basis of satisfactory evidence) to be the person(s) whose name(s)
is/are subscribed to the within instrument and acknowledged to me that he/she/they executed the same in
his/her/their authorized capacity(ies), and that by his/her/their signature(s) on the instrument the person(s), or the
entity upon behalf of which the person(s) acted, executed the instrument.
WITNESS my hand and official seal.

Signature of Notary

Affiant _____ Known _____ Produced ID
Type of ID _____
(Seal)

Nancy McWilliams
Signature of Preparer

Nancy McWilliams
Print Name of Preparer

7964 W. 205th Ave., Lowell, IN 46356
Address of Preparer

(2)

If your state requires 8 1/2" x 11" forms, cut off the bottom of this page at the dotted line.