

2

QUITCLAIM DEED

2003 109019

03000791

THIS QUITCLAIM DEED, executed this 13th day of April, 2002

by first party, Grantor, Charles Conley

whose post office address is

to second party, Grantee, *LaShawnda Conley* LaShawnda Conley

whose post office address is 3802 Martin Luther King Drive  
Gary, IN 46409

STATE OF INDIANA  
LAKE COUNTY  
FILED FOR RECORD  
2003 OCT -9 PM 12:35  
MORRIS W. CARTER  
RECORDER

WITNESSETH, That the said first party, for good consideration and for the sum of Dollars (\$ 10.00) paid by the said second party, the receipt whereof is hereby acknowledged, does hereby remise, release and quitclaim unto the said second party forever, all the right, title, interest and claim which the said first party has in and to the following described parcel of land, and improvements and appurtenances thereto in the County of \_\_\_\_\_, State of Indiana to wit:

All Lots 45 & 46, Block 18 in Great Gary Realty Company's First Addition, In the City of Gary, Lake County, Indiana.

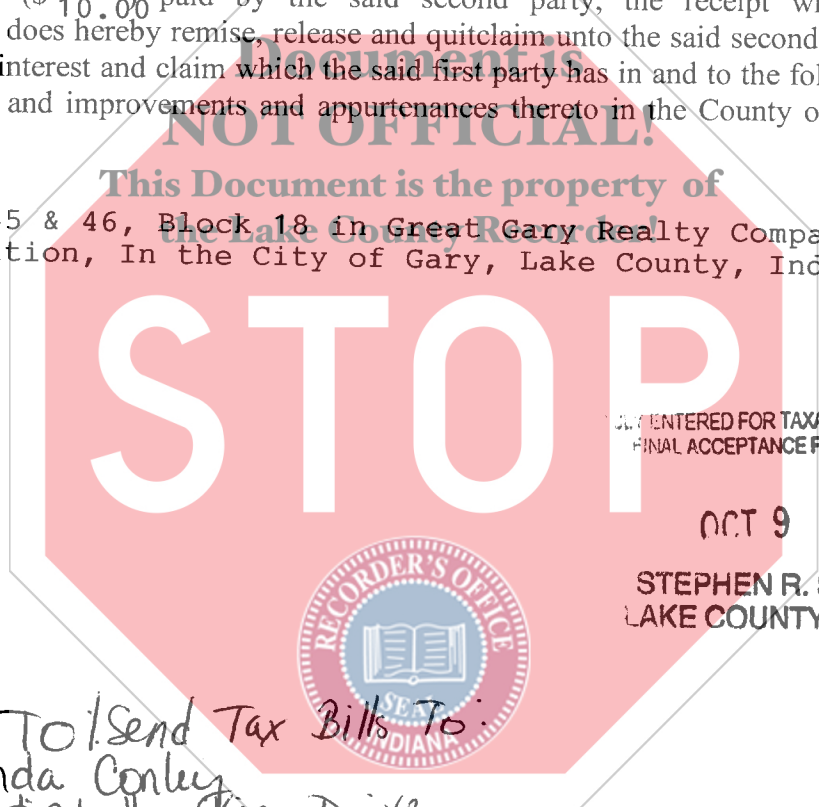

FILED FOR TAXATION SUBJECT TO FINAL ACCEPTANCE FOR TRANSFER

OCT 9 2003

STEPHEN R. STIGLICH  
LAKE COUNTY AUDITOR



→ Return To / Send Tax Bills To:  
LaShawnda Conley  
3802 Martin Luther King Drive  
Gary, IN 46409

000865

IN WITNESS WHEREOF, The said first party has signed and sealed these presents the day and year first above written. Signed, sealed and delivered in presence of:

CK # 5194  
RTS 17-  
M.V.

Signature of Witness

Charles Conley  
Signature of First Party

Print name of Witness

Print name of First Party

Signature of Witness

Signature of First Party

Print name of Witness

Print name of First Party

State of Indiana

County of Lake

On Lake before me, the undersigned, appeared Charles Conley,  
personally known to me (or proved to me on the basis of satisfactory evidence) to be the person(s) whose name(s)  
is/are subscribed to the within instrument and acknowledged to me that he/she/they executed the same in  
his/her/their authorized capacity(ies), and that by his/her/their signature(s) on the instrument the person(s), or the  
entity upon behalf of which the person(s) acted, executed the instrument.  
WITNESS my hand and official seal.

[Signature]  
Signature of Notary  
(Seal)

Affiant Known Produced ID  
Type of ID Indiana Driver's

State of INDIANA

County of LAKE

On APRIL 13th, 2008 before me, the undersigned, appeared Charles Conley,  
personally known to me (or proved to me on the basis of satisfactory evidence) to be the person(s) whose name(s)  
is/are subscribed to the within instrument and acknowledged to me that he/she/they executed the same in  
his/her/their authorized capacity(ies), and that by his/her/their signature(s) on the instrument the person(s), or the  
entity upon behalf of which the person(s) acted, executed the instrument.  
WITNESS my hand and official seal.

[Signature]  
Signature of Notary  
(Seal)

Affiant Known Produced ID  
Type of ID

Signature of Preparer

Print Name of Preparer

Address of Preparer

