

2003 107536

RECORDED  
INDEXED  
MAY 10 2003  
LAKE COUNTY RECORDER'S OFFICE

WHEN RECORDED MAIL TO:  
Job#: 90799 Batch#: 5 13-089

After Recording Return To:  
PEELLE MANAGEMENT CORPORATION  
Assignment P.O. BOX 1710  
CAMPBELL, CA 95009-1710

LN#80101757300 MIN#:1002370-8010175730-5  
MERS# 1-888-679-6377

Order No.  
Escrow No.  
Application No.  
Loan No. 7124

SPACE ABOVE THIS LINE FOR RECORDER'S USE

### Corporation Assignment of Mortgage 13-089

FOR VALUE RECEIVED, BWM MORTGAGE, LLC

having its principal place of business at 10425 W NORTH AVE #246, WAUWATOSA, WISCONSIN 53226 ("Assignor"),

hereby grants, assigns and transfers to MORTGAGE ELECTRONIC REGISTRATION SYSTEMS, INC organized and existing under the laws of Delaware P.O. Box 2026, Flint, MI 48501-2026

all of Assignor's rights, title and interest in, to, and under that certain Mortgage dated MAY 3, 2002 ("Assignee")  
executed and delivered by ARTHUR E SAMANO

and recorded either \_\_\_\_\_, Mortgageor,

concurrently herewith; or  
 as Instrument No. 2002044161 on 5/10/02 in book \_\_\_\_\_, page \_\_\_\_\_,  
of Official Records in the County Recorder's office of LAKE \_\_\_\_\_ County,

covering certain real estate and other property described therein, more particularly described as follows:  
LOT 23 IN BLOCK 1 IN GREENMEADOW MANOR UNIT NO. 1, IN THE CITY OF CROWN POINT AS PER PLAT THEREOF, RECORDED IN PLAT BOOK 31, PAGE 51, IN THE OFFICE OF THE RECORDER OF LAKE COUNTY, INDIANA.

TOGETHER with the note or notes therein described or referred to therein and secured thereby, the money due and to become due thereon with interest, and all rights accrued or to accrue under said Mortgage.

IN WITNESS WHEREOF, Assignor has caused this Corporation Assignment of Mortgage to be executed by its duly authorized officer as of the day and year first written below.

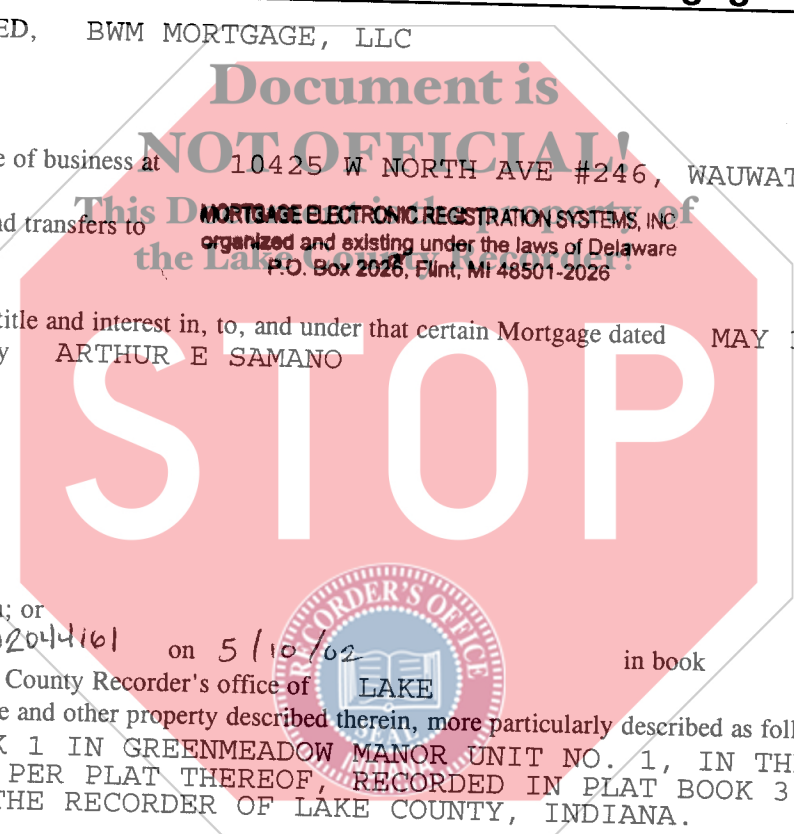

12.00  
LP

117/012



DATE MAY 3, 2002  
STATE OF WISCONSIN  
COUNTY OF MILWAUKEE

BWM MORTGAGE, LLC, A WISCONSIN  
CORPORATION

On MAY 8, 2002 before me,  
Cheryl L. Torres Notary Public,  
personally appeared JAMES W. LARSON,  
PRESIDENT

  
JAMES W. LARSON  
PRESIDENT

\_\_\_\_\_ personally known to me  
(or proved to me on the basis of satisfactory evidence) to be the person(s)  
whose name(s) is/are subscribed to the within instrument and acknowledged  
to me that he/she/they executed the same in his/her/their authorized  
capacity(ies), and that by his/her/their signature(s) on the instrument the  
person(s), or the entity upon behalf of which the person(s) acted, executed  
the instrument.

WITNESS my hand and official seal.

Signature Cheryl L. Torres  
Commission expires: 8/29/2004

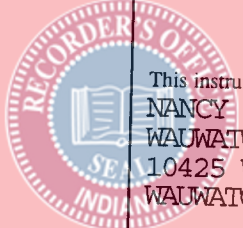
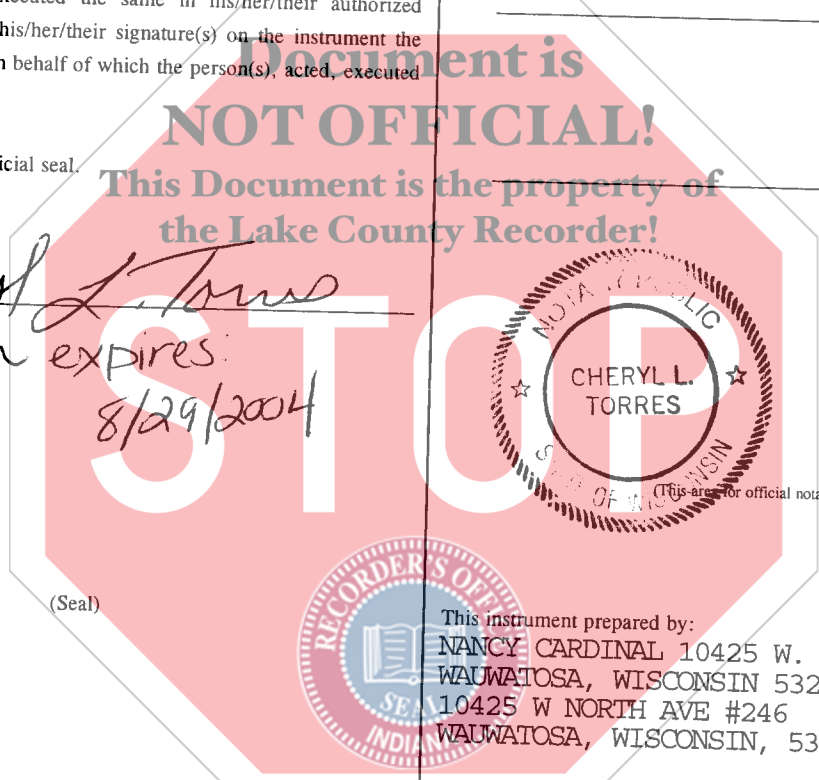

This instrument prepared by:  
NANCY CARDINAL 10425 W. NORTH AVE., #246  
WAUWATOSA, WISCONSIN 53226  
10425 W NORTH AVE #246  
WAUWATOSA, WISCONSIN, 53226

