

2003 106407

LF298-04

STATE OF INDIANA  
LAKE COUNTY  
FILED FOR RECORD

2003 OCT -6 AM 9:52

MORRIS W. CARTER  
RECORDER

### QUITCLAIM DEED

THIS QUITCLAIM DEED, executed this 2<sup>nd</sup> day of October, (year), 2003

by first party, Grantor, Chester Harding Jr. aka Chester Harding  
 whose post office address is 2904 W 20<sup>th</sup> Ave, Gory, In. 46404  
 to second party, Grantee, Cheryl L. Harding and Chester Harding Jr.  
 whose post office address is 2904 W. 20<sup>th</sup> Ave Gory, In. 46404 estate J/T R/S  
C.H. Jr.

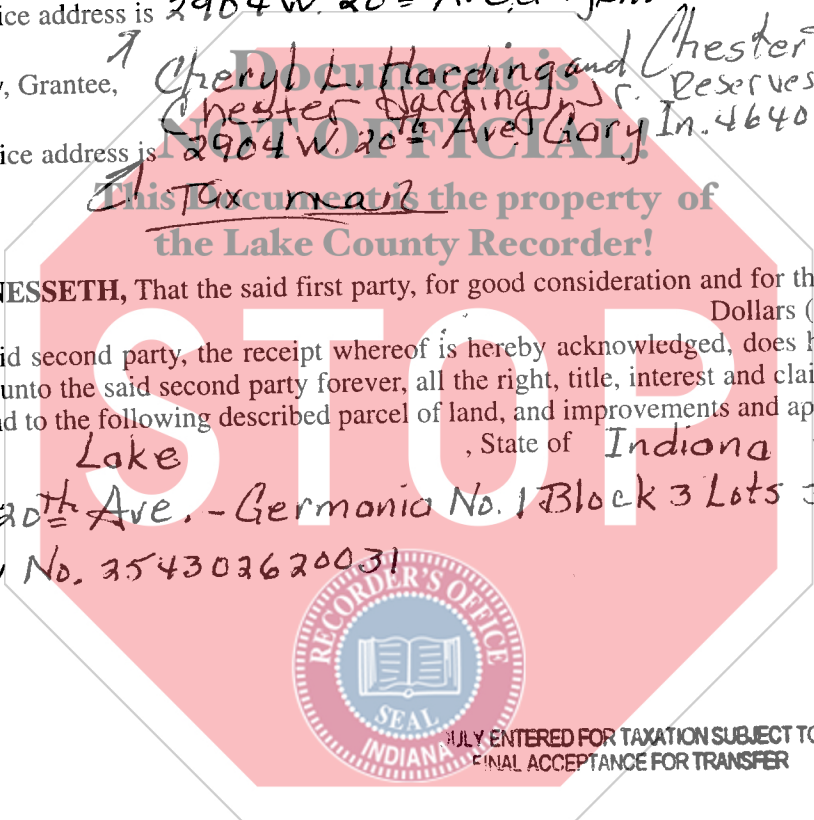

WITNESSETH, That the said first party, for good consideration and for the sum of Dollars (\$ a gift )  
 paid by the said second party, the receipt whereof is hereby acknowledged, does hereby remise, release  
 and quitclaim unto the said second party forever, all the right, title, interest and claim which the said first  
 party has in and to the following described parcel of land, and improvements and appurtenances thereto in  
 the County of Lake, State of Indiana to wit:  
2904 W. 20<sup>th</sup> Ave. - Germania No. 1 Block 3 Lots 31 to 34  
Property No. 354302620031

OCT 6 2003

STEPHEN R. STIGLICH  
LAKE COUNTY AUDITOR

000462

*Handwritten initials/signature*

IN WITNESS WHEREOF, The said first party has signed and sealed these presents the day and year first above written. Signed, sealed and delivered in presence of:

Valerie Levy  
Signature of Witness

Valerie Levy  
Print name of Witness

Carla J. Heflin  
Signature of Witness

Carla J. Heflin  
Print name of Witness

Chester Harding Jr.  
Signature of First Party

Chester Harding, Jr.  
Print name of First Party

\_\_\_\_\_  
Signature of First Party

\_\_\_\_\_  
Print name of First Party

State of \_\_\_\_\_  
County of Lake  
On \_\_\_\_\_ before me, Mildred Shannon  
appeared

personally known to me (or proved to me on the basis of satisfactory evidence) to be the person(s) whose name(s) is/are subscribed to the within instrument and acknowledged to me that he/she/they executed the same in his/her/their authorized capacity(ies), and that by his/her/their signature(s) on the instrument the person(s), or the entity upon behalf of which the person(s) acted, executed the instrument. WITNESS my hand and official seal.

Mildred Shannon  
Signature of Notary

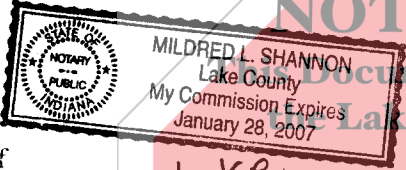

State of \_\_\_\_\_  
County of \_\_\_\_\_  
On \_\_\_\_\_  
appeared

Lake before me, Mildred Shannon

personally known to me (or proved to me on the basis of satisfactory evidence) to be the person(s) whose name(s) is/are subscribed to the within instrument and acknowledged to me that he/she/they executed the same in his/her/their authorized capacity(ies), and that by his/her/their signature(s) on the instrument the person(s), or the entity upon behalf of which the person(s) acted, executed the instrument. WITNESS my hand and official seal.

Mildred Shannon  
Signature of Notary

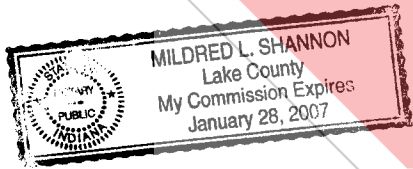

Affiant  Known  Produced ID  
Type of ID Drivers License  
(Seal)

Affiant  Known  Produced ID  
Type of ID Drivers License  
(Seal)

Chester Harding Jr.  
Signature of Preparer

Chester Harding Jr.  
Print Name of Preparer

2904 W. 20th Ave. Gary, In. 46404  
Address of Preparer