

CERTIFICATE OF ASSUMED BUSINESS NAME

For persons (sole proprietorships, associations, or general partnerships)
Engaged in business under a name other than their own (DBA)

STATE OF INDIANA, COUNTY LAKE
NAME OF BUSINESS EAT YOUR HEART OUT
NATURE OF BUSINESS RESTAURANT
ADDRESS OF BUSINESS 4280 W. 5TH AVENUE GARY, IN 46402

2003 106265

PRINTED NAMES AND RESIDENCES OF MEMBER OF BUSINESS:

→ CHARLIE ADDISON at 666 Fillmore St Gary, IN 46402
JOSIE ADDISON at 666 Fillmore St Gary, IN 46402

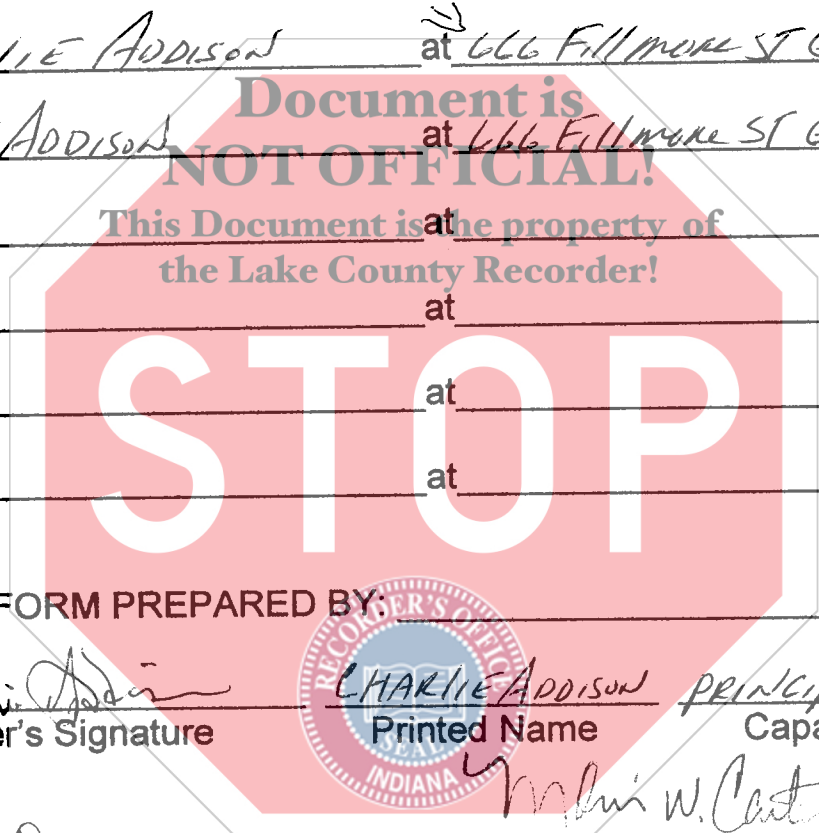

2003 OCT 1 4:10 PM
LAKE COUNTY RECORDER
OFFICE OF PUBLIC SAFETY
FILED IN REC-00000000

FORM PREPARED BY:

x [Signature] CHARLIE ADDISON PRINCIPAL OWNER
Member's Signature Printed Name Capacity

Filed on October 3, 2003, [Signature], Recorder

900
RM
CASH