

2

STATE OF INDIANA  
LAKE COUNTY  
FILED FOR RECORD

2003 106263

2003 OCT -3 PM 1:51

MORRIS W. CARTER  
RECORDER

A298-10  
R298-04

### QUITCLAIM DEED

THIS QUITCLAIM DEED, Executed this 17 day of July, 2000 (year),

by first party, Grantor, *Bertha Burt*

whose post office address is ~~4400 Burg Allen park~~ 3875 Delaware Gary, IN 46409 *R.S.*

to second party, Grantee, ~~Bertha Burt Rosemary Stenn~~ *Reserve life estate Rosemary Stenn*

whose post office address is ~~4400 Burg Allen park~~ 3875 Delaware Gary, IN 46409 *↑*

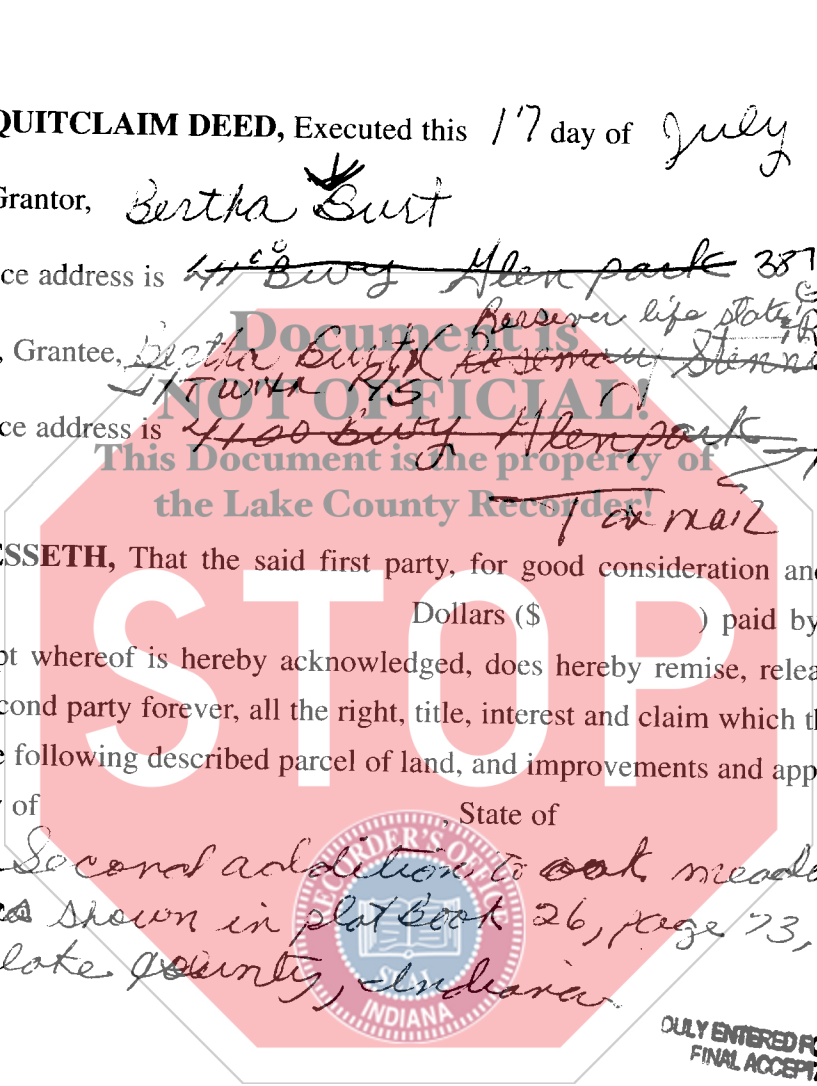

WITNESSETH, That the said first party, for good consideration and for the sum of Dollars (\$) paid by the said second party, the receipt whereof is hereby acknowledged, does hereby remise, release and quitclaim unto the said second party forever, all the right, title, interest and claim which the said first party has in and to the following described parcel of land, and improvements and appurtenances there- to in the County of \_\_\_\_\_, State of \_\_\_\_\_ to wit:

*lot 107, Second addition to oak meadow, Lake County Indiana, as shown in plat book 26, page 73, in the recorder's office of Lake County, Indiana.*

ONLY ENTERED FOR TAXATION SUBJECT TO FINAL ACCEPTANCE FOR TRANSFER

OCT 3 2003

STEPHEN R. STIGLICH  
LAKE COUNTY AUDITOR

*This is being re-recorded because deed was never brought to recorder's office and correcting grantee's name.*

Rev. 4/99

If your state requires 8 1/2" x 11" forms, cut off the bottom of this page at the dotted line.

000376



ONLY ENTERED FOR TAXATION SUBJECT TO FINAL ACCEPTANCE FOR TRANSFER

JUL 17 2000

PETER BENJAMIN  
LAKE COUNTY AUDITOR

936

*1600 cash DB*

IN WITNESS WHEREOF, The said first party has signed and sealed these presents the day and year first above written. Signed, sealed and delivered in presence of:

Signature of Witness

Print name of Witness

Signature of Witness

Print name of Witness

Bertha Burt  
Signature of First Party

Bertha Burt  
Print name of First Party

Rosemary Stennis  
Signature of First Party

ROSEMARY STENNIS  
Print name of First Party

State of \_\_\_\_\_ }  
County of \_\_\_\_\_  
On \_\_\_\_\_ before me,  
appeared

personally known to me (or proved to me on the basis of satisfactory evidence) to be the person(s) whose name(s) is/are subscribed to the within instrument and acknowledged to me that he/she/they executed the same in his/her/their authorized capacity(ies), and that by his/her/their signature(s) on the instrument the person(s), or the entity upon behalf of which the person(s) acted, executed the instrument.  
WITNESS my hand and official seal.

[Signature]  
Signature of Notary

Affiant \_\_\_\_\_ Known  Produced ID  
Type of ID In ID 0550021192  
I-DL 8924 779777(Seal)

State of INDIANA }  
County of LAKE  
On 7-13-00 before me,

appeared BERTHA BURT AND ROSEMARY STENNIS  
personally known to me (or proved to me on the basis of satisfactory evidence) to be the person(s) whose name(s) is/are subscribed to the within instrument and acknowledged to me that he/she/they executed the same in his/her/their authorized capacity(ies), and that by his/her/their signature(s) on the instrument the person(s), or the entity upon behalf of which the person(s) acted, executed the instrument.  
WITNESS my hand and official seal.

Signature of Notary

Affiant \_\_\_\_\_ Known \_\_\_\_\_ Produced ID  
Type of ID \_\_\_\_\_  
(Seal)



Signature of Preparer  
Print Name of Preparer  
Address of Preparer

(2)

If your state requires 8 1/2" x 11" forms, cut off the bottom of this page at the dotted line.