

2

STATE OF INDIANA
LAKE COUNTY
FILED FOR RECORD

2003 106236

2003 OCT -3 PM 12:41

MORRIS W. CARTER
RECORDER

WHEN RECORDED, MAIL TO:
AMERICA'S MORTGAGE BANC

AMERICA'S MORTGAGE BANC
1166 QUAIL COURT, SUITE 200
PEWAUKEE, WISCONSIN 53072

Order No.
Escrow No.
Application No.
Loan No. GARCIA

03000701

SPACE ABOVE THIS LINE FOR RECORDER'S USE

Corporation Assignment of Mortgage

FOR VALUE RECEIVED, AMERICA'S MORTGAGE BANC, KANSAS CORPORATION

having its principal place of business at 1166 QUAIL COURT, SUITE 200, PEWAUKEE, WISCONSIN, 53072

("Assignor"),

hereby grants, assigns and transfers to CITIFINANCIAL MORTGAGE COMPANY, INC., 8333 RIDGEPOINT DRIVE IRVING, TX 75063

("Assignee")

all of Assignor's rights, title and interest in, to, and under that certain Mortgage dated AUGUST 22, 2003 executed and delivered by CARLOS GARCIA AND RAMONA GARCIA HUSBAND & WIFE

and recorded either

concurrently herewith; or

as Instrument No. 2003-091991 on September 4, 2003 in book _____, page _____,

of Official Records in the County Recorder's office of LAKE County,

covering certain real estate and other property described therein, more particularly described as follows:

LOT 21 AND THE SOUTH HALF OF LOT 20, BLOCK 6, SUBDIVISION OF ORIGINAL BLOCKS 4, 5, 6, 7, 9 AND PRENTISS AVENUE, SUBDIVISION OF THE NORTH 70-48/100 ACRES OF THE SOUTHWEST QUARTER OF SECTION 29, TOWNSHIP 37 NORTH, RANGE 9 WEST OF THE 2ND P.M., IN THE CITY OF EAST CHICAGO, AS SHOWN IN PLAT BOOK 2, PAGE 70, IN LAKE COUNTY, INDIANA.
A.P.N. #: 24-30-0114-0023

TOGETHER with the note or notes therein described or referred to therein and secured thereby, the money due and to become due thereon with interest, and all rights accrued or to accrue under said Mortgage.

IN WITNESS WHEREOF, Assignor has caused this Corporation Assignment of Mortgage to be executed by its duly authorized officer as of the day and year first written below.

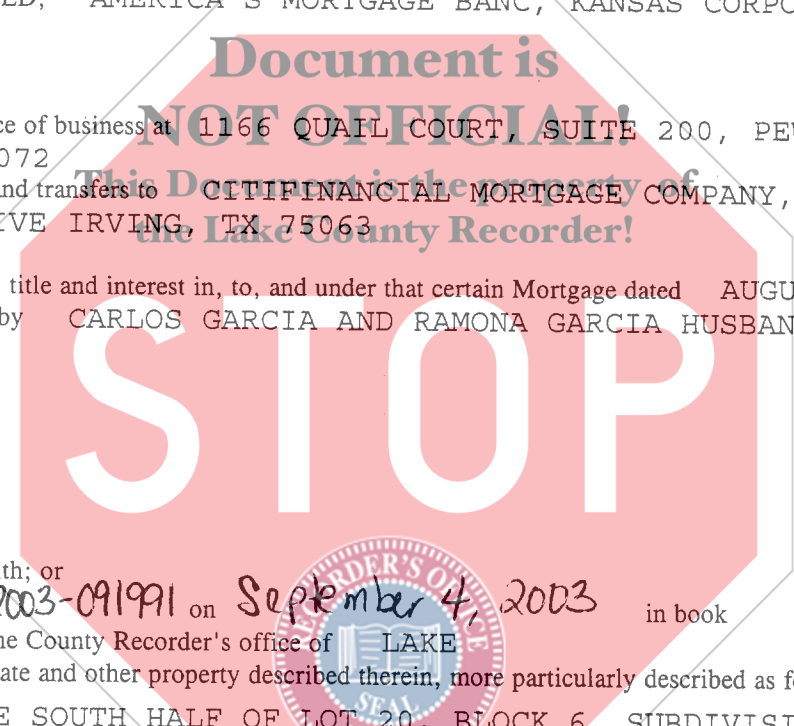

CK #5190
RTS
M ✓

DATE AUGUST 22, 2003
STATE OF KANSAS
COUNTY OF JOHNSON

On AUGUST 25, 2003 before
me, MELISSA GRAFF Notary Public, personally
appeared

CHRISTOPHER S. CONWAY,
PRESIDENT

personally known to me (or proved
to me on the basis of satisfactory evidence) to be the person(s)
whose name(s) is/are subscribed to the within instrument and
acknowledged to me that he/she/they executed the same in
his/her/their authorized capacity(ies), and that by his/her/their
signature(s) on the instrument the person(s), or the entity upon
behalf of which the person(s), acted, executed the instrument.

WITNESS my hand and official seal.

Signature Melissa Graff
MELISSA GRAFF, JOHNSON COUNTY

(Seal)

AMERICA'S MORTGAGE BANC
KANSAS CORPORATION

Christopher S. Conway
CHRISTOPHER S. CONWAY
PRESIDENT

MELISSA GRAFF
NOTARY PUBLIC
STATE OF KANSAS
COUNTY OF JOHNSON
MY COMM. EXPIRES 8/8/07

(This area for official notarial seal)

Document is
NOT OFFICIAL!

This Document is the property of
This instrument prepared by:
JULIE KORTH

