

2

STATE OF INDIANA
LAKE COUNTY
FILED FOR RECORD

2003 OCT -3 PM 12:41

MORRIS W. CARTER
RECORDER

2003 106234

WHEN RECORDED, MAIL TO:
AMERICA'S MORTGAGE BANC

AMERICA'S MORTGAGE BANC
1166 QUAIL COURT, SUITE 200
PEWAUKEE, WISCONSIN 53072

Order No.
Escrow No.
Application No.
Loan No. MORGAN

03000537

SPACE ABOVE THIS LINE FOR RECORDER'S USE

Corporation Assignment of Mortgage

FOR VALUE RECEIVED, AMERICA'S MORTGAGE BANC, KANSAS CORPORATION

having its principal place of business at 1166 QUAIL COURT, SUITE 200, PEWAUKEE, WISCONSIN, 53072 ("Assignor"),

hereby grants, assigns and transfers to: CITIFINANCIAL MORTGAGE COMPANY, INC., 8333 RIDGEPOINT DRIVE IRVING, TX 75063 ("Assignee")

all of Assignor's rights, title and interest in, to, and under that certain Mortgage dated JULY 18, 2003 executed and delivered by AUSTIN MORGAN JR. AND SHEILA A. MORGAN HUSBAND AND WIFE

and recorded either

concurrently herewith; or

as Instrument No. 2003-07884 on July 30, 2003

of Official Records in the County Recorder's office of LAKE County, Indiana, in book _____, page _____

covering certain real estate and other property described therein, more particularly described as follows:

LOTS 3 AND 4 AND THE NORTH 15 FEET OF LOT 5 IN BLOCK 13 IN AETNA SECURITIES COMPANY'S FIRST SUBDIVISION, IN THE CITY OF GARY, AS PER PLAT THEREOF, RECORDED IN PLAT BOOK 20 PAGE 20, IN THE OFFICE OF THE RECORDER OF LAKE COUNTY, INDIANA.
A.P.N. #: 25-41-0013-003; 25-41-0013-0004

TOGETHER with the note or notes therein described or referred to therein and secured thereby, the money due and to become due thereon with interest, and all rights accrued or to accrue under said Mortgage.

IN WITNESS WHEREOF, Assignor has caused this Corporation Assignment of Mortgage to be executed by its duly authorized officer as of the day and year first written below.

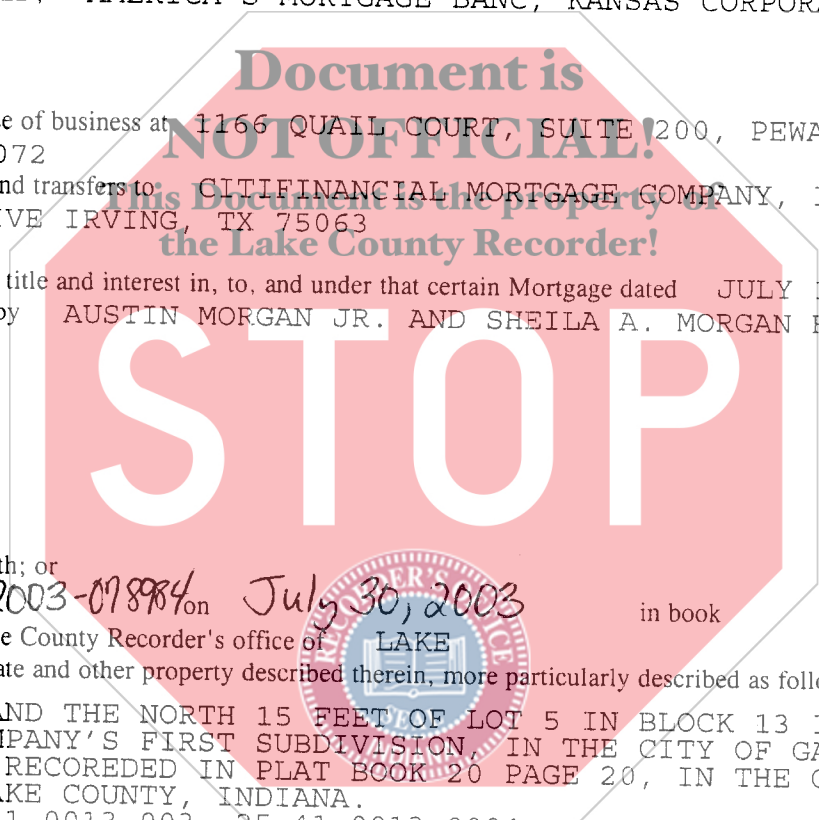

CK #5190
RTB 12-
MV

DATE JULY 18, 2003
STATE OF KANSAS
COUNTY OF JOHNSON

On JULY 18, 2003 before
me KRISTIN LEE HODGES Notary Public, personally
appeared _____

CHRISTOPHER S. CONWAY,
PRESIDENT

_____ personally known to me (or proved
to me on the basis of satisfactory evidence) to be the person(s)
whose name(s) is/are subscribed to the within instrument and
acknowledged to me that he/she/they executed the same in
his/her/their authorized capacity(ies), and that by his/her/their
signature(s) on the instrument the person(s), or the entity upon
behalf of which the person(s), acted, executed the instrument.

WITNESS my hand and official seal.

Signature Kristin Lee Hodges
KRISTIN LEE HODGES, JOHNSON COUNTY
Notary Public-Notary Seal
State of Kansas
County of Johnson
(Seal)

My Commission Expires 3/25/2007

AMERICA'S MORTGAGE BANC,
KANSAS CORPORATION

Christopher S. Conway
CHRISTOPHER S. CONWAY
PRESIDENT

(This area for official notarial seal)

Document is
NOT OFFICIAL!
This instrument is the property of
the Lake County Recorder!

