

2

2003 105666

2003-09-11 11:03

Prepared By: Sean Thornton  
Central Illinois Bank  
1801 E. Empire Suite 2  
Bloomington, IL 601704  
(309) 662-6693

Return To: Mortgage Services, Inc.  
A Division of  
Central Illinois Bank  
1801 E. Empire Suite 2  
Bloomington, IL 61704

### Assignment of Security Instrument

Loan Number: 05-65-91332  
MIN: 10015490000021769

MERS Phone: 1-888-679-6377

FOR VALUE RECEIVED, Central Illinois Bank, its successors and assigns, hereby assigns and transfers to Mortgage Electronic Registration Systems, Inc., its successors and assigns, as nominee for Washington Mutual Bank, FA, its successors and assigns, P.O. Box 2026, Flint, Michigan 48501-2026, all its right, title and interest in and to a certain mortgage executed by WES M TILLER and KAREN M TILLER, husband and wife as joint tenants, to Central Illinois Bank, and bearing the date of the 29th day of August A.D. 2002 and recorded on the 5th day of Sept. A.D. 2002 in the office of the Recorder of Lake County, State of Indiana in Book - at Pages -. Doc 2002-079199

Legal Description: LOT 50 IN UNIT 1 IN TIBURON SUBDIVISION, AS PER PLAT THEREOF, RECORDED IN PLAT BOOK 89 PAGE 89, IN THE OFFICE OF THE RECORDER OF LAKE COUNTY, INDIANA.  
PIN: 11-329-50  
C/K/A: 9204 Bryan Ln, Crown Pt, Indiana 46307

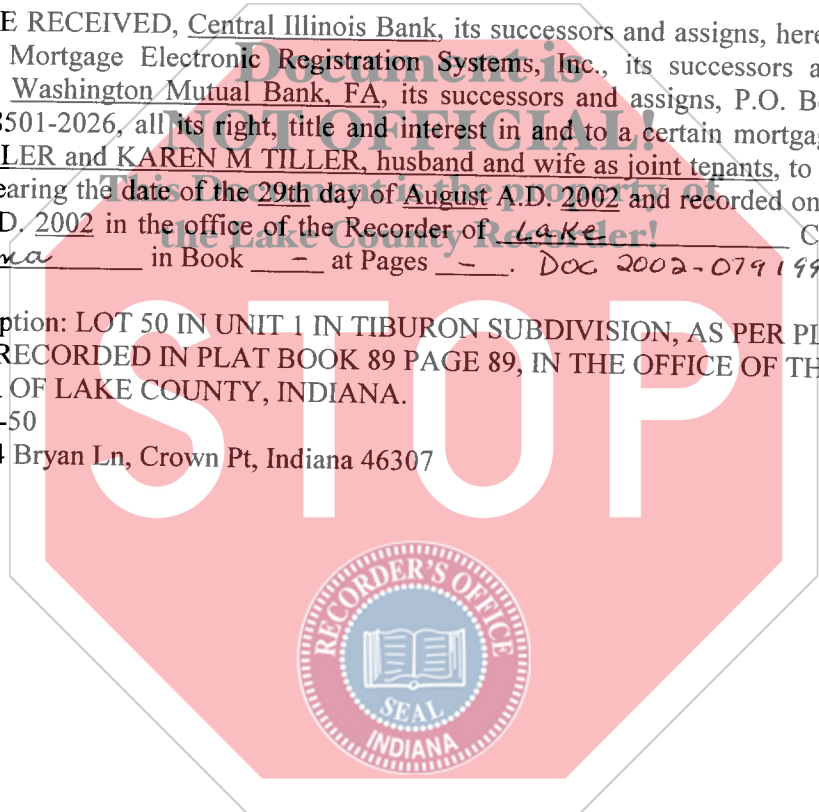

12.00  
LP  
9054  
812.00

Signed on the 29th day of Aug A.D. 2002

Central Illinois Bank (Assignor)  
By *Nanetta Hines*  
Nanetta Hines, Presidential Designee

State of Illinois                    }  
County of McLean                } ss:

On the 29th day of Aug A.D. 2002, before me, a Notary Public, personally appeared Nanetta Hines, to me known, who being duly sworn, did say that he or she is Presidential Designee of Central Illinois Bank, and that said instrument was signed on behalf of said corporation.

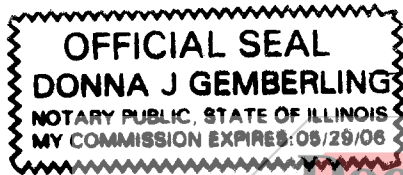

*Donna J Gemberling*  
Notary Public

Intervening Assignment: This assignment is not subject to the requirements of section 275 of the real property law because it is an assignment in the secondary mortgage market.

